



SAXON SHORE
— ESTATE AGENTS —



Hansletts Bungalow Hansletts Lane, Faversham, Kent ME13 0RN £650,000

Hansletts Bungalow is located in a stunning rural setting a mile from the ancient village of Ospringe and under three miles from Faversham. This is an exceptionally well maintained three bedroom bungalow set within approx 0.5 acre of grounds with parts of the original timber framed building believed to date back to the 19th Century.

The accommodation comprises of a light entrance hall, sitting room and dining room which are divided by a double sided wood burning stove. The gorgeous kitchen which is also open from the dining area benefits from a range of wall and base units with wooden work surfaces and a Belfast style sink inset there is also a lovely travertine floor with underfloor heating. There are three well proportioned bedrooms one of which benefits from an en suite and also a separate bathroom. From the dining room you can also access a useful basement room. Lastly inside there is a pantry and several cupboards for storage. This is a property that has been loved and improved by the current owners which is abundantly clear on internal inspection.

Outside things get even more interesting. The property is set in its own gardens, laid mainly to lawn with additional land to the rear forming a small paddock, the plot comprising

Hallway



Sitting Room

12'5" x 11'10" (3.81 x 3.61)



Dining Room

12'5" x 9'6" (3.81 x 2.92)



Kitchen

11'8" x 10'0" (3.56 x 3.05)



Basement Room

10'11" x 10'2" (3.33 x 3.10)

Bedroom 1

10'11" x 9'8" (3.35 x 2.95)



Ensuite



Bedroom 2

10'11" x 10'11" (3.33 x 3.33)



Bedroom 3

11'10" x 11'10" (3.63 x 3.61)



Bathroom



Garden

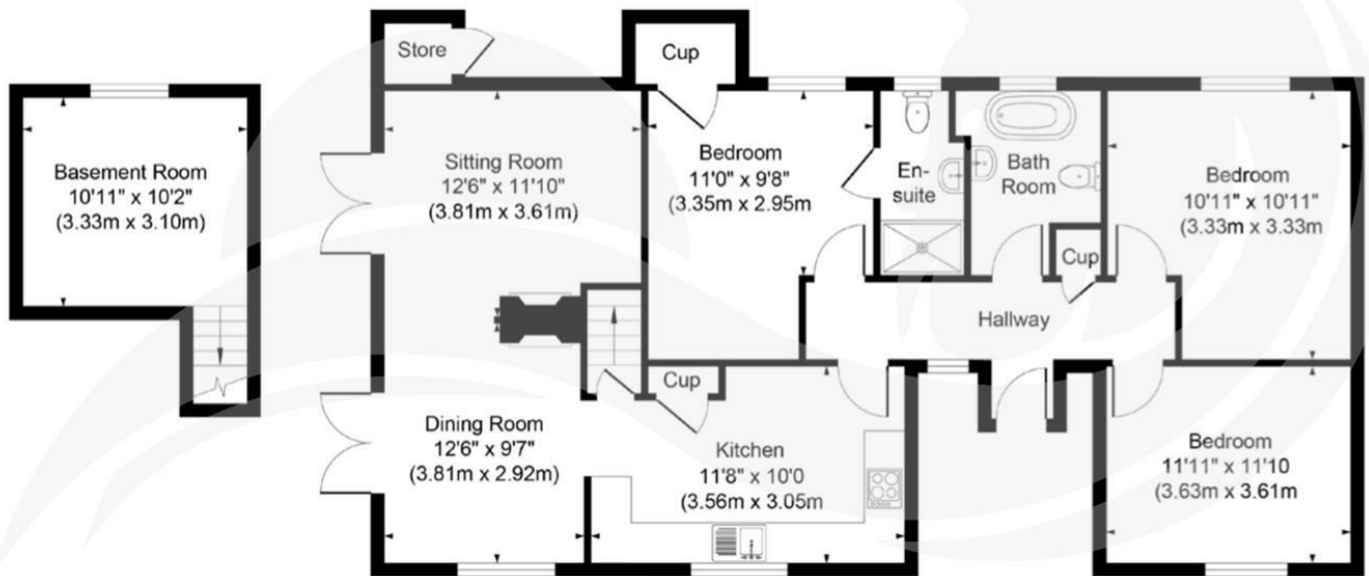

Basement

Ground Floor

