



**2 Rutland Mews, St John's Wood  
London NW8 0RF  
Asking price £1,050,000 Freehold**



**A well-presented 3 bedroom house (approx. 993 sq ft / 92 sq m) located in this gated cobbled mews adjacent to Abbey Road. Arranged over 3 floors, the house benefits from a 19' reception room with access to a balcony, a newly fitted kitchen and a 19' master bedroom suite. Rutland Mews is located with 3/4 mile of St John's Wood High Street with its shopping and transport facilities whilst the open spaces of Primrose Hill and Regents Park are also within a short distance.**



## Rutland Mews, NW8

Gross internal area (approx.)  
 92 Sq m (993 Sq ft) Including Under 1.5m  
 89 Sq m (956 Sq ft) Excluding Under 1.5m

For identification only. Not to Scale



Floor Plan by **capital group** 020 8671 7722



Second Floor

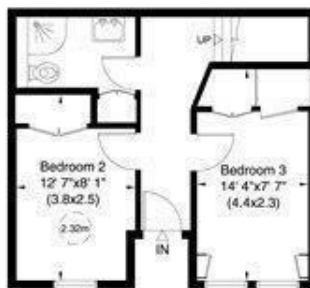

Ground Floor



First Floor

Not to scale, for guidance only and must not be relied upon as a statement of fact. All measurements and areas are approximate only (and have been prepared in accordance with the current edition of the RICS Code of Measuring Practice).

Energy Efficiency Rating		Current	Potential
Very energy efficient - lower running costs			
(92 plus) <b>A</b>			
(81-91) <b>B</b>			
(69-80) <b>C</b>			
(55-68) <b>D</b>			
(39-54) <b>E</b>			
(21-38) <b>F</b>			
(1-20) <b>G</b>			
Not energy efficient - higher running costs			
<b>England &amp; Wales</b>		EU Directive 2002/91/EC	
Environmental Impact (CO <sub>2</sub> ) Rating		Current	Potential
Very environmentally friendly - lower CO <sub>2</sub> emissions			
(92 plus) <b>A</b>			
(81-91) <b>B</b>			
(69-80) <b>C</b>			
(55-68) <b>D</b>			
(39-54) <b>E</b>			
(21-38) <b>F</b>			
(1-20) <b>G</b>			
Not environmentally friendly - higher CO <sub>2</sub> emissions			
<b>England &amp; Wales</b>		EU Directive 2002/91/EC	

MISREPRESENTATION ACT 1967 Ian Green Residential for themselves and for the vendors and lessors of the above property(ies), whose agents they are, give notice that:- (1) These particulars are intended only as a guide to prospective purchasers or lessors to enable them to decide whether to make further enquiries with a view to taking up negotiations. They do not constitute, nor constitute any part of an offer or contract. (2) All statements contained on these particulars as to this (these) property (ies) are made without responsibility on the part of Ian Green Residential or the vendors or the lessors. (3) None of the statements contained in these particulars as to this (these) property (ies) are to be relied upon as statements or representations of fact, nor should they be relied upon for any purpose whatever. Accordingly, neither their accuracy nor the continued availability of the property (ies) is in any way guaranteed and they are furnished on the express understanding that neither Ian Green Residential nor the vendor or lessor are to be or become under any liability or claim in respect of their contents. (4) The vendor or lessor does not hereby make or give nor do Ian Green Residential have any authority to make or give any representation or warranty whatsoever as regards to the property (ies) or otherwise. (5) Any intended purchaser or tenants must satisfy themselves by inspection or otherwise as to the correctness or each of the statements contained in these particulars. (6) In the event of the agents supplying any further information or expressing any opinion to a prospective purchaser or lessor whether oral or in writing such information or expression of opinion must be treated as given on the same basis as these particulars.

28 De Walden House, Allitsen Road, London, NW8 7BA

Tel: +44 (0)207 586 1000

ian@iangreenresidential.com

www.iangreenresidential.com



