



Mudstone Lane, Brixham, TQ5 9EJ



Mudstone Lane, Brixham, TQ5 9EJ

Brand New Luxury Holiday Lodges in Sought After Berry Head

- Open Plan Lounge/Diner/Kitchens with Built-in Appliances
- 2-3 Bedrooms, Master with En Suite Facilities
- Family Bathrooms
- Large Balcony with Sea Views*
- Allocated Parking
- Gas Central Heating
- uPVC Double Glazing
- 11.5 Months Holiday Use
- Fully Furnished
- Available Immediately
- FREE PITCH FEES FOR 2019



Prices From £157,000 & Free Pitch Fees for 2019!

Located in the Picturesque Berry Head area of Brixham with Stunning Views over St. Marys Bay is Riviera Bay Holiday Park. Available to buy for use 11.5 months a year are these stunning Luxury Holiday Lodges with 2-3 Bedrooms, stylish open plan living accommodation including a fully fitted kitchen with integrated appliances. The lodges are also available fully furnished and are purchased ready to use.



Riviera Bay itself is in the sought-after Berry Head area close to stunning Berry Head Country Park with its Napoleonic Forts and picturesque sea views. Brixham Town Centre is approximately 1 mile distant with its array of amenities & facilities as well as the bustling Brixham Harbour surrounded by a range of boutique shops, bars and restaurants.

Details about site/pitch fees as well as any current offers are available on request from the agents Absolute Sales & Lettings.

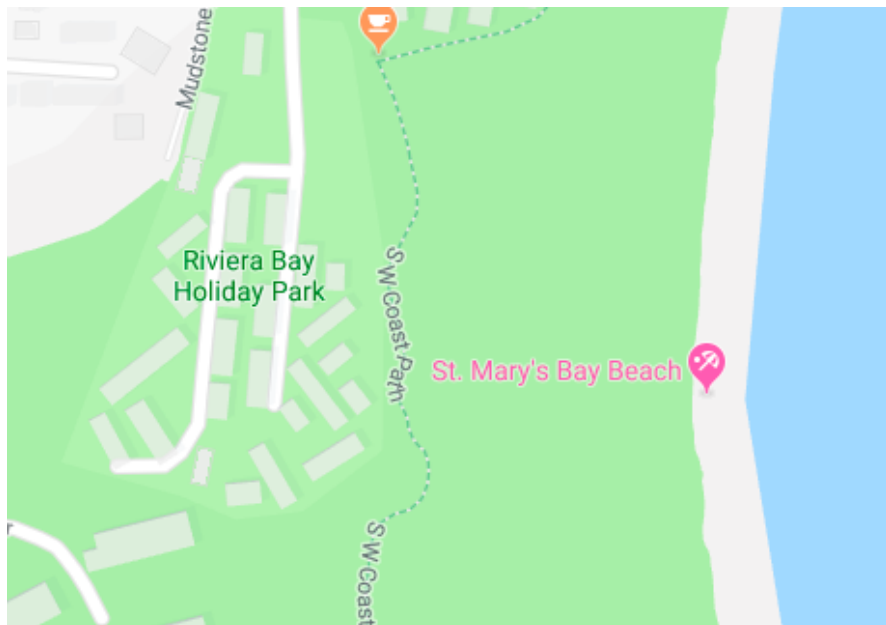

Please do not hesitate to contact the team at Absolute Sales & Lettings on [01803 890118](tel:01803890118) for more information or to arrange an accompanied viewing on this property.

Ground Floor
Approx. 72.1 sq. metres (776.5 sq. feet)



Total area: approx. 72.1 sq. metres (776.5 sq. feet)

Ground Floor
Approx. 72.1 sq. metres (776.5 sq. feet)

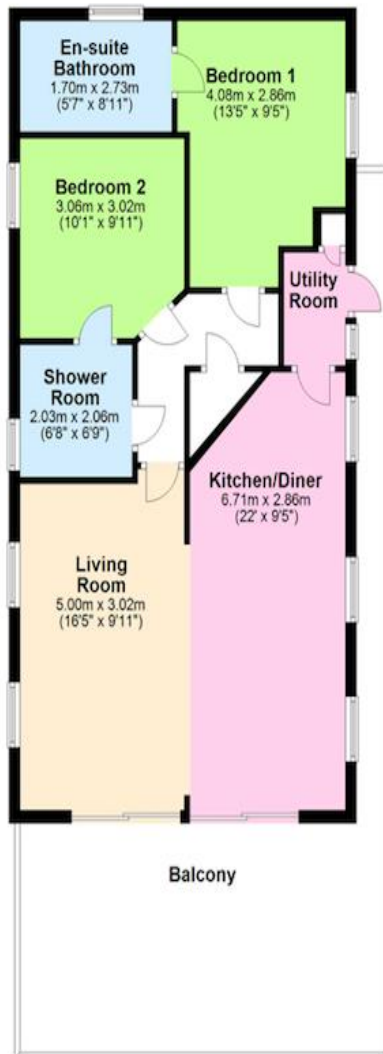

Total area: approx. 72.1 sq. metres (776.5 sq. feet)

Ground Floor
Approx. 67.5 sq. metres (726.7 sq. feet)



Have a property to sell or let?

If you are considering selling or letting your home please contact Absolute Sales & Lettings the top-rated agent in Torbay on



Consumer Protection Regulations: We have not tested any apparatus, equipment, fixtures and fittings or services and so cannot verify that they are in working order or fit for the purpose. References to the Tenure of a Property are based on information supplied by the seller. We have not had sight of the Title Documents. A buyer is advised to obtain verification from their solicitor or surveyor. Floorplans shown are for guidance only and should not be relied upon. Items shown in photographs are NOT included unless specifically mentioned within these details. They may however be able by separate negotiation. You are advised to check the availability of this property before travelling any distance to view. Particulars are produced in good faith to the best of our knowledge and are set out as a general guide only.