



**20 Beverley Rise, Brixham – TQ5 9NQ**

Guide Price **£380,000**







## 20 Beverley Rise

Brixham,

Delightful family home with 3 bedrooms and an office space, large lounge/diner, fully fitted country kitchen, large sunny garden, detached garage, parking for 3 cars. Ideal for outdoor activities, located near Brixham town centre, schools, and bus routes. Offered with no onward chain.

Council Tax band: C

Tenure: Freehold

- Large corner plot
- Three double bedrooms and a fourth bedroom/office
- Large sunny garden
- Detached garage
- Driveway parking for three cars
- Large lounge/diner
- Fully fitted country kitchen
- Ideal family home
- Close to Brixham town centre, bus routes and schools
- Internal viewing highly recommended!





## 20 Beverley Rise

Brixham,

The property is located in a tucked away location approximately 2/3 of a mile from Brixham town centre which is a near level walk which boasts an array of shops, amenities and facilities as well as the picturesque Brixham harbour surrounded by range of boutique shops, bars and restaurants. The main 12 bus service can be found at the end of the road with connections to the neighbouring towns of Paignton and Torquay as well as back into Brixham. Churstons 18-hole golf course is just 1 1/2 miles distance and the property has easy access in and out of Brixham.

### Absolute Sales & Lettings

Absolute Sales & Lettings, 36 Fore Street - TQ5 8DZ

01803 214214

[brixham@movewithabsolute.co.uk](mailto:brixham@movewithabsolute.co.uk)

[movewithabsolute.co.uk/](http://movewithabsolute.co.uk/)



### Ground Floor

Approx. 116.8 sq. metres (1256.9 sq. feet)

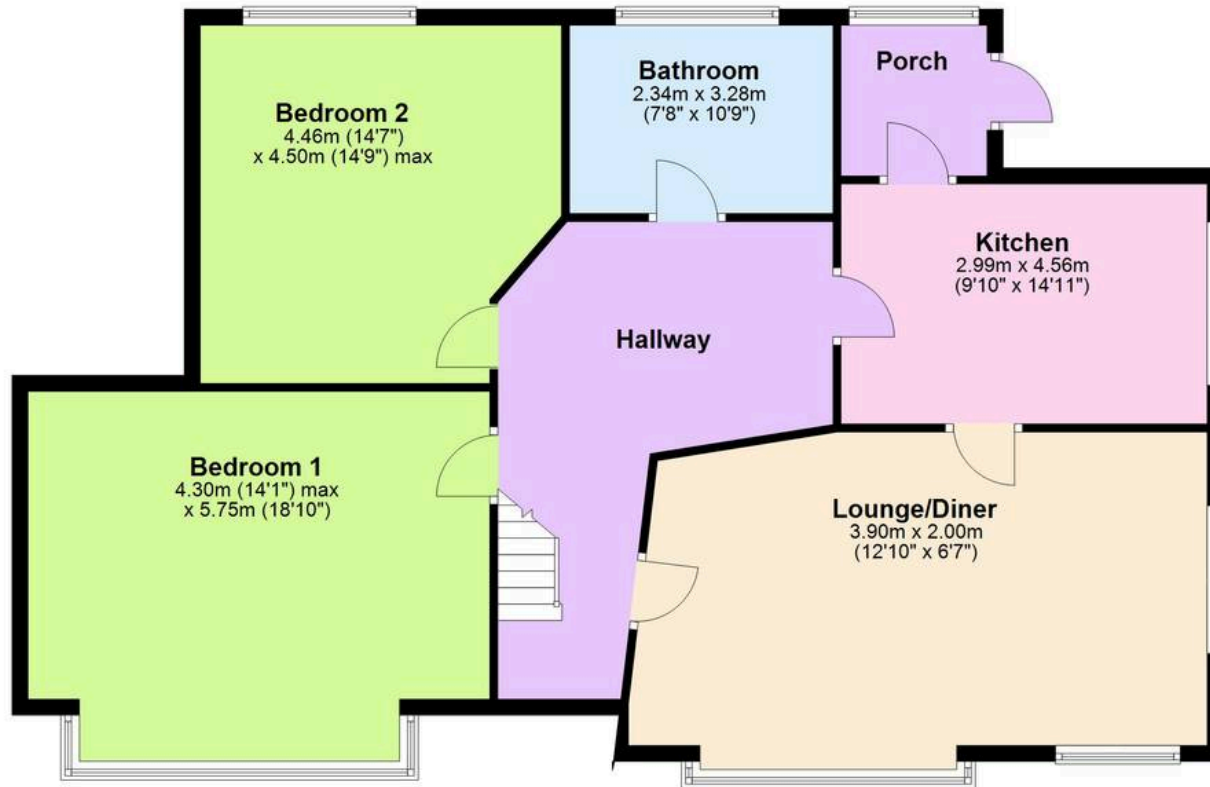

### First Floor

Approx. 29.9 sq. metres (322.3 sq. feet)

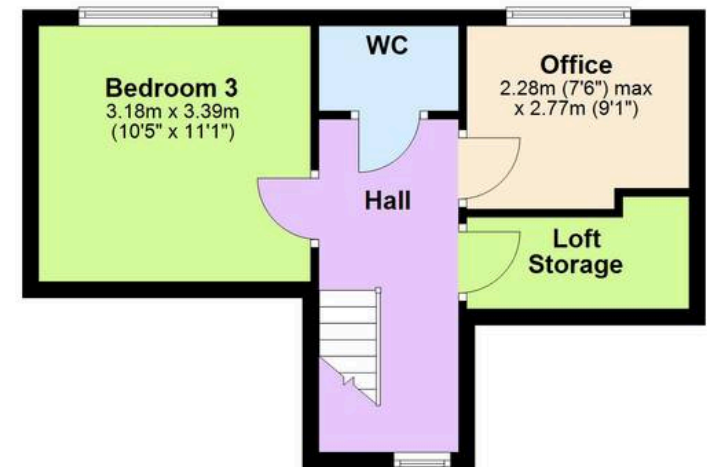

Total area: approx. 146.7 sq. metres (1579.2 sq. feet)