



**7 Bolton Court Windmill Hill, Brixham**

Brixham

Guide Price **£149,900**

ABSOLUTE



## 7 Bolton Court Windmill Hill

Brixham, Brixham

Modern 2-bed apartment in prime location. Open plan living, well-appointed kitchen, plush carpets in bedrooms. Allocated parking, electric heating, convenient transport links. Ideal for buyers or investors with long Leasehold and right to manage. Council Tax band: A

Tenure: Leasehold

- 2 Bedroom apartment
- Open plan living area
- Allocated parking
- Electric central heating
- Local bus route and transport links nearby
- Close to local shops and schools
- 999 year Leasehold from 2018
- Right to manage





## Ground Floor

Approx. 42.6 sq. metres (458.5 sq. feet)

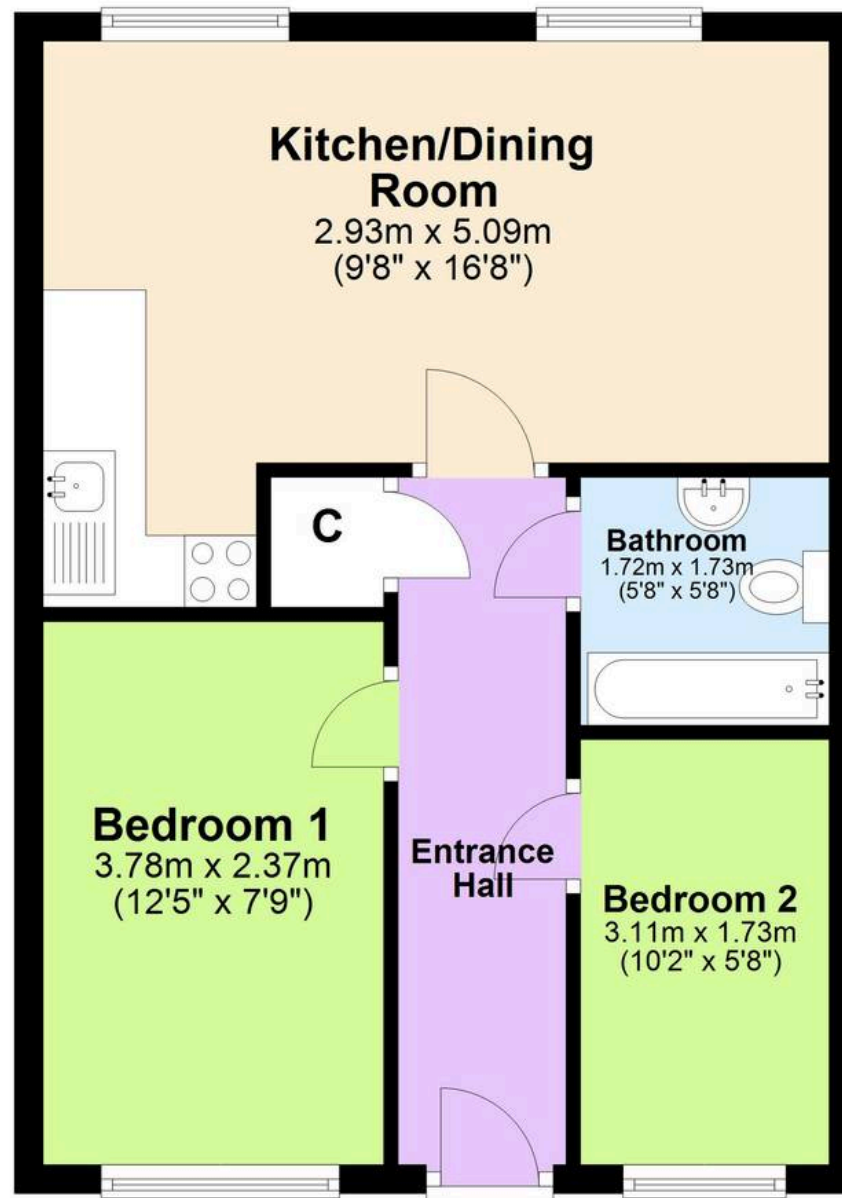

Total area: approx. 42.6 sq. metres (458.5 sq. feet)