



**Bramble Lodge Burton Place, Brixham – TQ5 9JD**  
**£599,950**





## Bramble Lodge, Burton Place

Brixham

Exquisite 4-bed chalet bungalow in sought-after area. Impressively spacious and light-filled. Dual aspect living room, modern kitchen, conservatory, en suites in 2 bedrooms. Secluded gardens, driveway, double garage. Ideal for luxurious living and outdoor entertaining in serene surroundings.

Tenure: Freehold

EPC Energy Efficiency Rating: D

- Individual & secluded detached home presented in superb order
- Dual aspect living room
- Separate dining room
- Quality modern fitted kitchen/breakfast room
- Four bedrooms (two with en suite bathrooms)
- Separate family shower room
- Conservatory
- Ample driveway parking
- Double garage
- Stunning secluded gardens with a sunny aspect



# Bramble Lodge, Burton Place

## Brixham

The property is situated in quiet private cul-de-sac located a little over half a mile from Brixham's town centre and bustling harbour side which surrounded by a range of boutique shops, bars and restaurants. There is access here onto the stunning South West Coast Path with its picturesque views. Further shops, amenities and facilities can be found in the town centre. The main 12 bus service with connections to the neighbouring towns of Paignton & Torquay can also be found here. Both primary and secondary schooling can be found a quarter of a mile distant. The sought after village of Churston with its 18 hole golf course and grammar school is just 2 miles distant.

## Absolute Sales & Lettings

Absolute Sales & Lettings, 36 Fore Street - TQ5 8DZ

01803 214214

[brixham@movewithabsolute.co.uk](mailto:brixham@movewithabsolute.co.uk)

[movewithabsolute.co.uk/](http://movewithabsolute.co.uk/)



### Ground Floor

Approx. 129.3 sq. metres (1392.2 sq. feet)



### First Floor

Approx. 53.6 sq. metres (576.7 sq. feet)

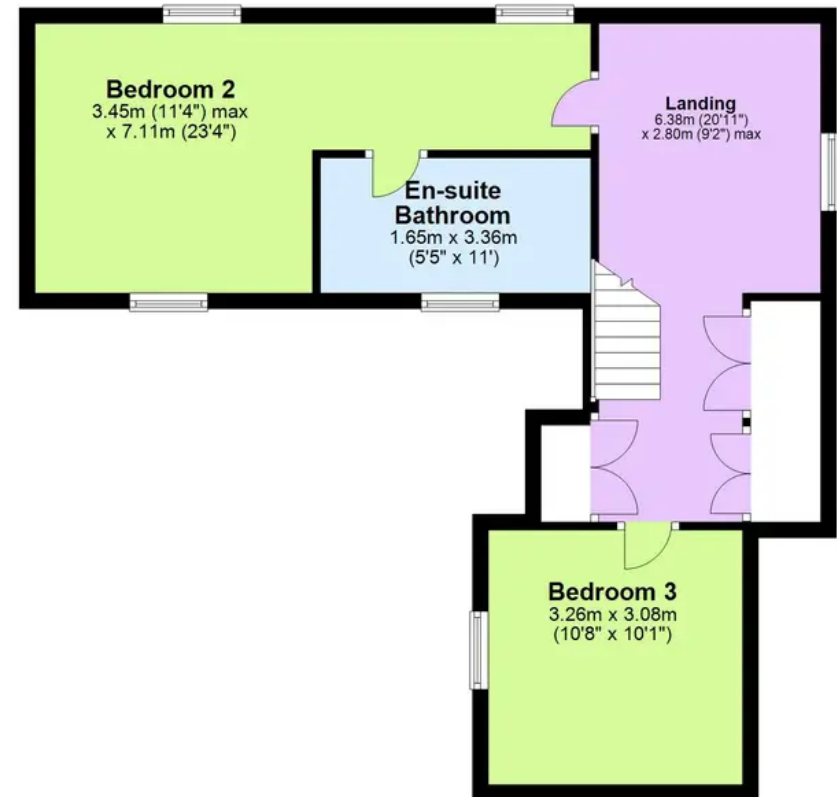

Total area: approx. 182.9 sq. metres (1969.0 sq. feet)

Approx  
Plan produced using PlanUp.

