



The Quay, Brixham – TQ5 8AW

£295,000





The Quay

Brixham

Introducing a stunning newly refurbished harbour side apartment boasting unobstructed frontline views of the picturesque Brixham harbour. Upon entering this delightful residence, you are greeted by a spacious lounge/diner flooded with natural light.

The property features a generously sized double bedroom, providing a tranquil sanctuary to unwind after a long day. The fitted kitchen and utility room have been thoughtfully designed with a focus on functionality, offering an abundance of storage and modern appliances necessary for contemporary living. The shower room offers a contemporary aesthetic, complete with sleek fittings and a refreshing ambience, enhancing the overall sense of luxury within the apartment.

One of the standout features of this residence is the internal courtyard, perfectly positioned to create an oasis of calm and privacy. Imaginatively landscaped, the courtyard provides an additional outdoor retreat, ideal for unwinding or enjoying a morning coffee.

Tenure: Leasehold



The Quay

Brixham

The property benefits from frontline, intimate harbour views totally uninterrupted with a range of Brixham's boutique shops, bars and restaurants on your doorstep. The town centre is just 200-300 yards level walk where you can find the local bus service connecting to the neighbouring towns of Paignton and Torquay. The harbourside also gives you access directly onto the stunning South West coast path with picturesque landscapes.

- A newly refurbished harbourside apartment
- Frontline harbour views
- Lounge/diner
- Double bedroom
- Fitted kitchen and utility room
- Shower room
- Internal courtyard
- Vacant possession
- Ideal lock up and leave or home

Absolute Sales & Lettings

Absolute Sales & Lettings, 36 Fore Street - TQ5 8DZ

01803 214214

brixham@movewithabsolute.co.uk

movewithabsolute.co.uk/



First Floor

Approx. 41.4 sq. metres (445.6 sq. feet)

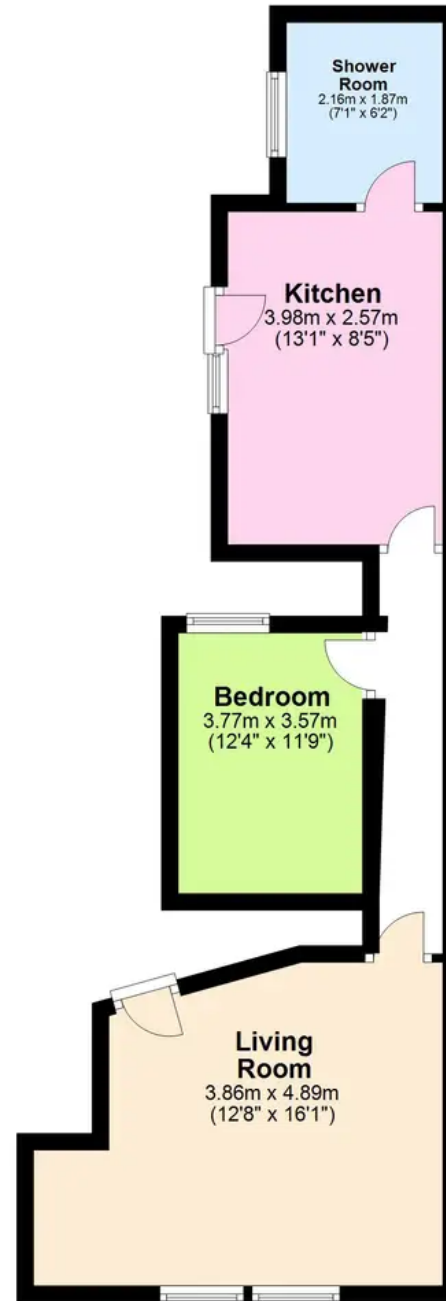

Total area: approx. 41.4 sq. metres (445.6 sq. feet)

Approx
Plan produced using PlanUp.

