



Rolph House , High Street, Thorpe-le-soken, Clacton-on-Sea, Essex, CO16 0DY

Guide Price £450,000 to £ 475,000

A unique opportunity has arisen to own a three bedroom Victorian period property in the idyllic location of Thorpe-Le-Soken situated in the heart of the village with fantastic access to local amenities and train station.



THE PROPERTY

A beautiful three bedroom Victorian period property has recently come to the market in the idyllic location of Thorpe-Le-Soken, set in the high street the property offers a family home with the benefit of local amenities and train station within walking distance.

The property provides an enclosed courtyard garden to the rear and side of the property with the addition of a fully enclosed front garden too. A solid wooden arched door greets you at the front of the property which opens in to the entrance hallway, the downstairs has plenty of living space with a separate dining room featuring a fireplace, lounge with beautiful bay window, a good sized kitchen and separate utility room, study and bathroom.

The upstairs of the property features three bedrooms and a family bathroom suite recently updated in 2018.





LOCATION

Rolph House is in the village of Thorpe-le-Soken within the Tendring District of Essex and is located to the east of Colchester as well as being a short distance from the coastal towns of Frinton-on-Sea and Walton-on-the-Naze. The village offers a Tesco Express offering goods for day to day needs, three public houses, wine bar, restaurant, Chinese restaurant and takeaway, dispensing chemist, doctors surgery, popular Church of England primary school and Tendring Technology College and TLG Secondary School, both of which have extremely good OFSTED reports. There are also very good nursery schools in and near Thorpe-le-Soken (Margery's private day nursery being the one of them). Another further attraction is the transport available locally to the grammar and private schools in Colchester and Ipswich.







Rolph House, Kirby-le-Soken, Colchester, Essex

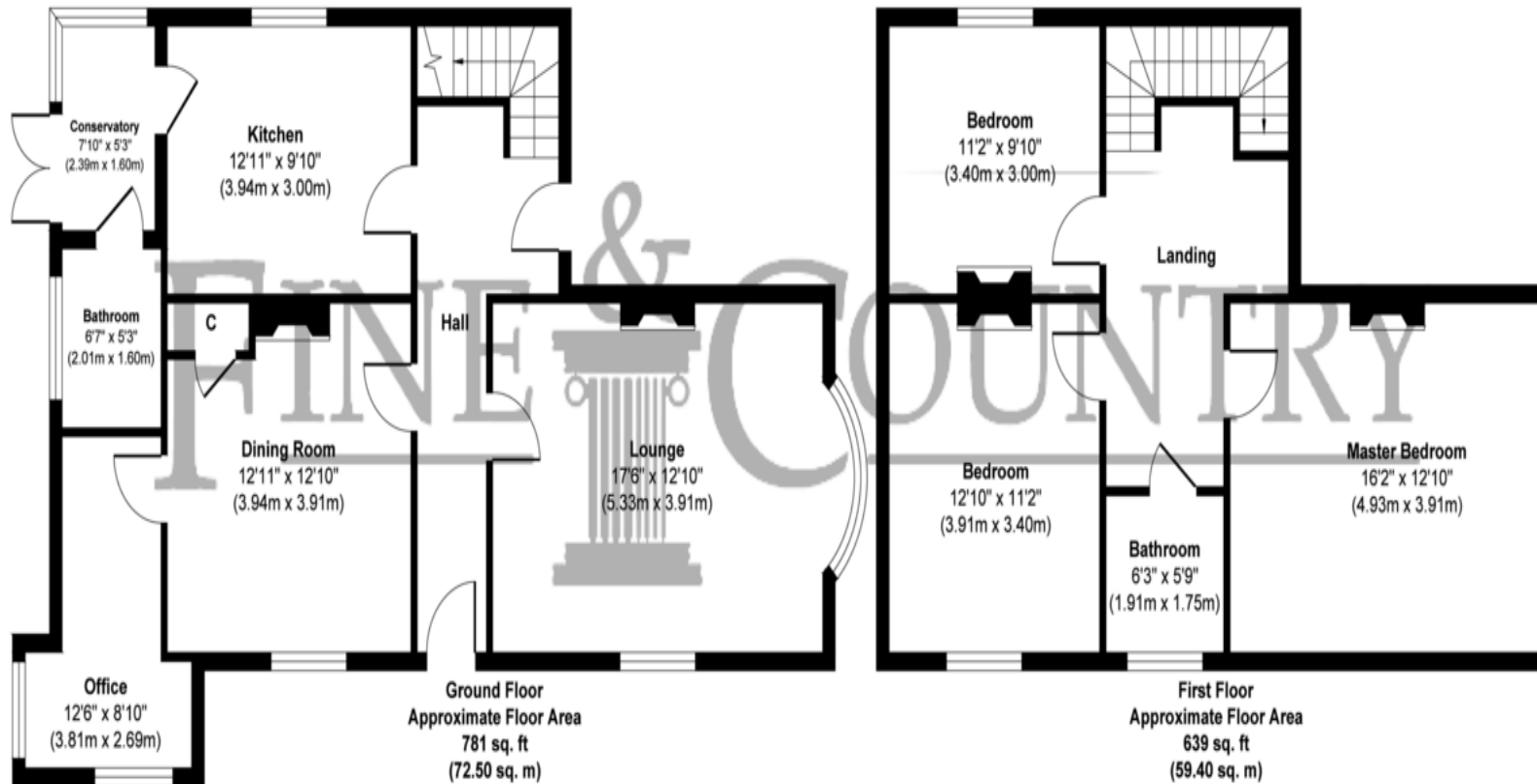

Approx. Gross Internal Floor Area 1420 sq. ft / 131.90 sq. m

Illustration for identification purposes only, measurements are approximate, not to scale.

Produced by Elements Property

60 Caelum Drive, Colchester,
Essex, CO2 8FP

www.fineandcountry.com
01206 878155
colchester@fineandcountry.com
m

Agents Note: Whilst every care has been taken to prepare these particulars, they are for guidance purposes only. All measurements are approximate are for general guidance purposes only and whilst every care has been taken to ensure their accuracy, they should not be relied upon and potential buyers/tenants are advised to recheck the measurements