

TO LET



Westbury, Wiltshire

2 Bedrooms, 1 Bathroom, Terraced

£825 pcm

MARTIN&CO



Westbury, Wiltshire

Terraced,
2 bedroom, 1 bathroom

£825 pcm

Date available: 22nd April
2024

Deposit: £950

Holding Deposit: £190

Unfurnished

Council Tax band: B

- A well presented two bedroom terraced house
- Lovely cul-de-sac location overlooking green open space
- Fitted kitchen and living room with doors out onto the garden
- Recently redecorated
- Refurbished bathroom
- Gas central heating and double glazing
- Enclosed rear garden

A well presented two bedroom house, situated in a lovely quiet cul-de-sac location overlooking green open space. The house features a living room with doors out onto the garden and a fitted kitchen. Upstairs is a double bedroom and a good size single that would work well as an office. There is also a bathroom with a shower over the bath. Externally is an enclosed rear garden and to the front are two allocated parking spaces.

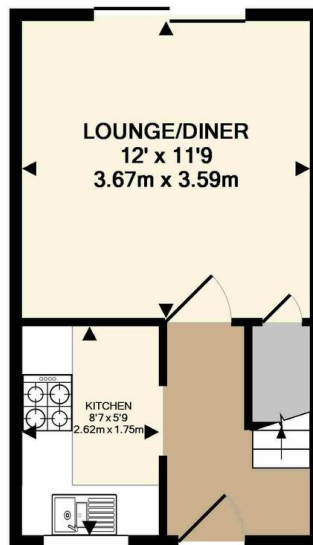
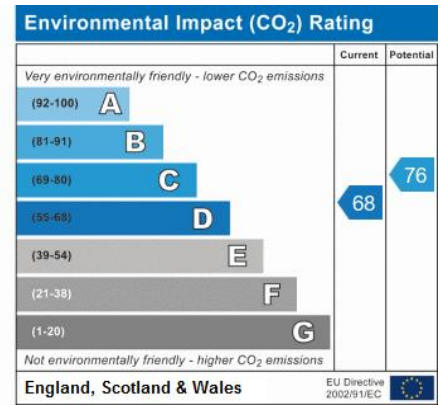
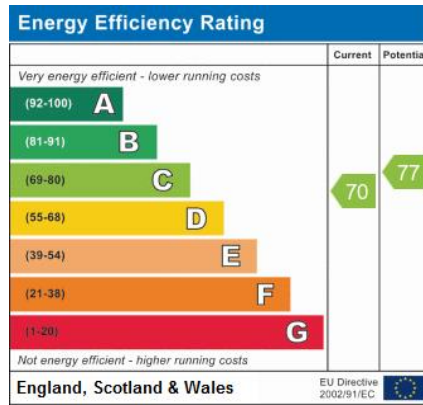

GROUND FLOOR
APPROX. FLOOR
AREA 243 SQ.FT.
(22.6 SQ.M.)

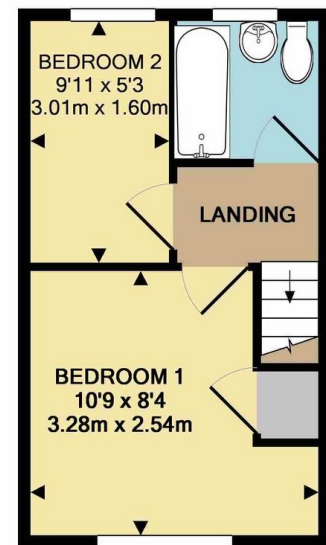

1ST FLOOR
APPROX. FLOOR
AREA 243 SQ.FT.
(22.6 SQ.M.)

TOTAL APPROX. FLOOR AREA 486 SQ.FT. (45.2 SQ.M.)

Whilst every attempt has been made to ensure the accuracy of the floor plan contained here, measurements of doors, windows, rooms and any other items are approximate and no responsibility is taken for any error, omission, or mis-statement. This plan is for illustrative purposes only and should be used as such by any prospective purchaser. The services, systems and appliances shown have not been tested and no guarantee as to their operability or efficiency can be given

Made with Metropix ©2017

Martin & Co Westbury

7 Palomino Place • Westbury • Wiltshire • BA13 3SD
T: 01373 866686 • E: westbury@martinco.com

01373 866686
<http://www.martinco.com>

MARTIN&CO

Accuracy: References to the Tenure of a Property are based on information supplied by the Seller. The Agent has not had sight of the title documents. A Buyer is advised to obtain verification from their Solicitor. Items shown in photographs including but not limited to carpets, fixtures and fittings are not included unless specifically mentioned within the sales particulars. They may however be available by separate negotiation. Buyers must check the availability of any property and make an appointment to view before embarking on any journey to see a property. No person in the employment of the agent has any authority to make any representation about the property, and accordingly any information given is entirely without responsibility on the part of the agents, sellers(s) or lessors(s). Any property particulars are not an offer or contract, nor form part of one. **Sonic / Laser Tape:** Measurements taken using a sonic / laser tape measure may be subject to a small margin of error. **All Measurements:** All Measurements are Approximate. **Services Not tested:** The Agent has not tested any apparatus, equipment, fixtures and fittings or services and so cannot verify that they are in working order or fit for the purpose. A Buyer is advised to obtain verification from their Solicitor or Surveyor.