



- \*Three Bedroom End Terrace House
- \*Garage
- \*Bathroom with walk in shower
- \*Kitchen/ dining room
- \*Three Double Bedrooms
- \*Freehold



### Ground Floor

Approx. 42.7 sq. metres (459.8 sq. feet)

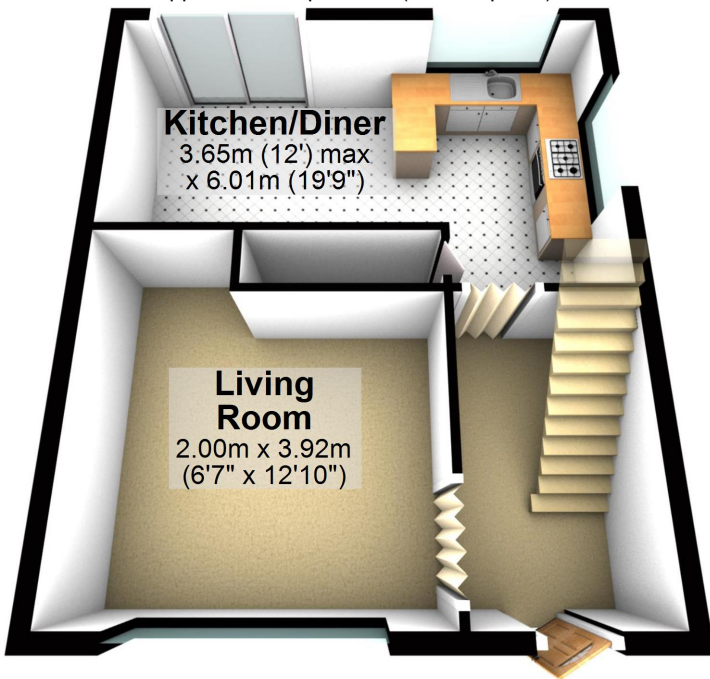

### First Floor

Approx. 42.7 sq. metres (459.8 sq. feet)



Total area: approx. 85.4 sq. metres (919.7 sq. feet)

These particulars do not form part of any offer or contract and must not be relied upon as statements or representations of fact. Any areas, measurements or distances are approximate. The text, photographs and plans are for guidance only and are not necessarily comprehensive. It should not be assumed that the property has all the necessary planning, building regulation or other consents and we have not tested services, equipment or facilities. Purchasers must satisfy themselves by inspection or otherwise.

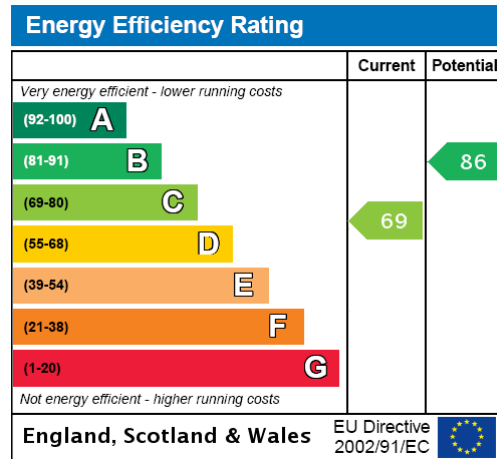

Title Number - MS288481

Local Authority - Sefton

Council tax - Band B

Estimated Annual Council Tax Cost - £1,819

Tenure - Freehold

Conservation Area - No

Flood Risk

Rivers & Seas: No Risk

Surface Water: Very Low

Satellite / Fibre TV Availability - BT, Sky

(Data source from Sprift)

'Unusually good at what we do'

Sell with a multi - "National award winning Estate Agent!"

'Straightforward Sales & Lettings'

These particulars do not form part of any offer or contract and must not be relied upon as statements or representations of fact. Any areas, measurements or distances are approximate. The text, photographs and plans are for guidance only and are not necessarily comprehensive. It should not be assumed that the property has all the necessary planning, building regulation or other consents and we have not tested services, equipment or facilities. Purchasers must satisfy themselves by inspection or otherwise.

97 | SOUTH ROAD | WATERLOO | L22 0LR

Tel: 0151 920 2404

E-mail: [info@logicstates.co.uk](mailto:info@logicstates.co.uk)

