

**MASEFIELD
FOUR
BEDROOM
HOME**

BLOOR HOMES



A four bedroom detached family home offering a charming lounge with bay window and stunning open plan kitchen / dining area with French doors leading to the rear garden. Upstairs boasts four generous sized bedrooms. The master bedroom on the first floor benefits from fitted wardrobes. This generous home also benefits from a separate family bathroom and shower room.

MASEFIELD

A STUNNING FOUR BEDROOM
DETACHED HOME

**MASEFIELD
FOUR
BEDROOM
HOME**

GROUND FLOOR:

LOUNGE
4.75m x 3.26m
15'7" x 10'8"

KITCHEN / DINING
4.75m x 4.14m
15'7" x 13'7"

CLOAKS

FIRST FLOOR:

BEDROOM 1
4.75m x 2.79m
15'7" x 9'2"

BEDROOM 2
4.75m x 3.26m
15'7" x 10'8"

BATHROOM

SECOND FLOOR:

BEDROOM 3
3.63m x 3.30m
11'11" x 10'10"

BEDROOM 4
3.63m x 2.83m
11'11" x 9'3"

SHOWER ROOM



**SECOND
FLOOR**

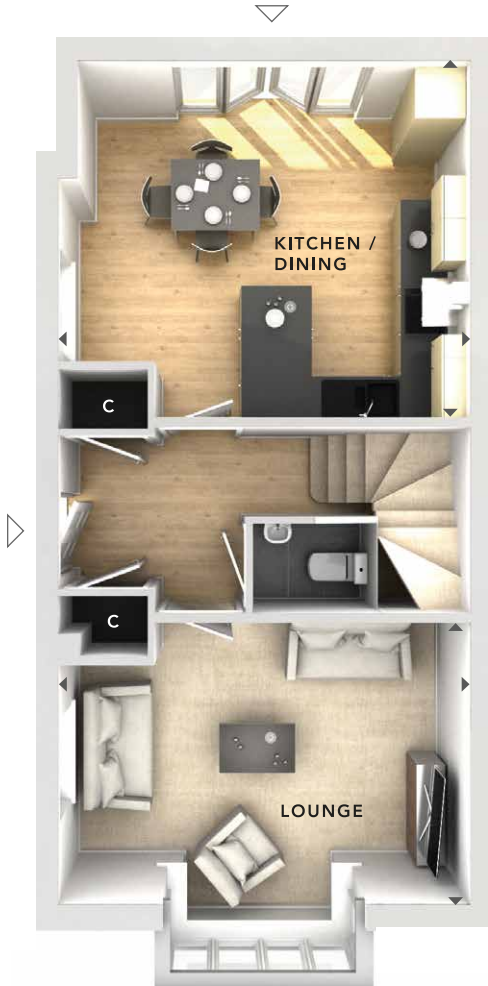

**GROUND
FLOOR**

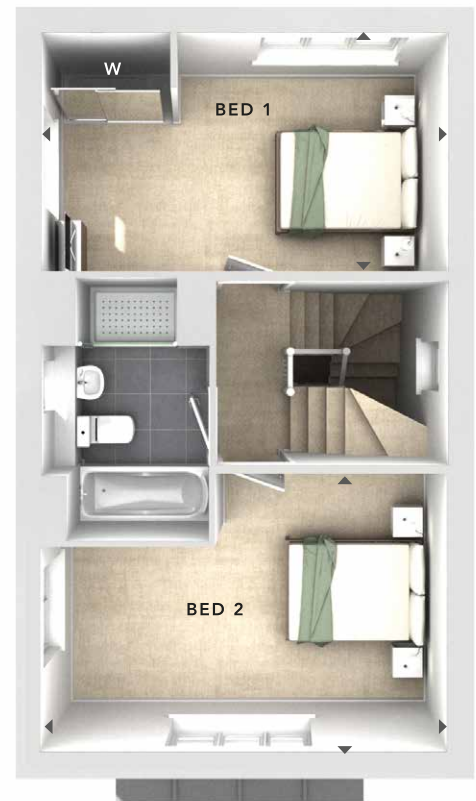

**FIRST
FLOOR**

- W** - Fitted Wardrobes
- C** - Storage
- △ - External Access
- ◀▶ - Measurement Points

421 BRICK WIMBORNE

BLOOR HOMES

These particulars are intended as a preliminary guide for prospective purchasers and should not be relied upon. The elevational treatment for individual house types shows a typical arrangement. Details of materials and design treatments may vary. Any artist impressions shown are not intended to represent any particular plot. Purchasers are advised to inspect the layout plan to establish the arrangement of the house and surrounding property. Internal layouts show a general arrangement which may vary from plot to plot. Room sizes given are approx. overall finished room sizes and subject to normal building tolerances (i.e. ± 75mm). In all instances purchasers are advised to inspect plot specific information available from our sales team. Nothing in these particulars or verbal assurance shall form or constitute part of any contract, and are given without any responsibility on behalf of Bloor Homes.