

CHESTERTON  
TWO  
BEDROOM  
HOME

BLOOR HOMES



A two bedroom semi-detached home with a charming lounge and stunning open plan kitchen / dining area with a convenient utility area, cloakroom and French doors opening onto the rear garden. The first floor is home to the family bathroom and two spacious double bedrooms with the master featuring an en suite shower room.

CHESTERTON

A CHARMING TWO BEDROOM  
SEMI-DETACHED HOME

**CHESTERTON  
TWO  
BEDROOM  
HOME**

**FIRST FLOOR:**

**BEDROOM 1**  
2.87m x 2.40m  
9'5" x 7'10"

**EN SUITE**

**BEDROOM 2**  
4.60m x 3.09m  
15'1" x 10'2"

**BATHROOM**

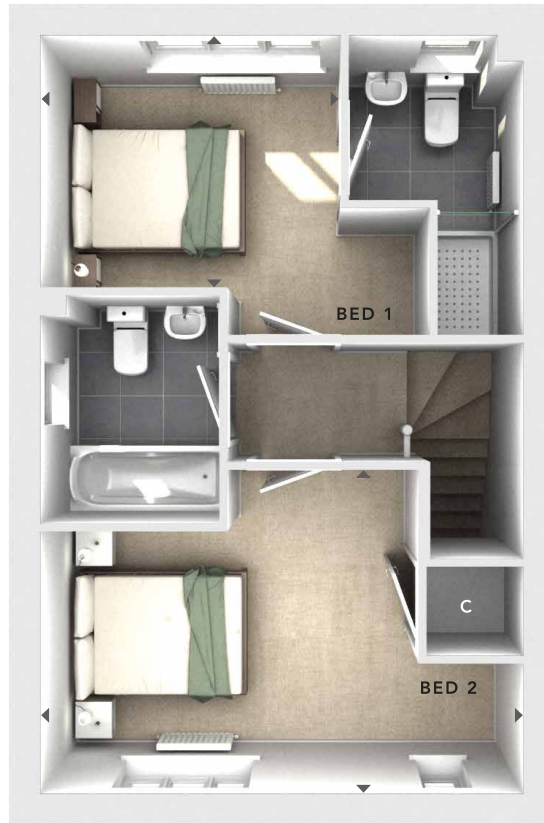

**GROUND FLOOR:**

**LOUNGE**  
3.52m x 4.17m  
11'7" x 13'8"

**KITCHEN / DINING**  
3.48m x 3.01m  
11'5" x 9'10"

**UTILITY**  
1.05m x 1.70m  
3'5" x 5'7"

**CLOAKS**

**FIRST  
FLOOR**

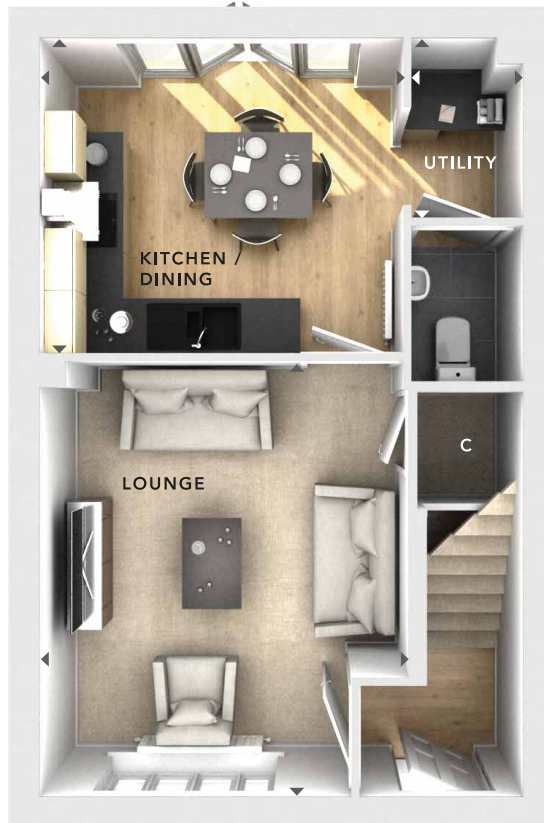

**GROUND  
FLOOR**

<b>C</b>	- Storage
△	- External Access
◄►	- Measurement Points
<b>272 RENDER 4.2</b>	



These particulars are intended as a preliminary guide for prospective purchasers and should not be relied upon. The elevational treatment for individual house types shows a typical arrangement. Details of materials and design treatments may vary. Any artist impressions shown are not intended to represent any particular plot. Purchasers are advised to inspect the layout plan to establish the arrangement of the house and surrounding property. Internal layouts show a general arrangement which may vary from plot to plot. Room sizes given are approx. overall finished room sizes and subject to normal building tolerances (ie ± 75mm). In all instances purchasers are advised to inspect plot specific information available from our sales team. Nothing in these particulars or verbal assurance shall form or constitute part of any contract, and are given without any responsibility on behalf of Bloor Homes.