



- 6 Bedroom Detached Family Home
- Gorgeous Conservatory
- Private Rear Garden
- Off Street Parking
- Downstairs W,C,

Langley Avenue, Worcester Park

Price £650,000

A lovely 5 bedroom detached property in KT4 area. A reception room and spacious family/living room leading to the kitchen and the gorgeous conservatory with a generous private rear garden. On the first floor, 5 bedrooms and a family bathroom. The property also has off street parking for a few cars.



Energy Efficiency Rating		Current	Potential
Very energy efficient - lower running costs			
(92 Plus)	A		
(81-91)	B		84
(69-80)	C		
(55-68)	D	58	
(39-54)	E		
(21-38)	F		
(1-20)	G		
Not energy efficient - higher running costs			
England & Wales		EU Directive 2002/91/EC	

SeOUL Residential Ltd.
158 High Street
New Malden
KT3 4ES

020 8949 4989
sales@sr4u.co.uk

GROUND FLOOR
840 sq.ft. (78.1 sq.m.) approx.

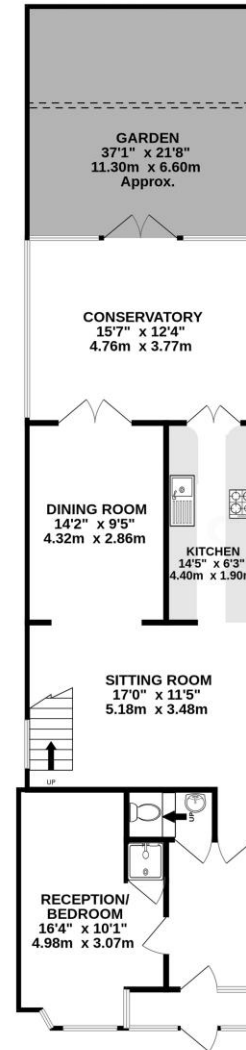

1ST FLOOR
648 sq.ft. (60.2 sq.m.) approx.



TOTAL FLOOR AREA : 1488 sq.ft. (138.2 sq.m.) approx.

Whilst every attempt has been made to ensure the accuracy of the floorplan contained here, measurements of doors, windows, rooms and any other items are approximate and no responsibility is taken for any error, omission or mis-statement. This plan is for illustrative purposes only and should be used as such by any prospective purchaser. The services, systems and appliances shown have not been tested and no guarantee as to their operability or efficiency can be given.
Made with Metropix ©2023

Agents Note: Whilst every care has been taken to prepare these particulars, they are for guidance purposes only. All measurements are approximate and for general guidance purposes only and they should not be relied upon and potential buyers / tenants are advised to recheck the measurements.