



Lloyd Street, Stockport,

 2 |  1 |  1

£180,000





## Property Details

# Lloyd Street, Stockport,

CALLING ALL INVESTORS, Spencer Harvey bring to the market this good sized two bedroom garden fronted mid terraced property offered with NO VENDOR CHAIN and tenants in situ. Making this an instant income stream property to add to your portfolio.

Situated in a popular location close to public transport and the motorway network, not forgetting Stockport centre with its many amenities.

The property briefly comprises: Lounge, kitchen with a range of units and built in oven and hob, On the first floor is a large principle bedroom, second bedroom and bathroom with white three piece suite.

The property benefits from cellars and rear gated parking.

Must be viewed to fully appreciate what this period terrace has to offer.

## Key Features

- No Vendor Chain
- Close to Amenities

Lounge  
4.01m 2.84

Kitchen  
4.01m x 2.46m  
Range of wall and base units  
Central Heating boiler  
Door to rear Yard

Bathroom  
2.89m x 1.86m

Bedroom 1

Bedroom 2

## Anti Money Laundering Checks

Please be advised that, in accordance with legal requirements and to maintain compliance with Anti-Money Laundering regulations, prospective buyers are obligated to undergo AML checks upon acceptance of their offer for the property listed in this brochure.

These AML checks are a mandatory part of the property transaction process and are designed to prevent and detect potential money laundering activities. The cost associated with each AML check is £30 per applicant, and this fee will be charged to the respective individuals undergoing the checks.

Please note that failure to comply with these AML checks may result in delays or complications in the completion of the property transaction.



At Spencer Harvey, we are delighted to say that we are independent estate agents, which means that we will put your needs first at all times. If you want to learn more about why we are amongst the fastest growing independent estate agents in Manchester, please get in touch to arrange an appointment.

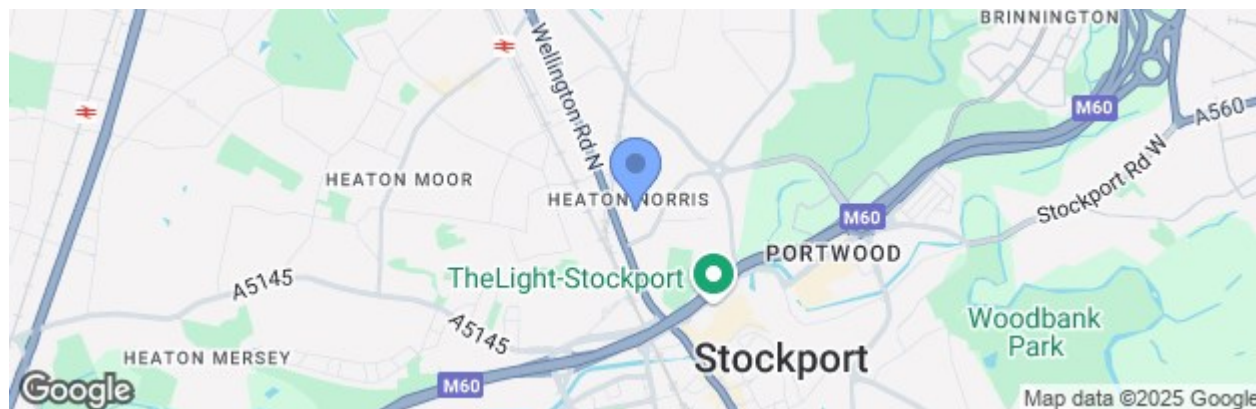

BASEMENT

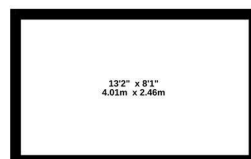

GROUND FLOOR

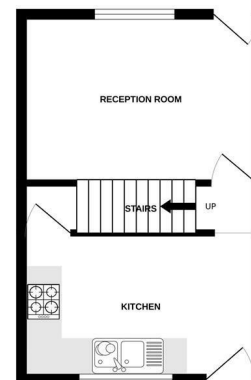

1ST FLOOR

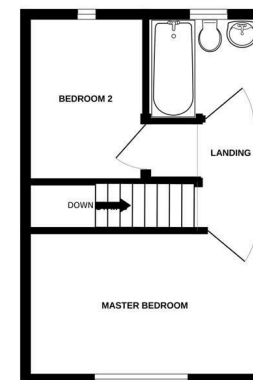

Whilst every attempt has been made to ensure the accuracy of the floorplan contained here, measurements of doors, windows, rooms and any other items are approximate and no responsibility is taken for any error, omission or mis-statement. This plan is for illustrative purposes only and should be used as such by any prospective purchaser. The services, systems and appliances shown have not been tested and no guarantee as to their operability or efficiency can be given.  
Made with Metrepro ©2025



## Contact Us

 137 Shaw Heath Stockport

 0161 480 8888

 Sales@spencerharvey.co.uk

www.spencerharvey.co.uk

OR SEND US A  
MESSAGE



COUNCIL TAX BAND:

A

TENURE:

Freehold

EPC RATING:

D

LOCAL AUTHORITY:

Stockport