



109A HIGH STREET,
PORTISHEAD, BS20 6PT

GOODMAN
& LILLEY



A SPACIOUS TWO-BEDROOM DUPLEX APARTMENT SET WITHIN A CHARMING CHARACTER BUILDING ON THE BUSTLING HIGH STREET. OFFERING VERSATILE ACCOMMODATION ARRANGED OVER TWO FLOORS, THIS PROPERTY BENEFITS FROM A SHARE OF THE FREEHOLD AND AN EXCELLENT CENTRAL POSITION.

Ground Floor

You access the property via a ground-floor communal entrance shared with just one other residence. Upon entering the apartment, you are welcomed into a spacious kitchen–diner, an ideal area for entertaining. The kitchen is fully fitted, offering space for all appliances, a breakfast bar, and a window to the side aspect. There is ample room for a large dining table, and a set of stairs rises from this room to the upper floor, with a window positioned over the staircase providing natural light. Also on the ground floor is a generous lounge featuring an angled corner window, two additional windows, and an attractive fireplace, creating a bright and welcoming living space.

First Floor

The staircase opens directly into a first-floor reception area, currently used as a second sitting room, which could also make an excellent study space. Also on this floor are two double bedrooms, served by a bathroom fitted with a three-piece suite comprising a panelled bath with shower over, a low-level WC, and a pedestal sink.

Local Area

Nestled just off Portishead High Street, this apartment places you in the heart of a lively town centre, surrounded by charming independent shops, caf  s, and restaurants. A short stroll brings you to the picturesque Marina, perfect for waterside walks and relaxed dining. Excellent transport links make Bristol easily accessible, combining the best of seaside living with city convenience.

Agent Notes

This property is leasehold. The building is self managed with the management company being made up of the owners in the building, of which the new owner will become one.

- Central Town Location
- Two Double Bedrooms
- Open Plan Kitchen/Diner
- Self Managed Building
- Character Building

- Duplex Apartment
- Spacious Living Room
- Share Of Freehold
- Over 1000Sqft Of Diverse Accommodation



GUIDE PRICE £250,000



First Floor

Approx. 46.7 sq. metres (503.1 sq. feet)



Second Floor

Approx. 54.6 sq. metres (587.3 sq. feet)

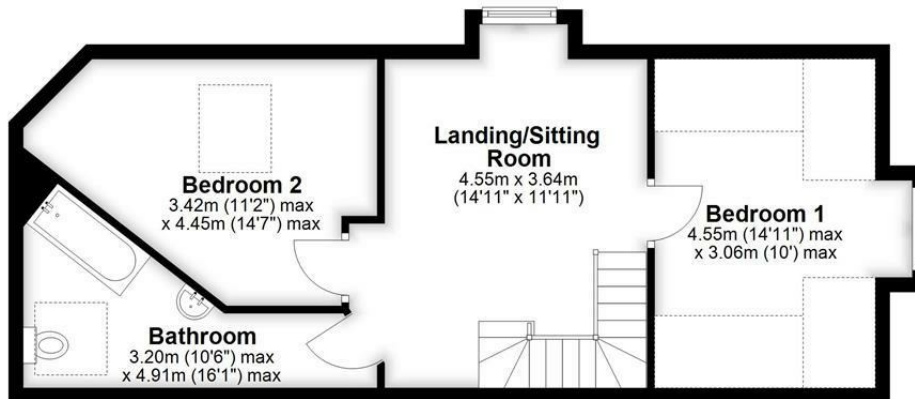

Total area: approx. 101.3 sq. metres (1090.4 sq. feet)

HENLEAZE - 0117 2130777
henleaze@goodmanlilley.co.uk

PORTISHEAD - 01275 430440
sales@goodmanlilley.co.uk

SHIREHAMPTON - 0117 2130333
shire@goodmanlilley.co.uk

Zoopla.co.uk

rightmove



WWW.GOODMANLILLEY.CO.UK

These particulars are for general guidance only. They do not form or constitute any part of an offer or contract. Goodman & Lilley has not carried out structural surveys of the property. The services, appliances or specific fittings mentioned in these details have not been tested. Every attempt is made to ensure accuracy, however all photographs, measurements, floor plans and distances are for illustrative purposes only. They must not be relied upon when purchasing carpets and or other fixtures & fittings. Lease details, service charges and ground rents are given as a guide only. They should be checked and confirmed by a licensed solicitor prior to exchange of contracts. The copyright of all details, photographs and floor plans remain exclusive to Goodman & Lilley.