



2 SERBERT CLOSE,
PORTISHEAD, BS20 7SS

GOODMAN
& LILLEY



A MODERN GROUND FLOOR APARTMENT WITH ONE SPACIOUS BEDROOM, A WELL-APPOINTED BATHROOM AND OPEN PLAN LIVING SPACE THIS PROPERTY OFFERS COMFORT AND CONVENIENCE.

A modern ground floor apartment with one spacious bedroom, a well-appointed bathroom and open plan living space this property offers comfort and convenience. One of the highlights of this apartment is its private garden, providing a tranquil outdoor space for you to enjoy some fresh or entertain. Conveniently located close to amenities, you'll have shops, cafes, and more right at your doorstep. As well as an allocated off road parking space.

M5 (J19) 3 miles, M4 (J20) 11 miles, Bristol Parkway 14 miles, Bristol Temple Meads 10.5 miles, Bristol Airport 12 miles (distances approximate).

Tenure: Leasehold with management charges Ground Rent £205 P/A Service Charge £1221.24 P/A

Local Authority: North Somerset Council Tel: 01934 888888.

Council Tax Band: B

Services: All mains services connected.

Accommodation Comprising

Entrance Hall

As you step into the entrance hall of this charming one-bedroom flat, you're greeted by a spacious and welcoming area that sets the tone for the rest of the home. The hall features clean, neutral décor and offers access to the various key spaces within the flat. Straight ahead you will find, a door leading into the bright and airy bedroom, providing a peaceful retreat. To the right, you'll find the open-plan living space, perfect for relaxing and entertaining, while to the left, a door opens to the contemporary bathroom. Additionally, there's a handy airing cupboard offering extra storage space, keeping everything neat and organized. The layout flows effortlessly, making the most of the flat's dimensions and offering a sense of space and comfort.

Open Plan Living Space

The lounge area is spacious, with ample room for comfortable seating. French doors that open seamlessly onto a small, enclosed garden, this outdoor space offers the perfect spot for enjoying a morning coffee or dining al fresco. Thus extending the living area and bringing a touch of nature right to your doorstep. The flow between the interior and garden creates a real sense of harmony and space.

Kitchen

The kitchen features sleek, contemporary cabinetry with a clean, minimalist design,

making the most of the space. The kitchen is equipped with integrated appliances, including a compact oven, hob, and fridge-freezer, all seamlessly blending into the design. The countertops are practical yet elegant, offering plenty of room for meal preparation. Despite its size, the layout ensures everything is within easy reach, making it ideal for quick meals or casual cooking. The kitchen's neutral tones and modern finishes create a fresh, light atmosphere.

Master Bedroom

The master bedroom in this modern one-bedroom apartment offers a peaceful and comfortable retreat. It's generously sized, with plenty of room for a large double bed and additional furniture, making it feel both spacious and inviting. The room is filled with natural light thanks to large windows, creating a bright and airy atmosphere throughout the day. The neutral décor and contemporary finishes enhance the sense of calm. Whether you're unwinding after a busy day or enjoying a quiet morning, this bedroom offers a cozy yet sophisticated sanctuary to call your own.

Bathroom

The bathroom features a sleek, contemporary three-piece suite that blends style with functionality. The modern, well-designed suite includes a spacious walk-in shower with a stylish glass screen, a contemporary pedestal sink, and a WC, all finished in crisp, clean lines. The fixtures are finished in chrome, adding a touch of elegance, and the neutral tones of the tiles enhance the modern, fresh feel of the space. Cleverly designed to make the most of the room's dimensions, the layout offers a practical and uncluttered environment, perfect for relaxation or a quick refresh. The overall aesthetic is minimalist yet chic, providing a spa-like feel in the comfort of your own home.

Private Garden

This ground-floor apartment boasts the added benefit of an enclosed private garden, offering a wonderful outdoor space for both relaxation and entertainment. The garden is well-maintained and fully enclosed, providing a sense of privacy and security. It's the perfect spot for enjoying the fresh air, lounging with a good book, or simply unwinding after a busy day. The garden is easily accessible through French doors from the living area, creating a seamless indoor-outdoor flow. With a manageable size, it offers plenty of potential for personal touches—whether that's adding some greenery, outdoor furniture, or creating your own private sanctuary. It's a true gem for those seeking outdoor space in a city setting.

- Garden Apartment
- Spacious Open-Plan Living
- Close To Amenities
- Located Close To Amenities
- Private Garden

- One Double Bedroom
- Modern Kitchen & Bathroom
- Allocated Parking Space
- Great Transport Links



GUIDE PRICE £205,000



Garden Floor

Approx. 48.5 sq. metres (522.2 sq. feet)

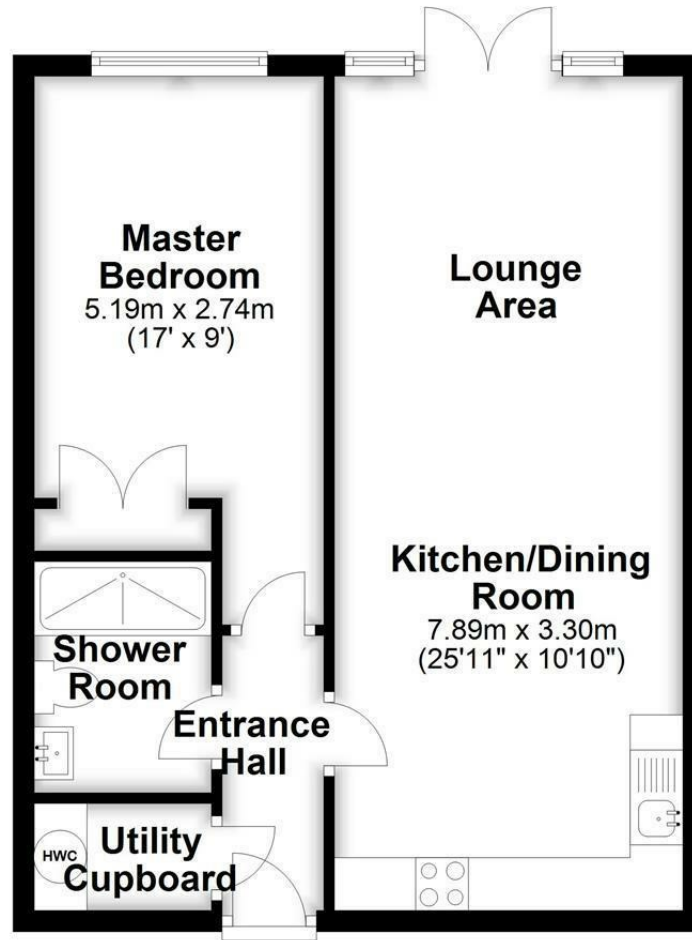

Total area: approx. 48.5 sq. metres (522.2 sq. feet)

HENLEAZE - 0117 2130777
henleaze@goodmanlilley.co.uk

PORTISHEAD - 01275 430440
sales@goodmanlilley.co.uk

SHIREHAMPTON - 0117 2130333
shire@goodmanlilley.co.uk

Zoopla.co.uk

rightmove



WWW.GOODMANLILLEY.CO.UK

These particulars are for general guidance only. They do not form or constitute any part of an offer or contract. Goodman & Lilley has not carried out structural surveys of the property. The services, appliances or specific fittings mentioned in these details have not been tested. Every attempt is made to ensure accuracy, however all photographs, measurements, floor plans and distances are for illustrative purposes only. They must not be relied upon when purchasing carpets and or other fixtures & fittings. Lease details, service charges and ground rents are given as a guide only. They should be checked and confirmed by a licensed solicitor prior to exchange of contracts. The copyright of all details, photographs and floor plans remain exclusive to Goodman & Lilley.