



Warbeck Road, Shepherds
Bush, London W12 8NT

Guide Price £645,000



Warbeck Road, Shepherds Bush, London W12 8NT

Guide Price £645,000



Summary Description

Warbeck Road, W12. A desirable two bedroom apartment in Shepherds Bush. The property offers impressive high ceilings and generous proportions. A grand through reception room leads through double sliding doors to a fitted kitchen, with French doors opening out onto a private rear garden. The property has two bedrooms at garden level and stairs to a bathroom at lower ground floor level. The attractive rear garden is West facing. The flat is offered chain-free.

The location offers ultra-convenience for all the shops, bars and restaurants on the Uxbridge Road, the Westfield shopping centre, John Lewis and the infamous Soho House members club. The location is extremely well served transport wise with the Hammersmith and City and Central Line tubes, Shepherds Bush Over ground station and numerous bus routes in to Central London. For recreational use the lovely Hammersmith Park is only a short walk away.

Share of freehold, Service charge, GR

Hammersmith and Fulham Council tax band D

Area Map

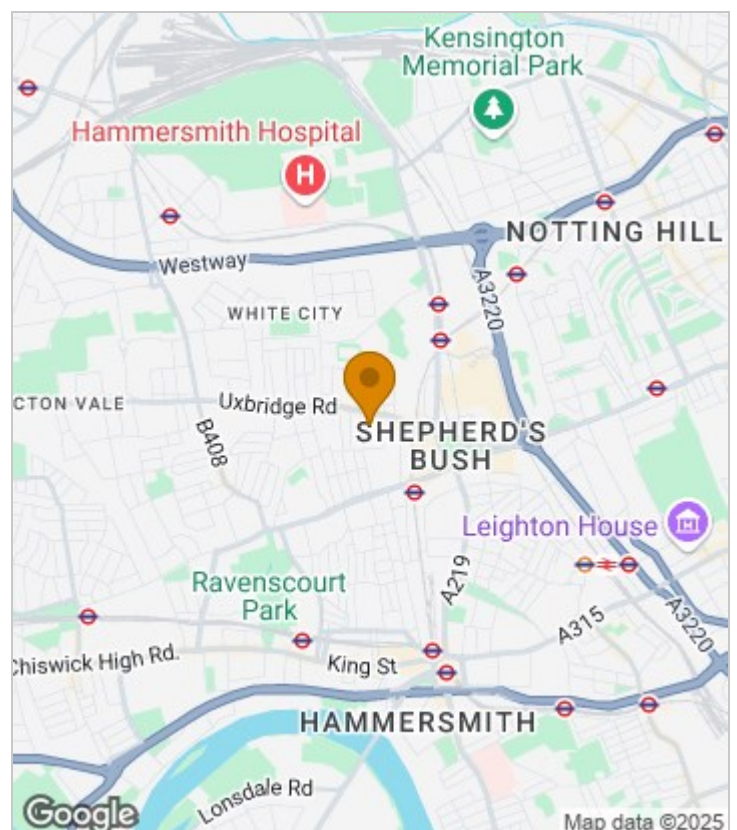



Floor Plan

jorgensenturner
estate agents

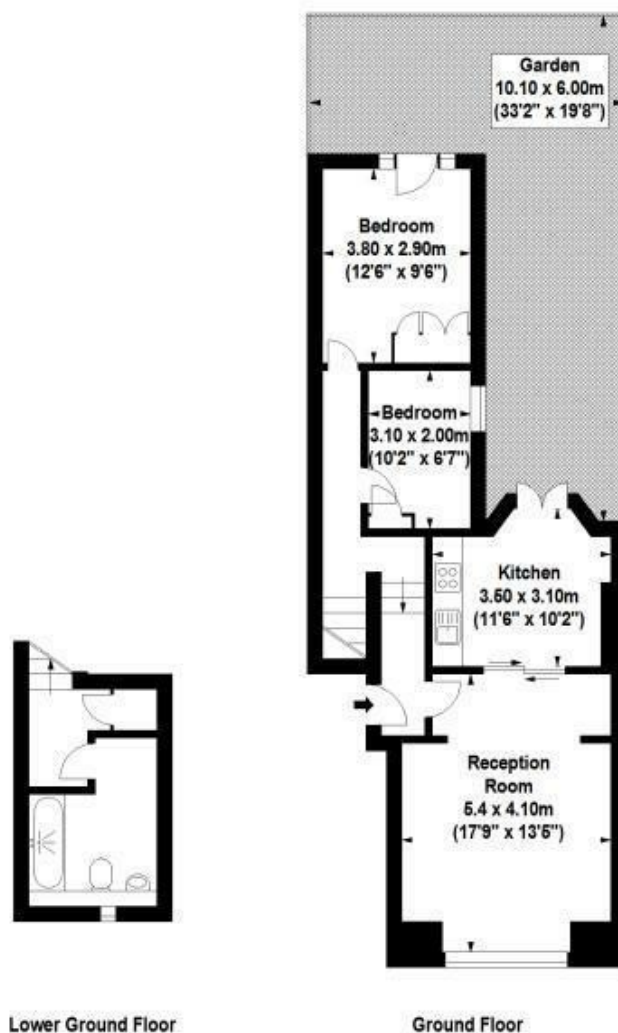

For Identification Purposes Only. Not To Scale. © www.alanaiken.com 2016

Warbeck Road, W12

Approx. Gross Internal Area
69.68 Sq M - 750 Sq Ft

TOTAL VISTA

Energy Efficiency Graph

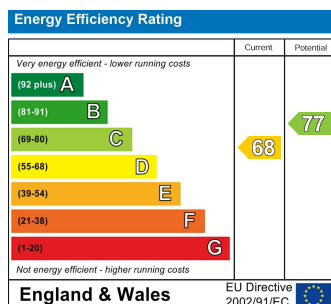

Viewing

Please contact our Sales SB Office on 0208 740 8740 if you wish to arrange a viewing appointment for this property or require further information.

- PRIVATE WEST FACING GARDEN
- TWO BEDROOMS
- SPACIOUS THROUGH RECEPTION ROOM
- HIGH CEILINGS
- SHARE OF FREEHOLD
- PRIME RESIDENTIAL ROAD
- CHAIN FREE
- CLOSE TO WESTFIELD WHITE CITY
- CENTRAL LINE TUBE
- HAMMERSMITH AND CITY LINE TUBE

For further information contact:

Sales SB, 234 Uxbridge Road, Shepherds Bush, London, W12 7JD

Tel: 0208 740 8740 Email: enquiries@jorgensenturner.com

<https://www.jorgensenturner.com/>

Disclaimer

These particulars, whilst believed to be accurate are set out as a general outline only for guidance and do not constitute any part of an offer or contract. Intending purchasers should not rely on them as statements of representation of fact, but must satisfy themselves by inspection or otherwise as to their accuracy. No person in this firm's employment has the authority to make or give any representation or warranty in respect of the property.

