



jt | JORGENSENTURNER



Coningham Road
Shepherds Bush London
Asking Price £525,000



jt 3 1 1 D jt

Coningham Road Shepherds Bush London

Asking Price £525,000



Summary Description

Coningham Road W12. A really well proportioned three bedroom apartment with a private balcony. The apartment offers a spacious through kitchen reception room, three generously proportioned bedrooms and a modern fitted bathroom. The apartment offers great storage space throughout and there's allocated off street parking to the rear of the property.

Coningham Road runs between Goldhawk Road and Uxbridge Road enabling easy access to all the amenities on offer in Shepherd's Bush or Hammersmith. The location has fantastic transport links with a number of convenient buses running from either the Goldhawk Road or the Uxbridge Roads. There are also a number of tubes within the immediate area with the Hammersmith and City Line on Goldhawk Road, the Central Line station at Shepherds Bush or the British Rail station at Shepherds Bush. For recreational use the lovely open spaces of Ravenscourt Park are only a short walk away.

Leasehold 85yrs SC £1672.77pa GR £10pa

Area Map

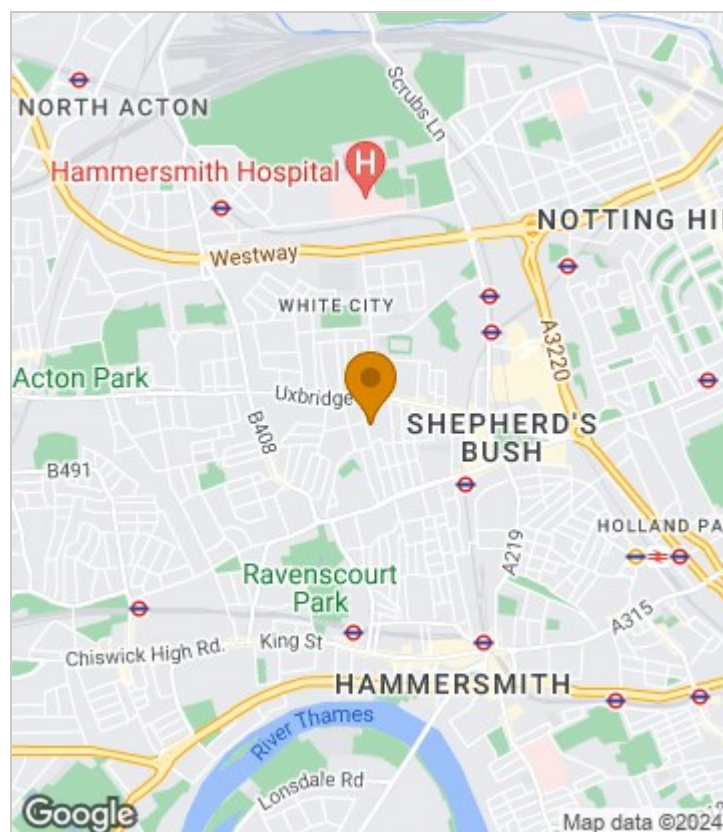



Floor Plan

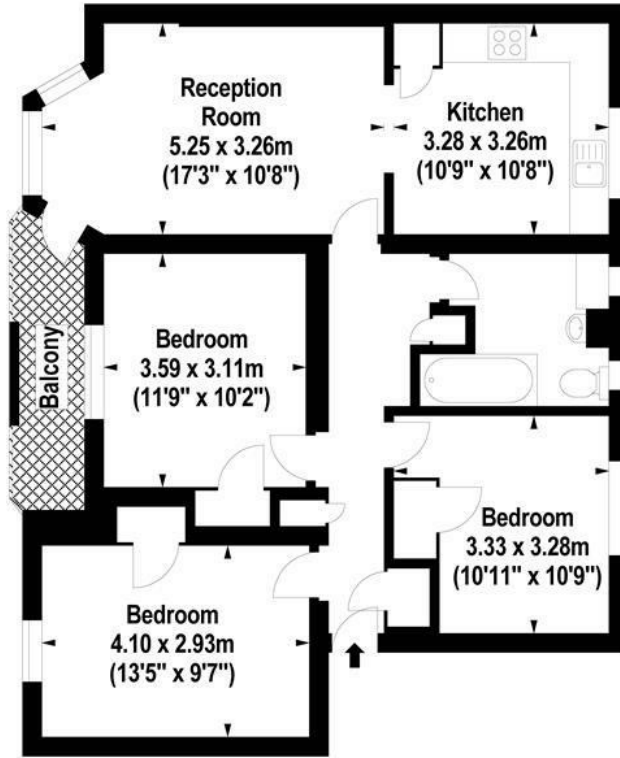

Third Floor



For Identification Purposes Only. Not To Scale. © www.totalvista.uk 2024

Coningham Road , W12

Approx. Gross Internal Area
82.40 Sq M - 887 Sq Ft



Energy Efficiency Graph

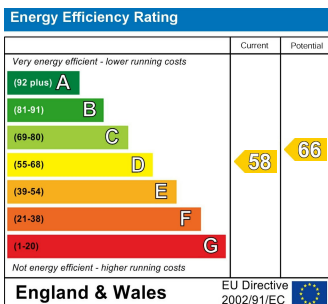

Viewing

Please contact our Sales SB Office on 0208 740 8740 if you wish to arrange a viewing appointment for this property or require further information.

- THREE BEDROOM APARTMENT
- PRIVATE BALCONY
- THIRD FLOOR
- GOOD CONDITION THROUGHOUT
- SPACIOUS THROUGH RECEPTION
- CENTRAL SHEPHERDS BUSH LOCATION
- HAMMERSMITH AND CITY LINE TUBE
- CENTRAL LINE TUBE
- WALKING DISTANCE TO WESTFIELD
- ALLOCATED OFF STREET PARKING WHITE CITY

For further information contact:

Sales SB, 234 Uxbridge Road, Shepherd's Bush, London, W12 7JD

Tel: 0208 740 8740 Email: enquiries@jorgensenturner.com

<https://www.jorgensenturner.com/>

Disclaimer

These particulars, whilst believed to be accurate are set out as a general outline only for guidance and do not constitute any part of an offer or contract. Intending purchasers should not rely on them as statements of representation of fact, but must satisfy themselves by inspection or otherwise as to their accuracy. No person in this firm's employment has the authority to make or give any representation or warranty in respect of the property.

