



Blaxland House, White
City Estate, London, W12
ZMLL
Guide Price £330,000



Blaxland House, White City Estate, London, W12

Guide Price £330,000



Summary Description

Blaxland House, White City W12. A great first time buy or rental investment. This ground floor two bedroom apartment is in excellent order and has been re-decorated throughout. There are two double bedrooms, spacious reception room, a fully fitted kitchen, bathroom and a separate WC. The property further benefits from a long lease and is offered chain free.

Blaxland House is located within a short walk from a wealth of shops, bars and restaurants in central Shepherds Bush or Westfield shopping centre. Transport wise, the location is extremely well served by the Central Line tube (White City), Hammersmith and City Line (Shepherds Bush Market) and a number of excellent bus routes from the Uxbridge Road or Wood Lane in to Central London. For the motorist, The A40 is only moments away from the property.

Lease 116yrs, SC £1442pa GR £10pa

Area Map

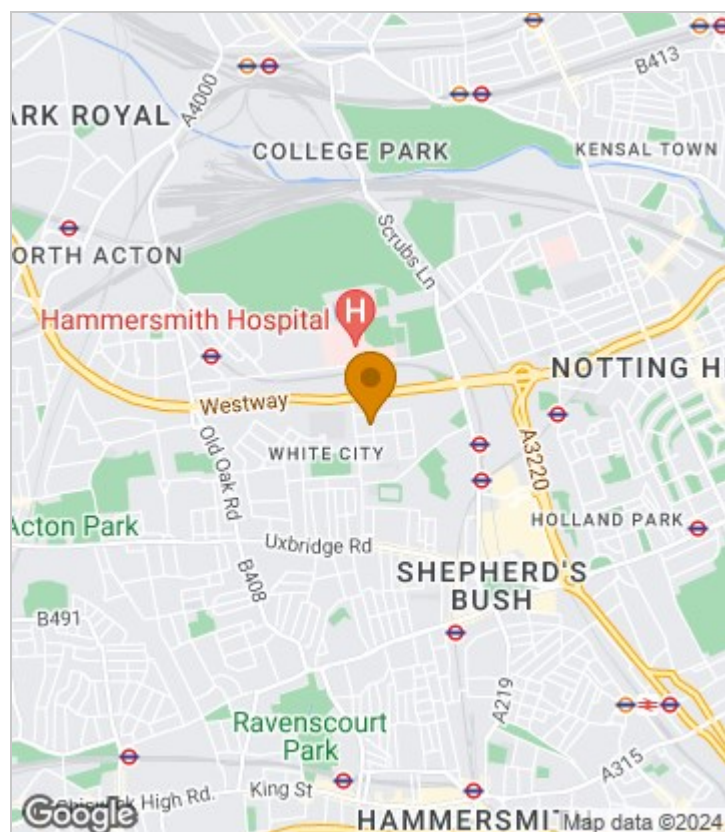



Floor Plan

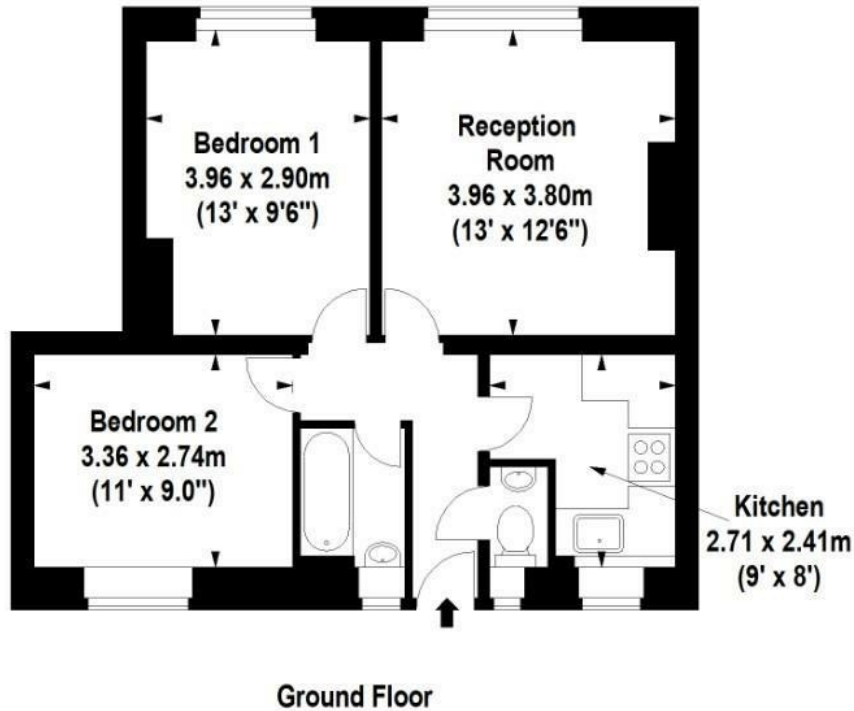

For Identification Purposes Only. Not To Scale. © www.totalvista.uk 2024



**Blaxland House,
White City Estate, W12**

Approx. Gross Internal Area
50.91 Sq M - 548 Sq Ft



Energy Efficiency Graph

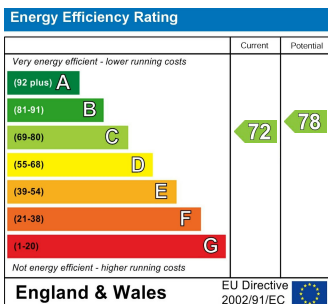

Viewing

Please contact our Sales SB Office on 0208 740 8740 if you wish to arrange a viewing appointment for this property or require further information.

- TWO DOUBLE BEDROOMS
- PRIVATE FRONT DOOR
- NEWLY DECORATED
- CHAIN FREE
- PRIVATE FRONT PATIO AREA
- SPACIOUS RECEPTION ROOM
- LONG LEASE
- CLOSE TO WESTFIELD WHITE CITY
- CENTRAL LINE TUBE

For further information contact:

Sales SB, 234 Uxbridge Road, Shepherds Bush, London, W12 7JD

Tel: 0208 740 8740 Email: enquiries@jorgensenturner.com

<https://www.jorgensenturner.com/>

Disclaimer

These particulars, whilst believed to be accurate are set out as a general outline only for guidance and do not constitute any part of an offer or contract. Intending purchasers should not rely on them as statements of representation of fact, but must satisfy themselves by inspection or otherwise as to their accuracy. No person in this firm's employment has the authority to make or give any representation or warranty in respect of the property.