



Uxbridge Road, London

£1,600 Per Month

jo



1



1



1



E

jo

# Uxbridge Road, London

£1,600 Per Month



## Summary Description

Jorgensen Turner Estate Agents are thrilled to present this fantastically located first-floor apartment, now available on the market. Situated in the vibrant heart of W12 on Uxbridge Road, this contemporary one-bedroom property beautifully marries the excitement of city life with the peacefulness of park side living.

Occupying a space of 348sqft, the apartment is a testament to modern, minimalist design. It features stylish hardwood flooring and sleek built-in kitchen appliances, all finished to a high standard. The heart of this beautiful home is its spacious terrace, which offers relaxed views over Shepherd's Bush Green, providing a rare opportunity for outdoor living in the midst of the city's hustle and bustle.

The location is exceptional, with the apartment being a stone's throw from the historic Shepherd's Bush War Memorial and the creative flair of The Helix near Westfield Shopping Centre. This ensures residents are never far from a wide array of shopping, dining, and entertainment options. Its locality to Shepherd's Bush Market and White City underground stations further affords excellent connectivity across London, making it a highly desirable residence.

This one-bedroom, one-bathroom apartment captures the essence of contemporary London living. It offers a blend of dynamic personalisation and peaceful settings, making it an ideal home for those looking to immerse themselves in the best of what London has to offer. Available end of May, this property is available on a furnished basis, inviting you to infuse it with your personal style and finish.

Council Tax Band B—Hammersmith & Fulham.

Deposit: One weeks' rent to reserve, with a security deposit of either 5 weeks' rent (for properties under £50,000pa) or 6 weeks' rent (for those over £50,000pa).

## Area Map

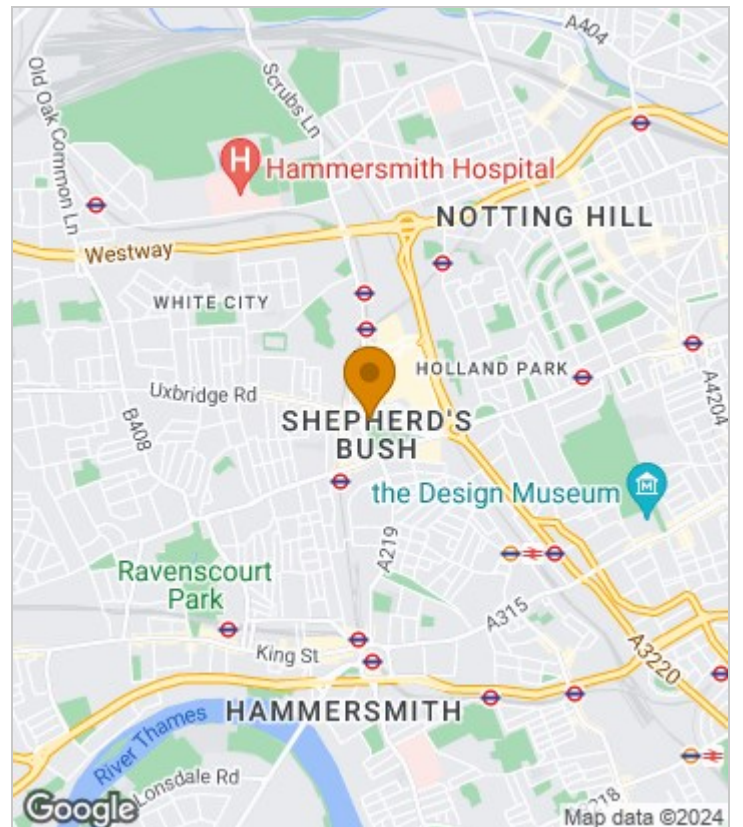



## Floor Plan

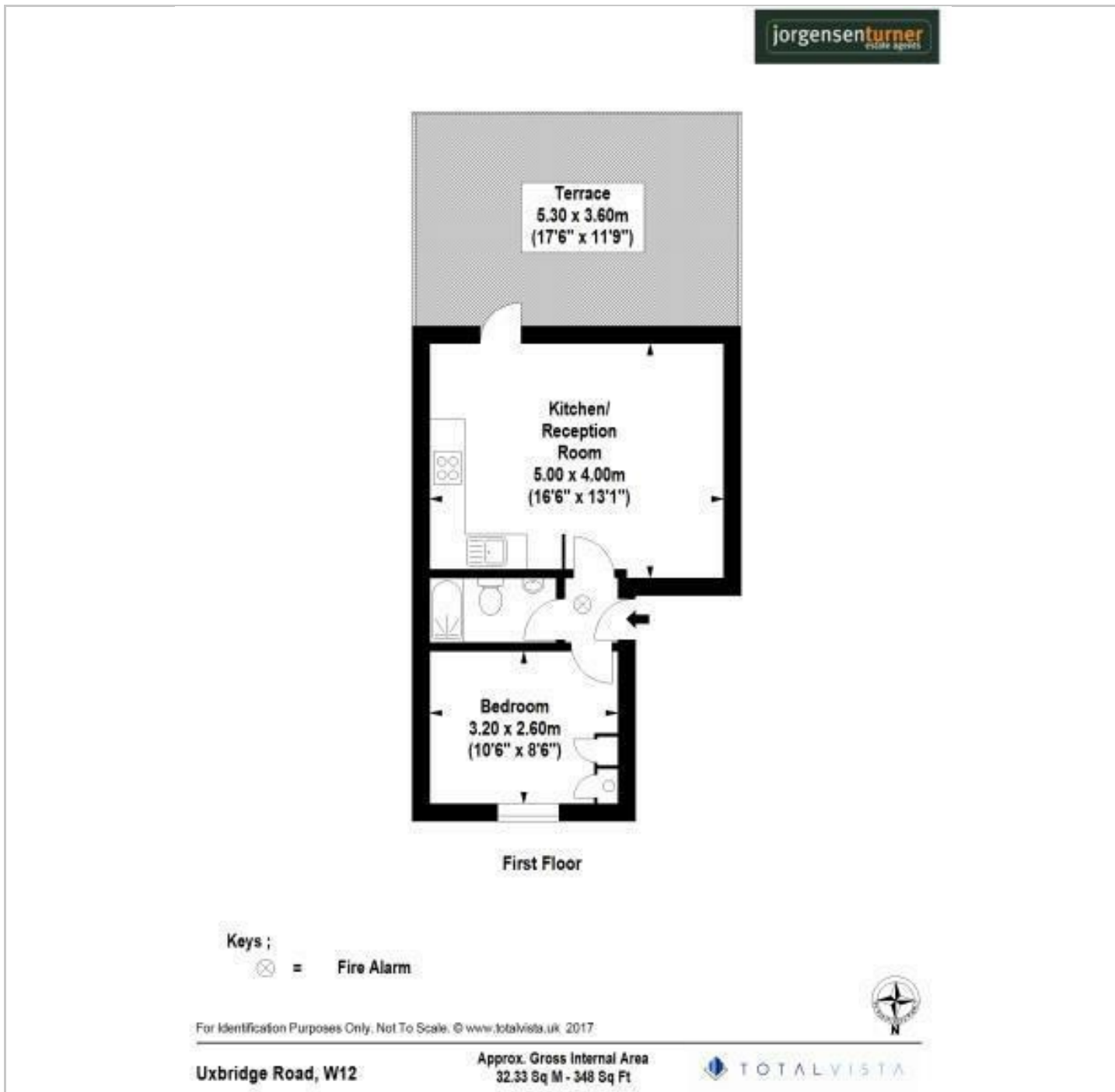

## Energy Efficiency Graph

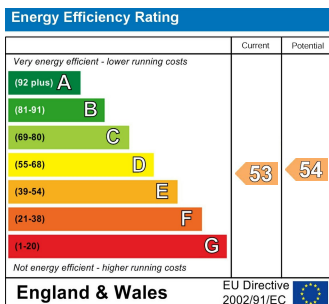

## Viewing

Please contact our Lettings SB Office on 0208 740 8740 if you wish to arrange a viewing appointment for this property or require further information.

- FANTASTICALLY LOCATED
- MODERN, MINIMALIST DESIGN AESTHETIC
- STYLISH WOOD FLOORING THROUGHOUT
- INTEGRATED KITCHEN APPLIANCES
- OPEN-PLAN LIVING
- SPACIOUS PRIVATE TERRACE
- CLOSE PROXIMITY TO SHOPPING, DINING, AND ENTERTAINMENT
- EXCELLENT CONNECTIVITY ACROSS LONDON
- OFFERED FURNISHED
- AVAILABLE END-MAY

For further information contact:

Lettings SB, 234 Uxbridge Road, Shepherds Bush, London, W12 7JD

Tel: 0208 740 8740 Email: [enquiries@jorgensenturner.com](mailto:enquiries@jorgensenturner.com)

<https://www.jorgensenturner.com/>

### Disclaimer

These particulars, whilst believed to be accurate are set out as a general outline only for guidance and do not constitute any part of an offer or contract. Intending purchasers should not rely on them as statements of representation of fact, but must satisfy themselves by inspection or otherwise as to their accuracy. No person in this firm's employment has the authority to make or give any representation or warranty in respect of the property.

