



Fiddlers Green, Felindre, Knighton, LD7 1YT  
Offers Over £500,000

COBB  
AMOS

SALES | LETTINGS | AUCTIONS  
LAND & NEW HOMES



# Fiddlers Green, Felindre Knighton

A beautifully situated detached three/quarter bedroom property set in a stunning rural location on the outskirts of the village of Felindre, with no immediate near neighbours. This dormer bungalow is set within 4.22 acres of land with an American barn providing stabling, tack room and wash-down bay. There is a double garage/workshop and other outbuildings and the property would be ideal for horses or other livestock.

## FEATURES

- Detached rural home in the Welsh Borders
- Three/quarter double bedrooms
- 4.22 acres grounds
- American style barn with four looseboxes and tack room
- Rural position in the upper Teme Valley
- Stunning views over the surrounding countryside

### Material Information

**Offers Over** £500,000

**Tenure:** Freehold

**Local Authority:** Powys

**Council Tax:** F

**EPC:** F (26)

For more material information visit [www.cobbamos.com](http://www.cobbamos.com)

| Score | Energy rating | Current | Potential |
|-------|---------------|---------|-----------|
| 92+   | A             |         |           |
| 81-91 | B             |         | 84 B      |
| 69-80 | C             |         |           |
| 55-68 | D             |         |           |
| 39-54 | E             |         |           |
| 21-38 | F             | 26 F    |           |
| 1-20  | G             |         |           |

## Introduction

The accommodation comprises: entrance hall, dining room (currently used as a study), inner hall, sitting room, kitchen/diner, utility room, three ground floor double bedrooms, family bathroom, first floor hobbies room/fourth bedroom, walk-in loft rooms. There is an American-style barn with stabling; double garage, and other outbuildings. Set in 4.22 acres with two paddocks and a hill meadow, viewing is recommended to appreciate all this property has to offer.

## Property Description

The front door opens into the entrance hall with space for coats and shoes. To the left is the dining room (currently used as a study) with patio doors leading to the terrace and gardens. Doors from the hall lead to the inner hall giving access to the primary rooms and bedrooms. The living room has a large south-facing picture window, feature brick fireplace with inset wood burning stove set on a slate hearth with fitted shelving to one side. The kitchen/dining room is fitted with wall and base units, stainless steel sink, fitted electric cooker and hob, oil fired Rayburn cooking range providing heating for domestic water and central heating, integral fridge, dining area for table and chairs. A part-glazed door opens onto the utility room with deep glazed sink, plumbing for washing machine and space for a freezer, boots and coats.

There are three ground-floor double bedrooms. The main bedroom has a

recessed double wardrobe, an en suite room with WC, basin, heated towel rail and plumbing for a shower cubicle. The family bathroom has a white suite comprising panelled bath, low level flush WC, pedestal wash basin, tiled walls to dado height and recessed shower cubicle. From the inner hall a staircase rises to the upper floor comprising a hobby room/fourth bedroom with Velux roof window and doors to the boarded loft storage areas, the largest of which has a built in workbench.

## Outbuildings

The American style timber barn, accessed by a spur drive off the main drive and with hard-standing for a horsebox, has double doors at each end, a concrete base and comprises four looseboxes, tack room and wash-down bay each measuring 3.6m x 3.6m, with lighting, power, water and drainage. The detached double garage/workshop measures approx. 7.5m x 4.9m with up and over door, side pedestrian door, power and lighting, with outside tap and adjacent space for greenhouse. There is a garden/log store approx. 4.9m x 2.7m built on a concrete base and divided into two sections, and a timber summerhouse.

## Land

The main driveway is lined by trees with a small stream to the right-hand side. The lawned gardens stocked with perennials, shrubs and trees surround the house on three sides, with hard-standing for several vehicles on the fourth side in front





of the garage, and a paved terrace to the east and south sides of the property. There are two paddocks accessed from the barn and gardens, and a sloping wild flower meadow to the west.

## Location

Situated on a 'no through' road in a rural position on the outskirts of Felindre and surrounded by outstanding countryside but with easy access to the B4355, Fiddlers Green is approximately 10 miles from Newtown and 12 miles from Knighton, each with a wide range of shops and amenities.

## Services

Mains electricity, septic tank drainage, private water supply from a borehole, BT phone, broadband via satellite.

## Agents Notes

In accordance with The Money Laundering Regulations 2007, Cobb Amos are required to carry out customer due diligence checks by identifying the customer and verifying the customer's identity on the basis of documents, data or information obtained from a reliable and independent source. At the point of your offer being verbally accepted, you agree to paying a non-refundable fee of £10 +VAT (£12.00 inc. VAT) per purchaser in order for us to carry out our due diligence.

## DIRECTIONS

From our office in Knighton, take the B4355 towards Newtown. 4.5 miles past Felindre, take the lane on the left signposted Llanbadarn Fynydd, continue into the 'no through' road and the property is the first on the right. WhatThreeWords: regulates.meant.thinnest





**Ground Floor**  
Approx. 230.5 sq. metres (2480.7 sq. feet)

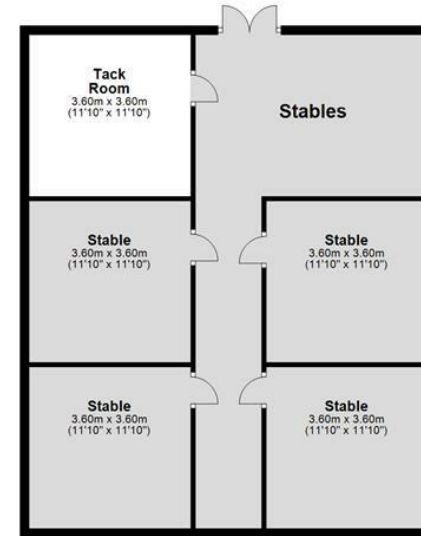

**First Floor**  
Approx. 66.9 sq. metres (719.6 sq. feet)

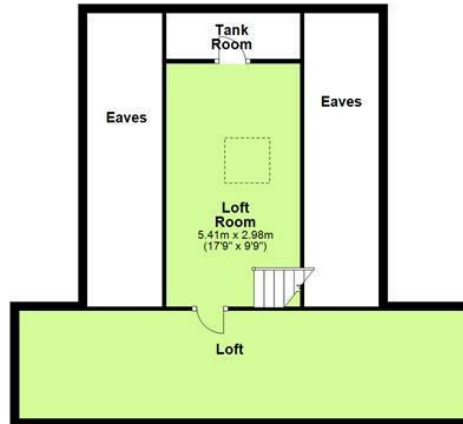

Total area: approx. 297.3 sq. metres (3200.3 sq. feet)

For illustration only - Not guaranteed to scale  
Plan produced using PlanUp.

**Fiddlers Green**

*We have prepared these property particulars as a general guide to a broad description of the property. They are not intended to constitute part of an offer or contract. We have not carried out a structural survey and the services, appliances and specific fittings have not been tested. All photographs, measurements, floorplans and distances referred to are given as a guide only and should not be relied upon for the purchase of carpets or any other fixtures or fittings. Lease details, service charges and ground rent (where applicable) and council tax are given as a guide only and should be checked and confirmed by your Solicitor prior to exchange of contracts. The copyright of all details, photographs and floorplans remain exclusive to Cobb Amos.*

# COBB AMOS

SALES | LETTINGS | AUCTIONS  
LAND & NEW HOMES

## Hereford

Telephone: 01432 266007

hereford@cobbamos.com

14 King Street, Hereford, HR4 9BW

## Leominster

Telephone: 01568 610310

leominster@cobbamos.com

2 Broad Street, Leominster, HR6 8BS

## Ludlow

Telephone: 01584 874450

ludlow@cobbamos.com

5 High Street, Ludlow, SY8 1BS

## Land & New Homes

Telephone: 01584 874450

landandnewhomes@cobbamos.com

5 High Street, Ludlow, SY8 1BS

## Knighton

Telephone: 01547 529907

knighton@cobbamos.com

22 Broad Street, Knighton, LD7 1BL

## Lettings

Telephone: 01432 266007

lettings@cobbamos.com

14 King Street, Hereford, HR4 9BW

## Head Office

Telephone: 01568 605300

hello@cobbamos.com    accounts@cobbamos.com

First Floor Executive Suite, Easters Court, Leominster, HR6 0DE