

CHESTNUT CRESCENT

CATTERICK GARRISON

LOVE PROPERTY.♥

LOVE THE JOURNEY



Welcome Home...

Chestnut Crescent is in a great location close by to local shops, schools and a short drive to the A1 for transport links. It's the ideal home for a busy family and whilst you are based in the heart of the Garrison, you still feel quietly tucked away once inside.

Pull onto the large driveway, which can host multiple vehicles and takes you right up to the front door. On arrival, you can slip off your coat and shoes and tidy them away in the large and useful storage cupboard in the hallway.

To your left head into the kitchen/dining space kept nice and neutral. In here there's an integral oven and hob, as well as space for your freestanding fridge/freezer and washing machine. There's space in here for a dining set too, sat just away from the patio doors to the back garden.

Through to the living room and you can enjoy putting your feet up on an evening. There's ample space for your settee and coffee table, and you'll find an electric fire in here to set the atmosphere on an evening.



Head upstairs...

Take the stairs from your living room to the upstairs of the house where you will find two double bedrooms, so the choice is yours! The rear is the room with the garden outlook where the light will stream through on a summer's morning. Your front bedroom is the ideal second room for the youngest in the family, or a guest room.

Your neutral bathroom suite includes a bath with overhead shower, giving you both options to choose from.



Outside...

Set out into your back garden, this lovely, tiered space comes with a patio area, well maintained lawn, and woodchip section at the back where the shed is housed. It's fully enclosed keeping it nice and secure and private.

Finer Details...

Postcode: DL9 4SE

Freehold

Council Tax Band:

EPC Rating:

Gas Central Heating (Gas Safety valid until Feb 2026)

EICR Valid until Nov 25



Chestnut Crescent Catterick Garrison

Total area: approx. 59.9 sq. metres (645.0 sq. feet)

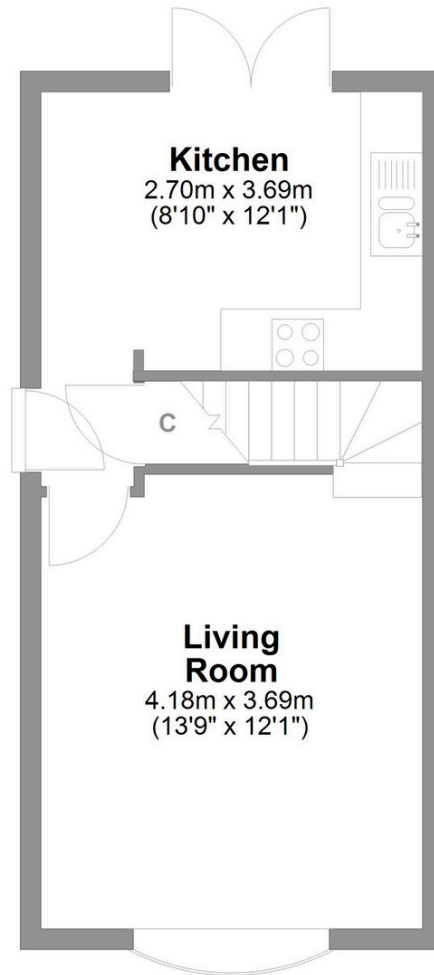

Ground Floor
Approx. 30.1 sq. metres (324.3 sq. feet)

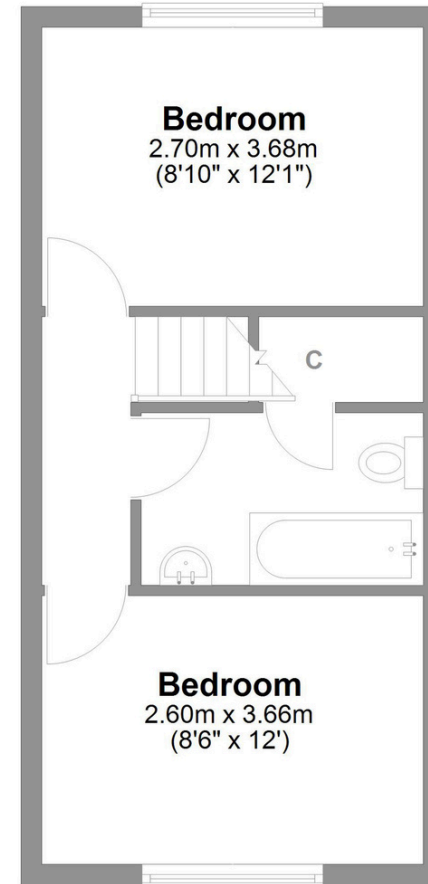

First Floor
Approx. 29.8 sq. metres (320.7 sq. feet)

LOVE PROPERTY

Whilst every attempt has been made to ensure the accuracy of the floorplans contained here, measurements of doors, windows, rooms and any other items are approximate and no responsibility is taken for any error, omission or mis-statement. This plan is not drawn to scale and is for illustrative purposes only & should be used as such by any prospective purchaser. Created especially for Love Property by Vue3sixty Ltd