

CHESTNUT CRESCENT

CATTERICK GARRISON

LOVE PROPERTY.♥

LOVE THE JOURNEY



Welcome home...

This studio apartment is found in Catterick Garrison offering a functional living space that's perfect for someone looking for a lock up and leave.

As you step inside, you'll find the lounge/bedroom area, which is a versatile space designed to cater to both your living and sleeping needs. There's space for a comfy sofa and a bed, with enough room left over for some storage solutions or a small desk if you work from home.

Adjacent to the main room, the kitchen is a practical area where you can easily prepare meals.

The bathroom makes efficient use of the space. It features a shower, toilet, and a sink with a neat, tiled backsplash.

One of the features of this studio is the dressing room, a rare find in apartments of this size. It provides extra storage for your clothes and personal items, helping to keep the main living area clutter-free.

Whether you're a first-time buyer, looking to downsize, or searching for an investment opportunity, this apartment is well worth considering.



Finer Details...

Postcode: DL9 4SF

Leasehold

Council Tax Band: A

EPC Rating: D

Fees: approx. £63 per 6 months in advance approx. £8 per quarter communal electricity

Allocated Parking

Electric Heating- Valid EICR until Dec 25

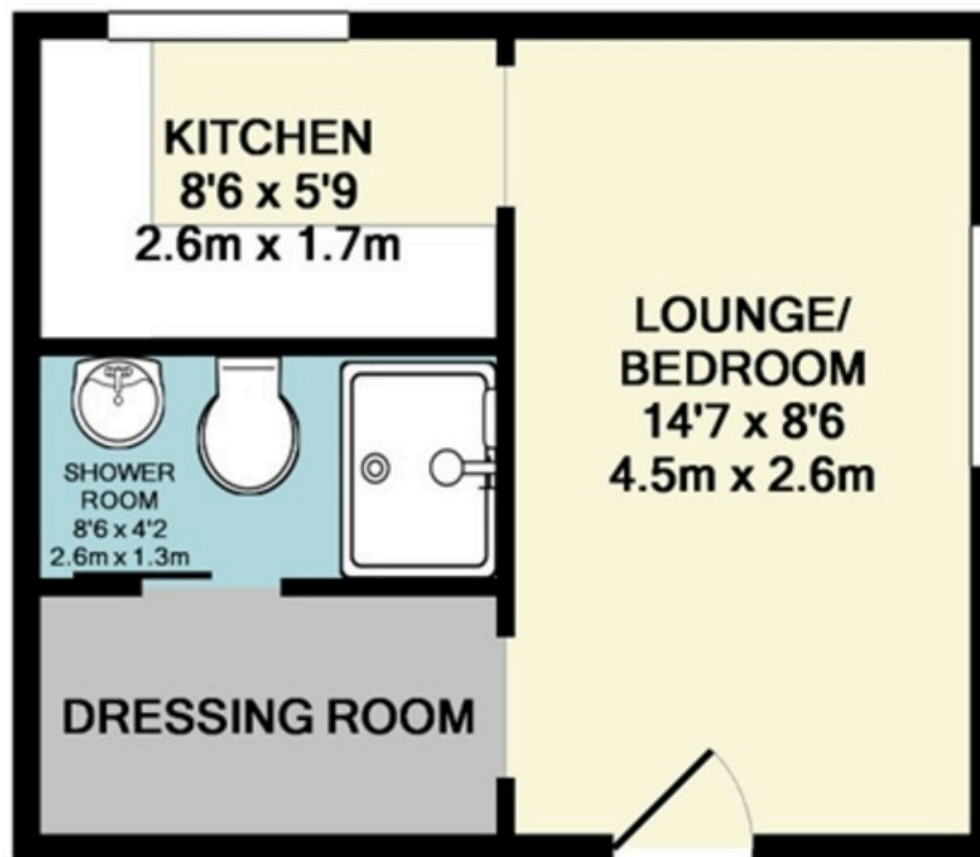

TOTAL APPROX. FLOOR AREA 248 SQ.FT. (23.1 SQ.M.)

Whilst every attempt has been made to ensure the accuracy of the floor plan contained here, measurements of doors, windows, rooms and any other items are approximate and no responsibility is taken for any error, omission, or mis-statement. This plan is for illustrative purposes only and should be used as such by any prospective purchaser. The services, systems and appliances shown have not been tested and no guarantee as to their operability or efficiency can be given

Made with Metropix ©2016