

BLENHEIM CLOSE

SCORTON

LOVE PROPERTY. 

LOVE THE JOURNEY



Welcome home...

Welcome to this 3-bedroom semi-detached home located in the popular village of Scorton. This delightful property offers a comfortable and inviting living space, perfect for first time buyers, downsizers, or those looking to put their own stamp on a property.

Upon entering, you are greeted by a spacious living room measuring 4.44m x 4.52m (14'7" x 14'10"). The room is filled with natural light, providing a warm and welcoming atmosphere. The living room leads to a modern kitchen and dining area.

The kitchen has plenty of space for appliances and there is ample counter space, making meal preparation a breeze. The adjoining dining area opens up to the rear garden through sliding glass doors, perfect for indoor-outdoor living and entertaining.



First Floor...

The first floor comprises three well-proportioned bedrooms. The main bedroom features built-in wardrobes providing ample storage space. The second bedroom is spacious and versatile, suitable for a guest room or home office. The third bedroom is ideal for a child's room or study. The family bathroom is fitted with a bath and overhead shower as well as a WC and sink.





Step Outside...

The property has a private rear garden, perfect for relaxing and enjoying the outdoors. The garden features a lawn and a patio area, ideal for summer barbecues or a morning coffee.

At the front of the house, there is space to park and a garage for additional storage or vehicle accommodation.

Finer Details

Postcode: DL10 6TE

Freehold

Council Tax Band: C

EPC Rating: C

Gas central heating

Valid EICR until April 2026

Blenheim Close Scorton

Total area: approx. 70.5 sq. metres (759.2 sq. feet)

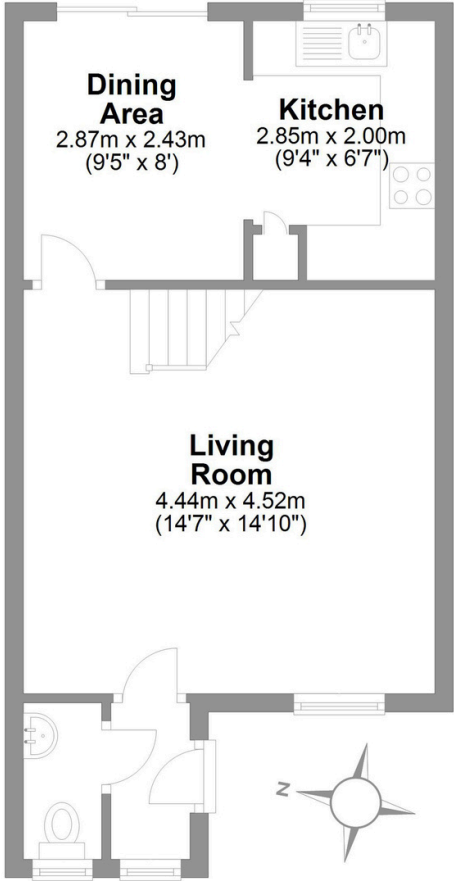

Ground Floor
Approx. 36.8 sq. metres (396.2 sq. feet)

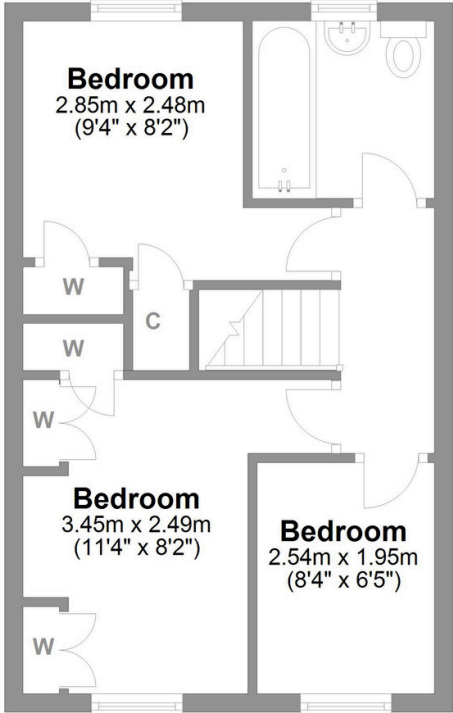

First Floor
Approx. 33.7 sq. metres (363.0 sq. feet)

LOVE PROPERTY

Whilst every attempt has been made to ensure the accuracy of the floorplans contained here, measurements of doors, windows, rooms and any other items are approximate and no responsibility is taken for any error, omission or mis-statement. This plan is not drawn to scale and is for illustrative purposes only & should be used as such by any prospective purchaser. Created especially for Love Property by Vue3sixty Ltd