

ALBERMARLE DRIVE

CATTERICK GARRISON

LOVE PROPERTY. 

LOVE THE JOURNEY



Welcome home...

This three bedroom, semi-detached home can be found on Albermarle Drive, Catterick Garrison, close by to local shops, schools and eateries. There's a spacious driveway where you can park multiple cars, as well as a front lawned garden.

Step inside to a convenient hallway, perfect for kicking off your shoes before entering the living room. The spacious living room easily accommodates two sofas, ideally placed in front of the fireplace.

The kitchen, located at the back of the house, features white cabinets with plenty of space for your ingredients. There's space for your oven, dishwasher, washing machine and fridge/freezer. The kitchen opens out to your large conservatory, an ideal spot for your dining set or a couple of couches.



Head upstairs...

Upstairs, there are three bedrooms. The main bedroom, located at the front of the house, comfortably accommodates a double bed, side tables, and your wardrobes!

The two additional bedrooms are ideal for the rest of the family, offering space for double beds too. Both rooms feature ample cupboard space for storage.

The main bathroom features a bath with an overhead rainfall shower, perfect for long evening soaks or a quick freshen up!





Breath of fresh air...

Your back garden is a low maintenance haven, with patio leading from the conservatory to the back fence. This space also has a large wooden garage ideal for a smaller car, bikes, home gym or workshop, the options are all yours. To the rear of the garden there is a gate which leads out to the fields behind, ideal for those who have pets starting your walk moments from your home.



Finer Details...

Postcode: DL9 4DU
Freehold
Council Tax Band: B
EPC Rating: D
Gas Central Heating

Albermale Drive Catterick Garrison

Total area: approx. 91.0 sq. metres (979.8 sq. feet)

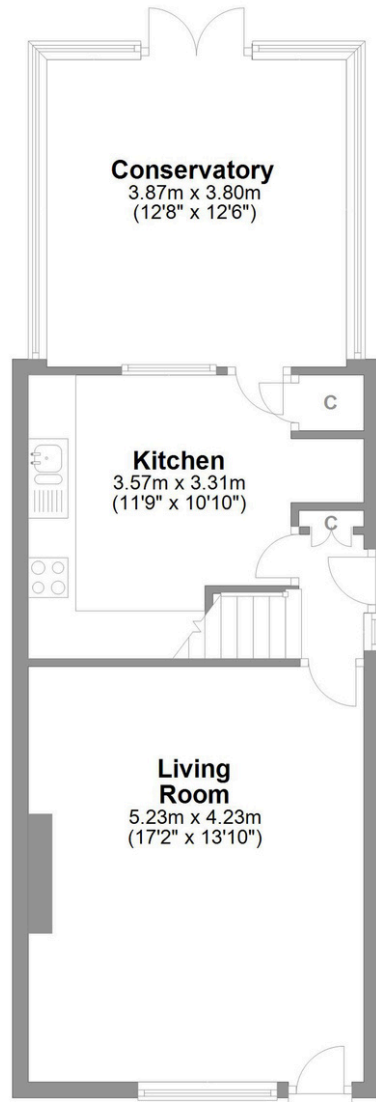

Ground Floor

Approx. 52.7 sq. metres (567.3 sq. feet)

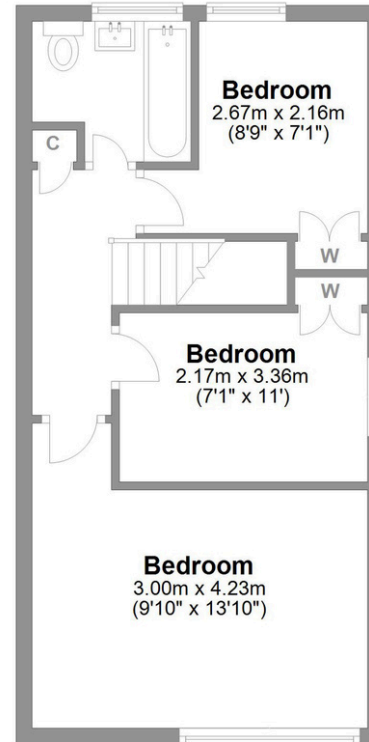

First Floor

Approx. 38.3 sq. metres (412.5 sq. feet)



LOVE PROPERTY.

Whilst every attempt has been made to ensure the accuracy of the floorplans contained here, measurements of doors, windows, rooms and any other items are approximate and no responsibility is taken for any error, omission or mis-statement. This plan is not drawn to scale and is for illustrative purposes only & should be used as such by any prospective purchaser.

Created especially for Love Property by Vue3sixty Ltd