

KINGFISHER DRIVE

HIPSWELL

LOVE PROPERTY.♡

LOVE THE JOURNEY



Living space

This lovely flat is found in Hipswell, tucked away on a cul de sac. Here you're within walking distance to shops, transport links and much more, ideal for those who need all the necessities at their doorstep.

Arrive home and park up in your allocated space before heading inside. A set of stairs take you up to your front door, inside a large hallway leads you to each room. Straight ahead and you're into the living room where you'll find ample space for your large sofa, ideal for enjoying cosy nights in. There's also space for you to place a small dining table in here too if you wish.

Your kitchen is just off the living room and inside find wood style cabinets, an integrated oven and hob plus space for your washing machine. The kitchen is open to the living room, so perfect if you have guests around, you can keep the conversation going whilst preparing the tea!



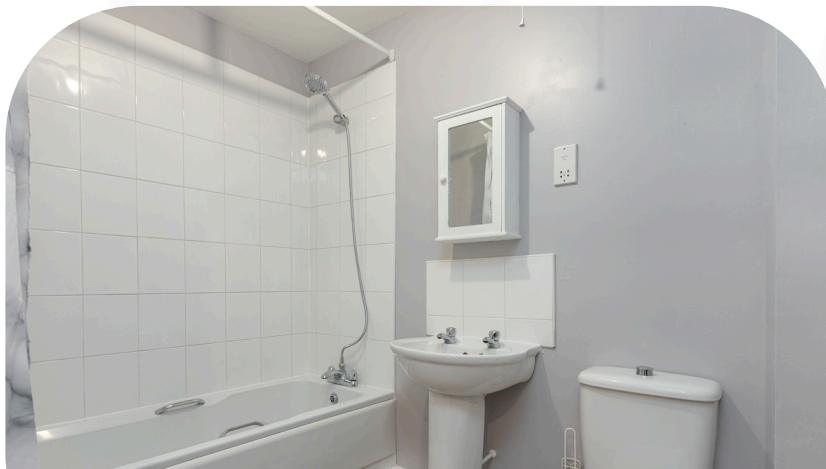

Explore further...

Now to the bedrooms, back down the hallway to the end where you have choice of two rooms. The main bedroom is off to the left- this double room offers space for your double bed, side tables and wardrobes. The second room is a large single and in here you'll find room for your bed, wardrobes, and a side table, great for the youngest in the household, or as a guest room.

Your bathroom features a built-in bath with an overhead shower, offering you the best of both worlds.

Finer Details

- Postcode: DL9 4DP
- Leasehold
- Council Tax Band: A
- EPC Rating: C
- Years left on lease: 981
- Ground rent and Maintenance fees: £900 Per Yr

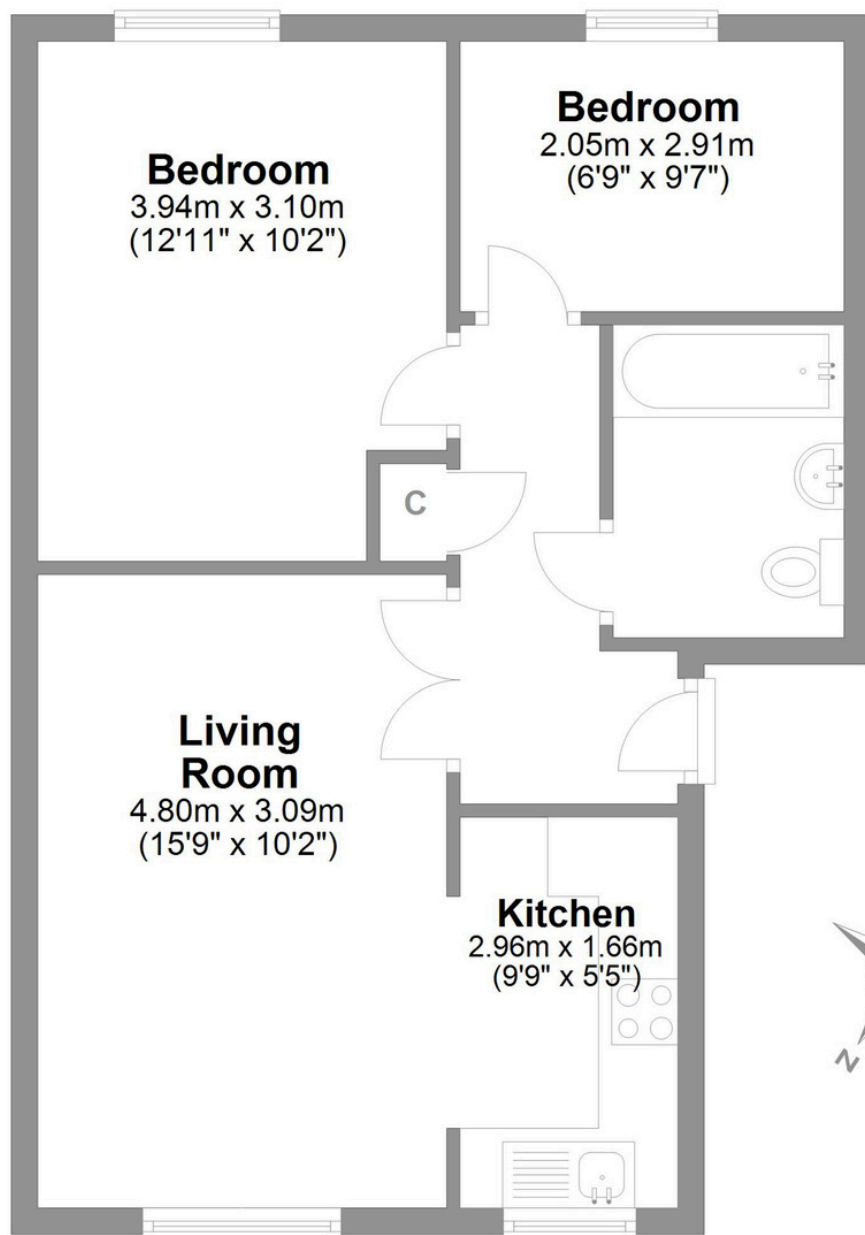

**Kingfisher Drive
Catterick Garrison**

Total area: approx. 48.6 sq. metres (522.6 sq. feet)

LOVE PROPERTY.♥

Whilst every attempt has been made to ensure the accuracy of the floorplans contained here, measurements of doors, windows, rooms and any other items are approximate and no responsibility is taken for any error, omission or mis-statement. This plan is not drawn to scale and is for illustrative purposes only & should be used as such by any prospective purchaser.

Created especially for Love Property by Vue3sixty Ltd