



Lesbourne Road, Reigate

£1,300 Per Month





“

"We've been at Fonteyn Court for years and loved the area and neighbours in this small development. The benefits of this property were clear when we moved in, just a stones throw from Priory Park has offered outdoor space when needed, a car parking space in Reigate has been invaluable, being the top floor has meant zero noise from neighbours, and having a separate kitchen and living room has allowed us a second bedroom when friends or family stay. It's proved an excellent home for us."

”



This purpose-built apartment has a secure entry phone system and gated, underground allocated parking, on a sought-after road. In a great location, you're just seconds away Reigate high street!

Heading through the main front door into the well-maintained communal hallway and on the ground floor, you make your way up to the second floor to this one-bedroom apartment. Once inside, a welcoming entrance hall opens into spacious and bright rooms.

The large living room has French doors opening to a Juliette balcony and overlooking the neat communal gardens. During those warmer months you can lay out on the lawn with a good book enjoying a glass of something refreshing as you soak up some summer sun.

The open plan kitchen/dining room also has French doors leading to the Juliette balcony, a dream when getting hot and bothered cooking up something delicious.

The family bathroom includes a large bathtub and shelving to keep things neat. The large double bedroom is an impressive size, with a skylight and room to add in some additional furnishings.

Lesbourne Road has a selection of unique and individually owned shops and eateries. Waking up on a Sunday morning and popping to the Blue Cow butchers for some fresh bacon and eggs to cook up a delicious breakfast is a real treat, in the evenings if you can't be bothered to cook, then head across the road to Sea Salt Fish & Chip Shop.

The Priory Park is beautiful for summer soirees, family outings and if you have children, there are some fantastic schools in the local area to choose from.



Need to know

- Purpose-built apartment in secure development with gated, underground parking
- Entry phone system and controlled access for peace of mind
- Generous one-bedroom layout on the second floor
- Bright living room with French doors opening to a Juliette balcony
- Open-plan kitchen / dining area also with balcony access
- Spacious double bedroom with skylight and room for additional furnishings
- Family bathroom with full-size bath and built-in shelving
- Overlooks well-maintained communal gardens and shared lawn space
- Superb location — just seconds from Reigate High Street and local amenities
- Close to Priory Park, independent shops, eateries, and desirable schools

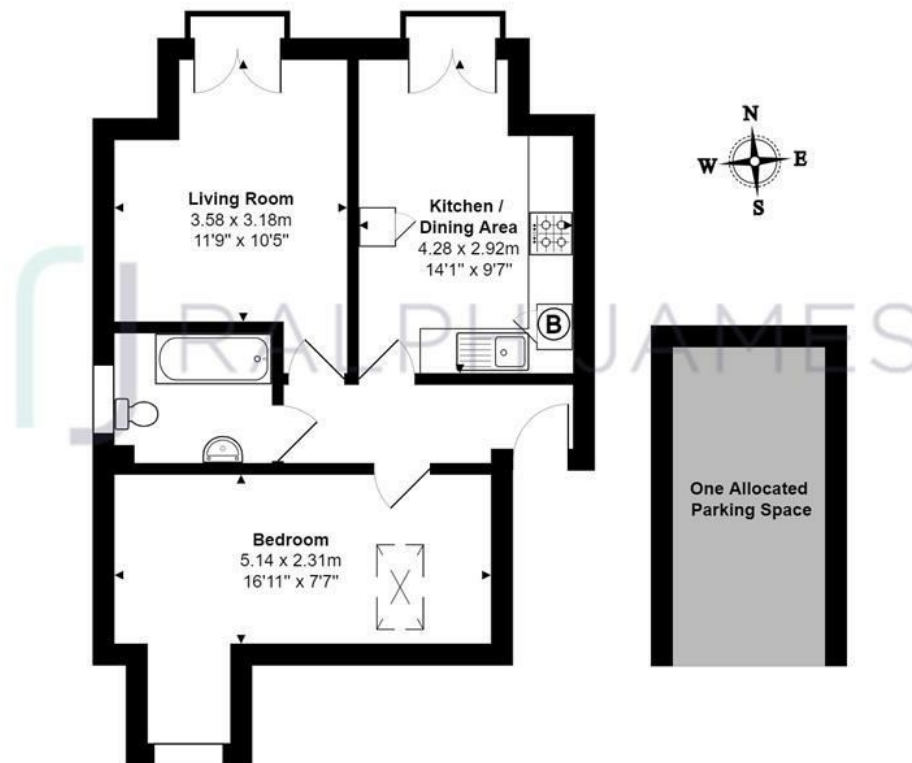

Second Floor Flat

Fonteyn Court, Lesbourne Road, Reigate

Total Area: 46.6 m² ... 501 ft² (excluding one allocated parking space)

FOR ILLUSTRATIVE PURPOSES ONLY.

Whilst every attempt has been made to ensure the accuracy of the floor plan shown, all measurements, positioning, fixtures, features, fittings and any other data shown are an approximate interpretation for illustrative purposes only and are not to scale.

No responsibility is taken for any error, omission, miss-statement or use of data shown.

The above statement applies to both 'Still Moving London LTD' and the Company or individual displaying this floor plan.

Unauthorised reproduction prohibited.

© Still Moving London LTD (www.stillmoving.london)

 RALPH JAMES

Interested?

reigate@ralphjames.co.uk
01737 333677

1

ralphjames.co.uk