



83a Bell Street, Reigate

£395,000





“

A bespoke, mews style development of six luxury apartments located in central Reigate just a stones throw from Priory Park. A vast array of shops, restaurants and coffee shops right on the doorstep and a short walk to Reigate station.

”



This exclusive development of six brand new apartments, is tucked away on Bell Street, opposite the award winning Priory Park.

Built by Trinity Square Developments in a mews style, each property has it's own front door. The brick facade is nestled amongst the surrounding trees and the landscaping complements the brickwork beautifully.

This two bedroom apartment is accessed through a private front door, where your stairs lead up to the first floor. There are leafy views to the rear from the kitchen living space. The main bedroom is a good size double room and the second bedroom is a good size single or excellent home office.

The apartments have been fitted with stylish, two tone kitchens and quartz worktops as well as complementary tiled splashbacks. The high quality luxury vinyl flooring throughout the hallway and living space is laid in a chevron style and there is a tiled floor in the bathroom.



## Need to know

- Located in the heart of Reigate town centre, opposite Priory Park
- Walking distance to Reigate train station, approximately half a mile away
- Unique mews style development of only six apartments, all with their own entrances
- Sleek, modern kitchen designs with two tone units, quartz worktops with built in fridge freezer, dishwasher, oven and hob
- Separate utility cupboard with washing machine and storage space
- Bathrooms with terrazzo style tiling, bath with shower over and shower screen and vanity basin unit
- Underfloor heating throughout the apartments
- High quality, luxury vinyl flooring to hallway and living areas and carpet in bedrooms
- Designed and built by Trinity Square Developments, finalist for housebuilder of the year.
- Share of Freehold

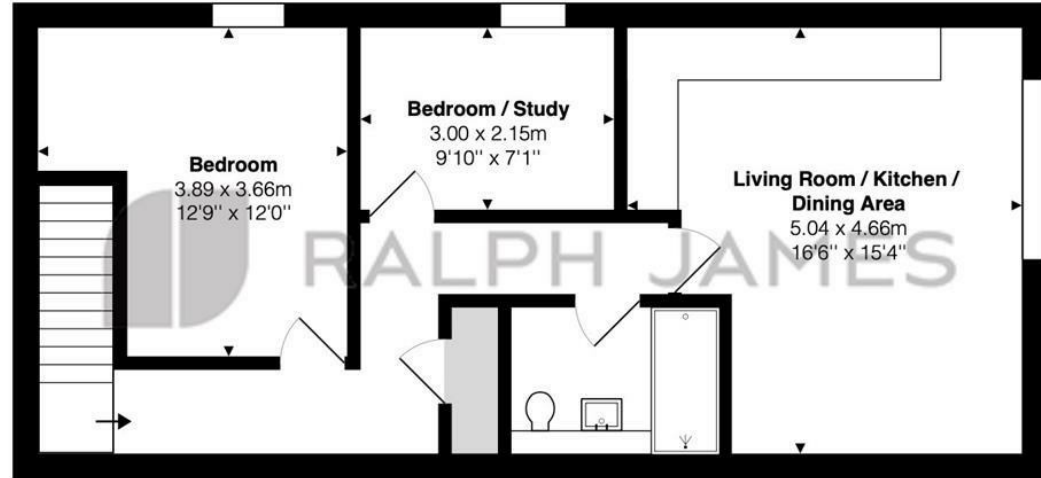

### First Floor Flat

Bell Street, Reigate

Total Area: 58.6 m<sup>2</sup> ... 631 ft<sup>2</sup>

FOR ILLUSTRATIVE PURPOSES ONLY.

Whilst every attempt has been made to ensure the accuracy of the floor plan shown, all measurements, positioning, fixtures, features, fittings and any other data shown are an approximate interpretation for illustrative purposes only and are not to scale.

No responsibility is taken for any error, omission, miss-statement or use of data shown.

The above statement applies to both 'Still Moving London LTD' and the Company or individual displaying this floor plan.

Unauthorised reproduction prohibited.

© Still Moving London LTD (www.stillmoving.london)



## Interested?

reigate@ralphjames.co.uk  
01737 333677

1

ralphjames.co.uk