



Oakhill Road, Reigate

£750,000





“

This stunning period home is ideal for anyone looking for a little more space, with three double bedrooms as well as a useful open plan office space it ticks all the boxes for a growing family.

”



Located in a popular residential street, within walking distance of Reigate town centre, this gorgeous property is full of character. Within just a few minutes walk you will find the local shops at Lesbourne Road which include a butchers, fantastic fish & chip shop, Cypriot restaurant, wine merchants and a bakery to name a few.

The property has a warm and welcoming feeling with neutral tones on the ground floor. The living room is flooded with natural light through the large bay window and there is an original feature fireplace. The dining room is a good size and has French doors leading to the rear garden. The space is open plan to the kitchen, allowing you to chat with the family or your dinner guests.

Upstairs there are three double bedrooms laid out over two floors. The family bathroom has been sympathetically updated and includes a bath and separate shower cubicle. As well as this there is a handy downstairs cloakroom and toilet.

Outside there is a modern garden room which has great flexibility and could be a home office, teenager den or gym!

Need to know

- Gorgeous three bedroom character property, located close to Lesbourne Road and Priory Park
- Walking distance to the "Outstanding" Reigate Parish and Reigate Priory schools
- Character features throughout including fireplaces and sash windows
- Bright, spacious living room with bay window and feature fireplace
- Open plan kitchen dining room with French doors to garden
- Modern garden room with multi purpose use as a home office or gym
- Westerly facing rear garden
- Modern family bathroom with separate shower and useful downstairs cloakroom
- Lovely location with a great sense of community

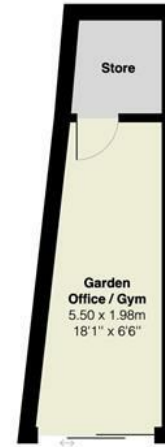

Oakhill Road, Reigate

Total Area: 117.5 m² ... 1265 ft² (excluding store, garden office / gym)

FOR ILLUSTRATIVE PURPOSES ONLY.

Whilst every attempt has been made to ensure the accuracy of the floor plan shown, all measurements, positioning, fixtures, features, fittings and any other data shown are an approximate interpretation for illustrative purposes only and are not to scale.

No responsibility is taken for any error, omission, miss-statement or use of data shown.

The above statement applies to both 'Still Moving London LTD' and the Company or individual displaying this floor plan.

Unauthorised reproduction prohibited.

© Still Moving London LTD (www.stillmoving.london)



Interested?

reigate@ralphjames.co.uk
01737 333677

ralphjames.co.uk