



# Oakhill Road, Reigate

Offers over £750,000





“

Located in one of Reigate's most popular roads, this home has been lovingly updated and styled by the current owners. The garden is a peaceful haven to relax and enjoy, perfect for a glass of something cold with friends.

”



This gorgeous period property is located a short walk to Reigate town centre and Priory Park. Forming part of the iconic Covent Garden terrace this lovely end terrace home exudes charm and character. Beautifully decorated and styled throughout, it feels homely, welcoming and ready to move into.

The lounge has a log burner for those cosy nights in and built in storage to the alcoves to keep it free of clutter. The open plan kitchen living space opens onto the terraced rear garden which has been landscaped to make the most of all the space. The modern garden building would make a great home office or gym as it is currently used and the seating area is perfect for BBQ's.

Upstairs the neutral tones provide a sense of space and the modern bathroom adds an element of luxury. On the second floor there is an ideal nursery, office or could perhaps be a walk in dressing room for the master bedroom! There is also a second shower room on this floor, great for those busy mornings.



# Need to know

- Victorian, end terrace home, full of character
- Beautiful South West facing, landscaped rear garden with built in seating area, home office/ gym
- Walking distance to local shops and cafe on Lesbourne Road, Priory Park and Reigate High Street
- Three double bedrooms plus a nursery/ office
- Close to Reigate Parish school, Reigate Priory school and Reigate school
- Open plan kitchen, living space as well as separate cosy lounge
- Neutrally decorated and beautifully styled throughout
- Contemporary bathroom with bath and shower as well as a separate shower room
- EPC Rating - D
- Council Tax Band - D

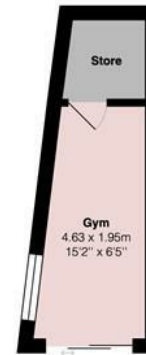

Oakhill Road, Reigate  
Total Area: 142.1 m<sup>2</sup> ... 1529 ft<sup>2</sup>

FOR ILLUSTRATIVE PURPOSES ONLY.

Whilst every attempt has been made to ensure the accuracy of the floor plan shown, all measurements, positioning, fixtures, features, fittings and any other data shown are an approximate interpretation for illustrative purposes only and are not to scale.

No responsibility is taken for any error, omission, miss-statement or use of data shown.

The above statement applies to both 'Still Moving London LTD' and the Company or individual displaying this floor plan.

Unauthorised reproduction prohibited.

© Still Moving London LTD (www.stillmoving.london)

 RALPH JAMES



## Interested?

reigate@ralphjames.co.uk  
01737 333677

ralphjames.co.uk