

Parkheath

Sold on Service

**Wedderburn Road NW3
£3,100 PCM (£715 per week) - Camden Band F**



Immaculately presented 2 double bedroom apartment

Communal gardens and off street parking

Modern kitchen with all appliances

Close to Belsize Park and Hampstead amenities

Ground floor in well maintained block

Reception with bay window

Luxurious bathroom

EPC: Rating D, Council Tax: Camden band F

Belsize Park Office 020 7431 3104

Belsize Court, NW3
Approx. Gross Internal Area
770 Sq Ft - 71.53 Sq M

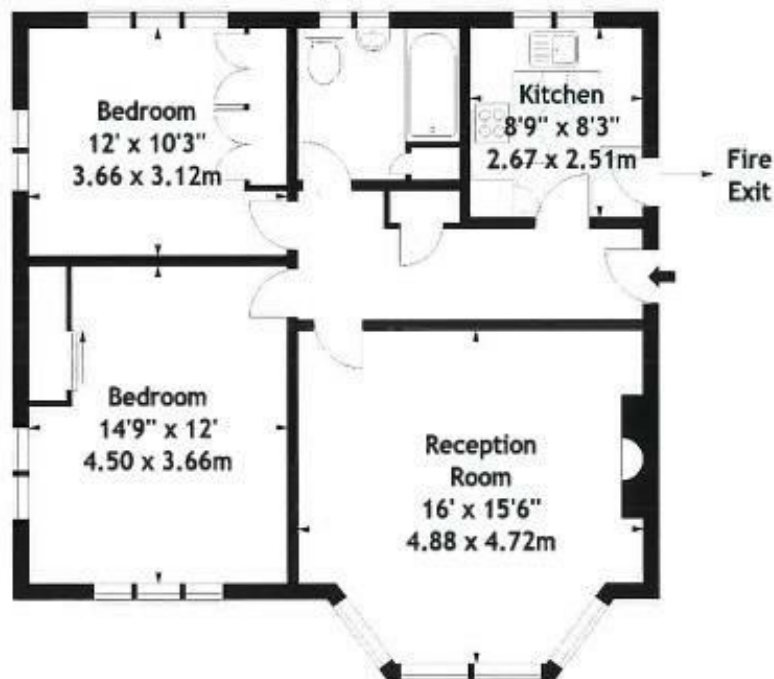

Ground Floor

Measured in accordance with RICS guidelines. Every attempt is made to ensure accuracy, however all measurements are approximate. This floor plan is for illustrative purposes only and is not to scale.
© Datagraphy Ltd 2013
Photographs * Floorplans * Virtual Tours
Tel: 0845 643 4401 www.datagraphy.com

The particulars do not constitute part of an offer or contract. The particulars, including text, photographs and plans, are for the guidance only of prospective purchasers/tenants and must not be relied upon as statements of fact. The descriptions provided therein represent the opinion of the author and whilst given in good faith should not be construed as statements of fact. Nothing in these particulars shall be deemed a statement that the property is in good condition or otherwise or that any services or facilities are in good working order. All measurements are approximate.

The particulars do not constitute part of an offer or contract. The particulars, including text, photographs and plans, are for the guidance only of prospective purchasers/tenants and must not be relied upon as statements of fact. The descriptions provided therein represent the opinion of the author and whilst given in good faith should not be construed as statements of fact. Nothing in these particulars shall be deemed a statement that the property is in good condition or otherwise or that any services or facilities are in good working order. All measurements are approximate