



Upper Park Road NW3

Parkheath  
*Sold on Service*





## Upper Park Road, NW3 Asking Price £450,000 Share of Freehold

- A fine 1 bedroom split level apartment
- Over 400 sq ft on the first floor
- Bright 18ft reception with great ceiling height
- Attractive communal gardens
- Lift
- 11ft gallery bedroom with en suite bathroom
- Set in 1970`s purpose built block
- Share of freehold
- Minutes to Belsize Park underground
- South End Green and Hampstead Heath are a stroll away



**Parkheath**  
*Sold on Service*

**Camden Tax band D**

Belsize Park/Hampstead  
208 Haverstock Hill  
NW3 2AG  
Sales 020 7431 1234  
Lettings 020 7431 3104  
[nw3@parkheath.com](mailto:nw3@parkheath.com)

Kensal Rise  
54-56 Chamberlayne Rd  
NW10 3JH  
Tel 020 8960 4845  
[kensal@parkheath.com](mailto:kensal@parkheath.com)

South/West Hampstead  
192 West End Lane  
NW6 1SG  
Sales & Lettings  
Tel 020 7794 7111  
[192@parkheath.com](mailto:192@parkheath.com)

Property Management  
192 West End Lane  
NW6 1SG  
020 7433 6174  
[pm@parkheath.com](mailto:pm@parkheath.com)

[www.parkheath.com](http://www.parkheath.com)

**Parkstead Lodge Upper Park Road**

Approximate Gross Internal Area = 38 sq m / 405 sq ft

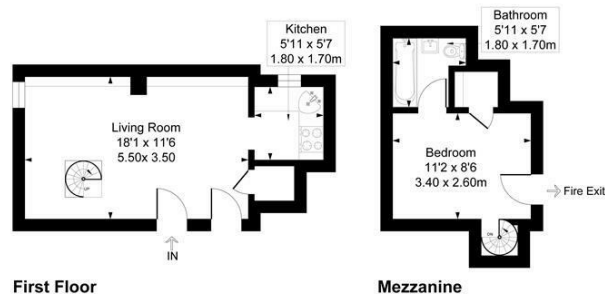

Measured in accordance with RICS guidelines. Every attempt is made to ensure accuracy  
However all measurements are approximate.  
The Floor plan is illustrative purposes Only and is not to scale  
ELLIE CLAIRE PHOTOGRAPHY LTD

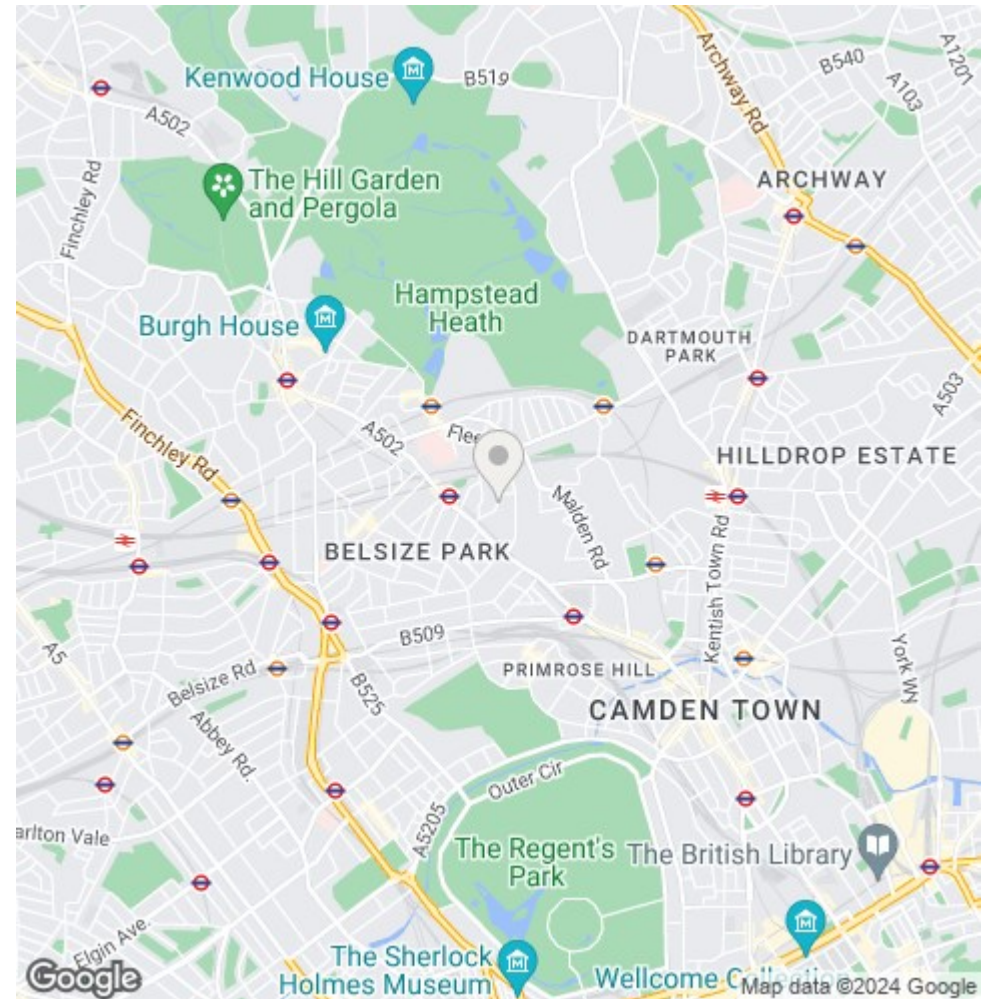

The particulars do not constitute part of an offer or contract. The particulars, including text, photographs and plans, are for the guidance only of prospective purchasers/tenants and must not be relied upon as statements of fact. The descriptions provided therein represent the opinion of the author and whilst given in good faith should not be construed as statements of fact. Nothing in these particulars shall be deemed a statement that the property is in good condition or otherwise or that any services or facilities are in good working order. All measurements are approximate