



Belsize Avenue NW3

Parkheath
Sold on Service



TUDOR CLOSE
Nos 1, 10 & 11

PRIVATE PROPERTY
No admittance
without the aid of a
pass

TUDOR CLOSE
Nos 1, 10 & 11
No admittance
without the aid of a
pass



Belsize Avenue, NW3
Asking Price £1,175,000

Leasehold

- A delightful 3 bedroom, 2 bathroom garden apartment
- Stylishly updated and maintained by the current vendors
- Contemporary style design
- Set in attractive end of terrace red brick conversion
- Gorgeous 24ft open plan reception with sleek kitchen with breakfast bar
- Sole use of pretty 14ft patio
- 13ft main bedroom with en suite bathroom plus flexible 14ft second bedroom
- Over 1000 sq ft on the entire lower floor
- Lease until June 2179
- Moments to Belsize Park amenities and Belsize Village, walking distance to Hampstead Heath and Primrose Hill

Belsize Park/Hampstead
 208 Haverstock Hill
 NW3 2AG
 Sales 020 7431 1234
 Lettings 020 7431 3104
nw3@parkheath.com

South/West Hampstead
 192 West End Lane
 NW6 1SG
 Sales & Lettings
 Tel 020 7794 7111
192@parkheath.com

Kensal Rise
 54-56 Chamberlayne Rd
 NW10 3JH
 Tel 020 8960 4845
kensal@parkheath.com

Property Management
 192 West End Lane
 NW6 1SG
 020 7433 6174
pm@parkheath.com

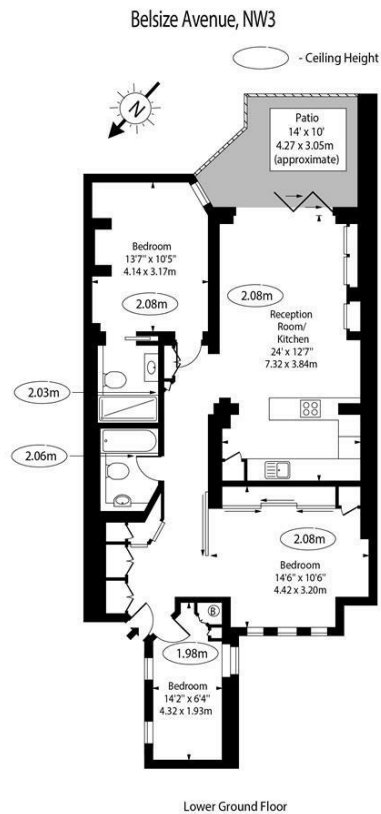

Approx Gross Internal Area 1001 Sq Ft - 92.99 Sq M

For Illustration Purposes Only - Not To Scale Floor Plan by www.epixandplans.com Ref: No.49672
 This floor plan should be used as a general outline for guidance only. Any intending purchaser or lessee should satisfy themselves by inspection, searches, enquiries and full survey as to the correctness of each statement. Any areas, measurements or distances quoted are approximate and should not be used to value a property or be the basis of any sale or let.

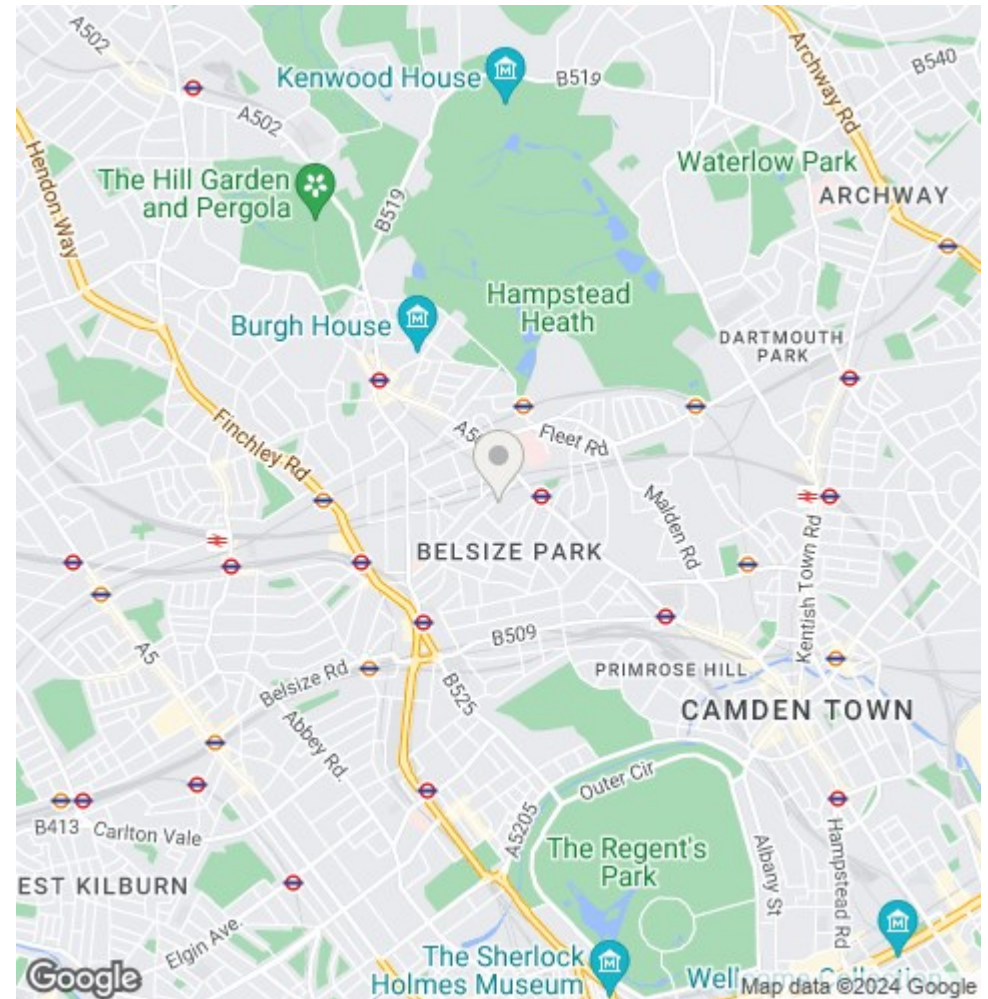

The particulars do not constitute part of an offer or contract. The particulars, including text, photographs and plans, are for the guidance only of prospective purchasers/tenants and must not be relied upon as statements of fact. The descriptions provided therein represent the opinion of the author and whilst given in good faith should not be construed as statements of fact. Nothing in these particulars shall be deemed a statement that the property is in good condition or otherwise or that any services or facilities are in good working order. All measurements are approximate