

Parkheath

Sold on Service

Tudor Close NW3

£2,383 Per Calendar Month (£550 per week)



Fantastic 2 double bedroom apartment
Porter and communal garden
Bathroom with separate wc

1st floor of well maintained purpose built block
Double reception room
Close to Belsize Park tube

Belsize Park Office 020 7431 1234

Tudor Close

Approximate Gross Internal Area = 80.8 sq m / 870 sq ft

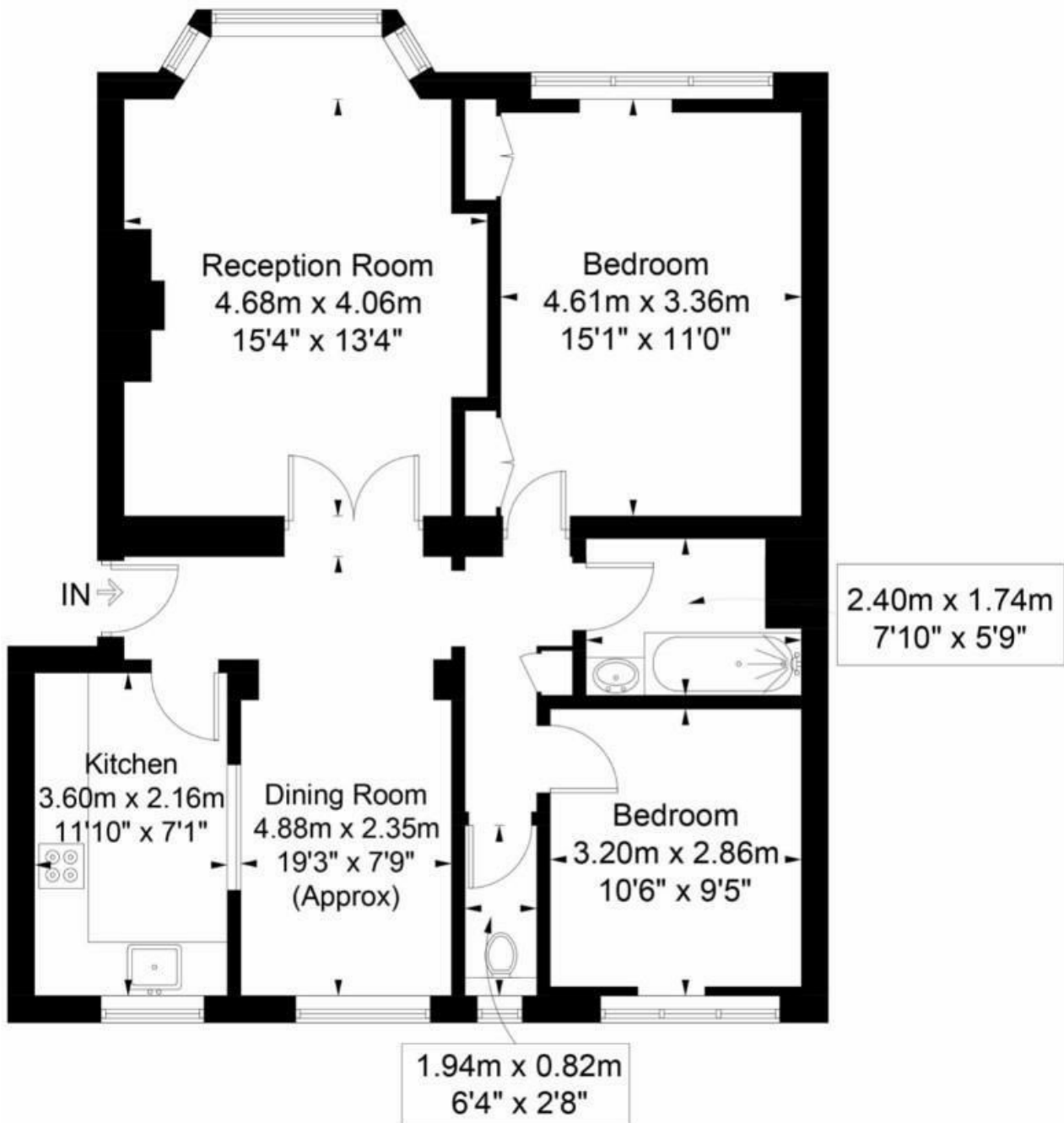

First Floor

Illustration for identification purposes only, measurements are approximate, not to scale. FloorplansUsketch.com © 2019 (ID533841)
ELLIE CLAIRE PHOTOGRAPHY LTD

The particulars do not constitute part of an offer or contract. The particulars, including text, photographs and plans, are for the guidance only of prospective purchasers/tenants and must not be relied upon as statements of fact. The descriptions provided therein represent the opinion of the author and whilst given in good faith should not be construed as statements of fact. Nothing in these particulars shall be deemed a statement that the property is in good condition or otherwise or that any services or facilities are in good working order. All measurements are approximate