

Parkheath

Sold on Service

Goldhurst Terrace NW6

£2,400 PCM (£554 per week) - Camden Band D



Attractive 2 bedroom apartment
High ceilings and wooden floors
Open plan kitchen with breakfast bar
Renovated period conversion
EPC energy rating C

Raised ground floor
Large reception/dining room
Contemporary bathroom
3 minute walk to Finchley Road tube station
Council tax: Camden band D

West Hampstead Office 020 7794 7111

Goldhurst Terrace



Approximate Gross Internal Area = 52.4 sq m / 564 sq ft

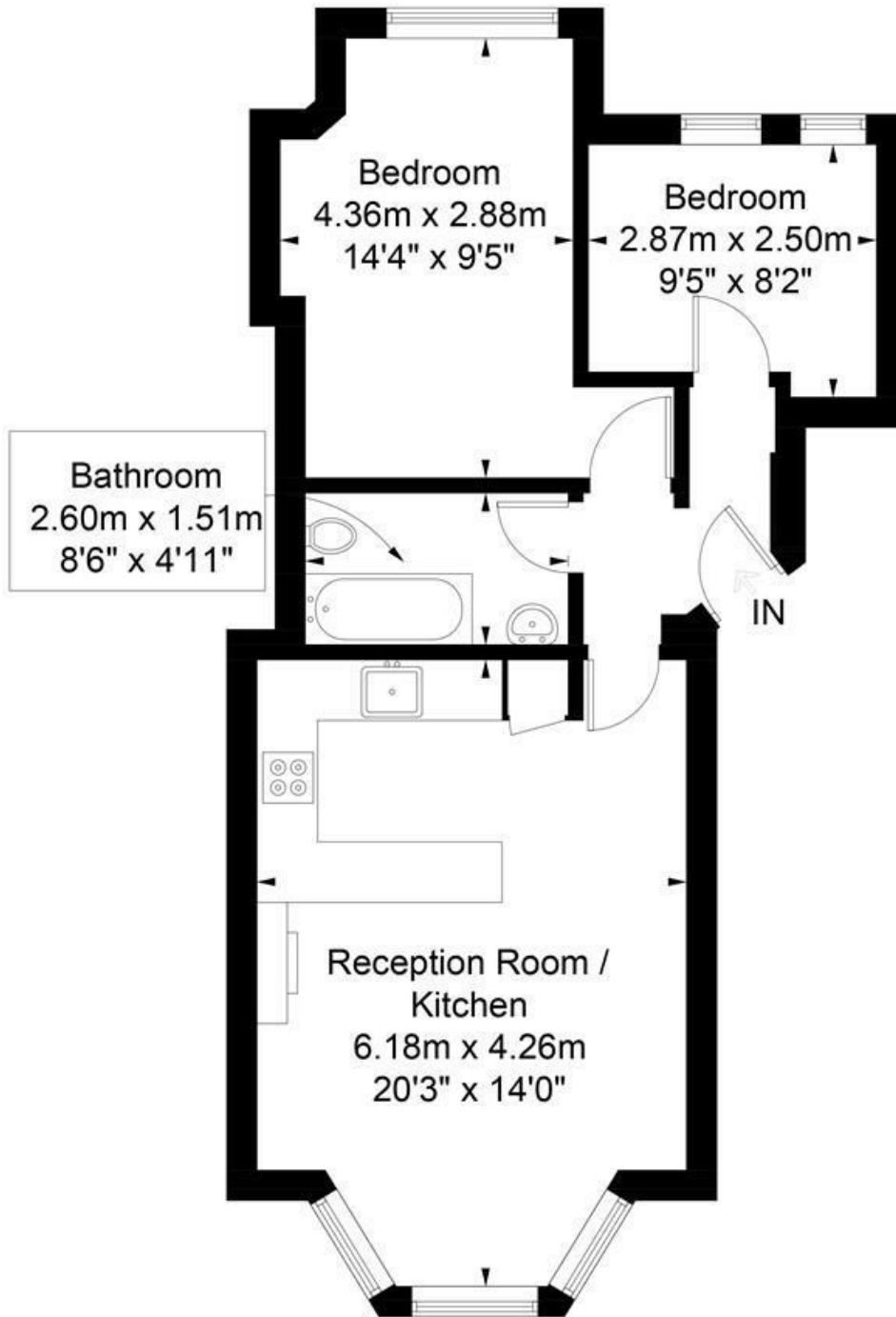

Raised Ground Floor

Illustration for identification purposes only, measurements are approximate, not to scale. FloorplansUsketch.com © 2018 (ID408038)
ELLIE CLAIRE PHOTOGRAPHY LTD

The particulars do not constitute part of an offer or contract. The particulars, including text, photographs and plans, are for the guidance only of prospective purchasers/tenants and must not be relied upon as statements of fact. The descriptions provided therein represent the opinion of the author and whilst given in good faith should not be construed as statements of fact. Nothing in these particulars shall be deemed a statement that the property is in good condition or otherwise or that any services or facilities are in good working order. All measurements are approximate