

# Parkheath

*Sold on Service*

**Priory Road NW6**

**£2,700 PCM (£623 per week) - Camden Band F**



Impressive 2 double bedroom apartment

932 Sq Ft / 86.58 Sq M

High ceilings

Generous reception/dining room

0.6 miles to South Hampstead overground station

Set within an attractive stucco fronted period conversion

Wooden floors throughout

2 bathrooms (1 en suite)

Fitted kitchen with door to south facing balcony

EPC: Rating TBC, Council Tax: Camden band F

West Hampstead Office 020 7794 7111

Priory Road, NW6  
Approx. Gross Internal Area  
932 Sq Ft - 86.58 Sq M

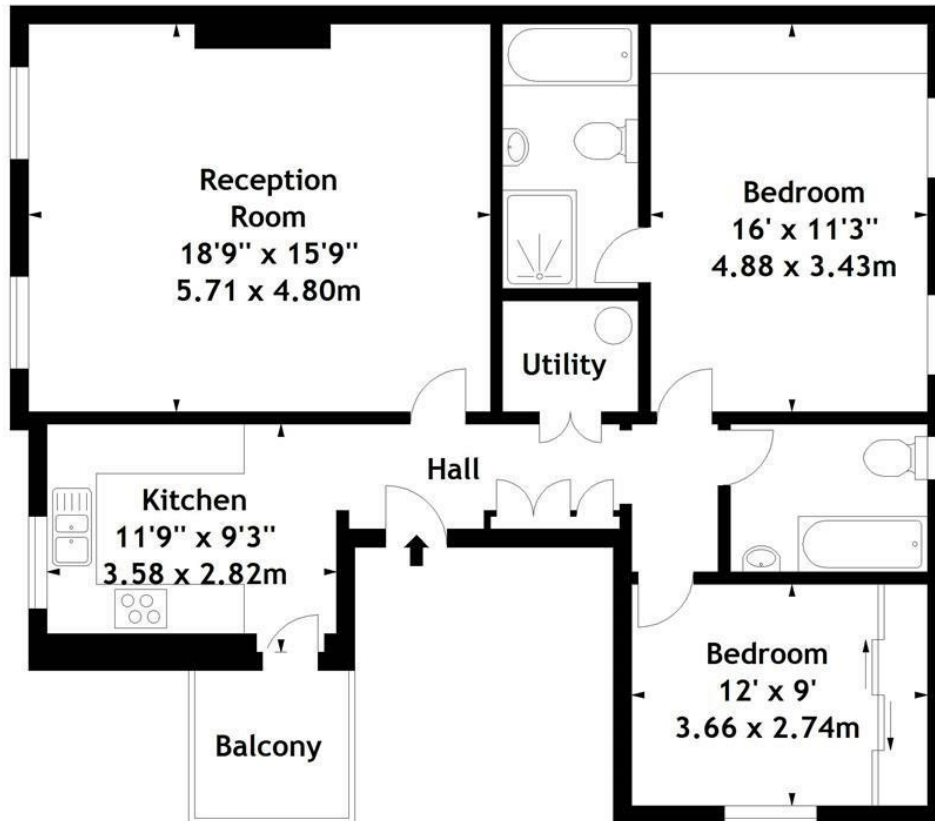

First Floor

Measured in accordance with RICS guidelines. Every attempt is made to ensure accuracy, however all measurements are approximate. This floor plan is for illustrative purposes only and is not to scale.  
© Datography Ltd 2014  
Photographs \* Floorplans \* Virtual Tours  
Tel: 0845 643 4401 [www.datography.com](http://www.datography.com)

The particulars do not constitute part of an offer or contract. The particulars, including text, photographs and plans, are for the guidance only of prospective purchasers/tenants and must not be relied upon as statements of fact. The descriptions provided therein represent the opinion of the author and whilst given in good faith should not be construed as statements of fact. Nothing in these particulars shall be deemed a statement that the property is in good condition or otherwise or that any services or facilities are in good working order. All measurements are approximate