

Parkheath

Sold on Service

Fairfax Road NW6

£3,200 PCM (£738 per week) - Camden Band E



Spacious & well-proportioned 3 double bedroom apartment

3rd floor above commercial premises

Separate fitted kitchen with breakfast bar

Suitable for professional sharers

Moments to Swiss Cottage and Finchley Road amenities & transport

Reception/dining room with wooden floors

Bathroom/WC

EPC: Rating D, Council Tax: Camden band E

West Hampstead Office 020 7794 7111

Fairfax Court, NW6
Approx. Gross Internal Area
907 Sq Ft - 84.26 Sq M

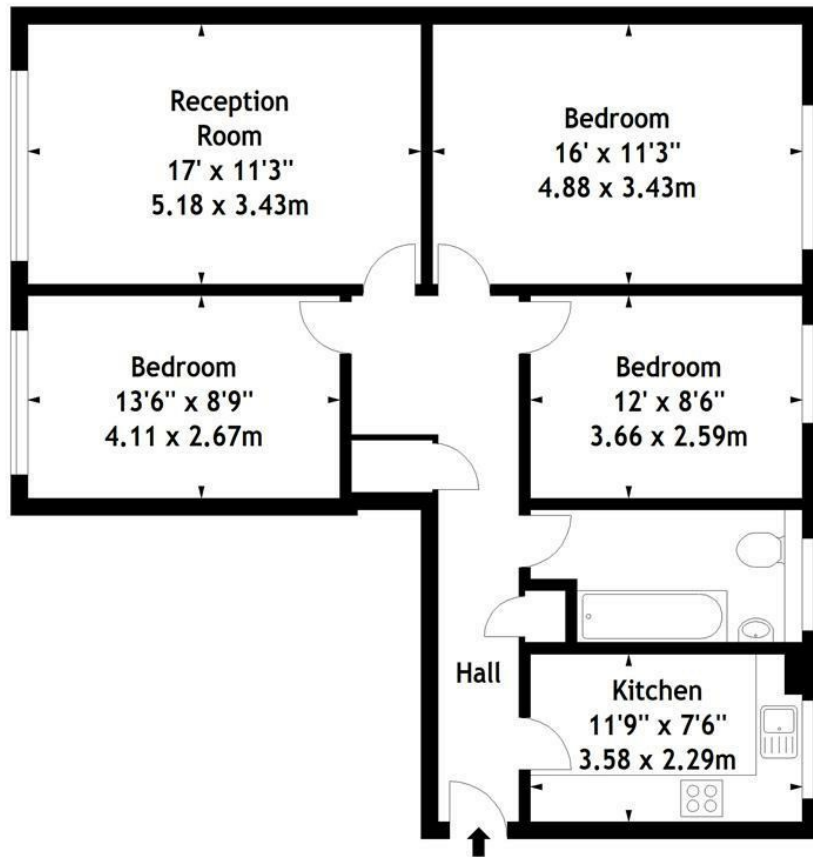

Third Floor

Measured in accordance with RICS guidelines. Every attempt is made to ensure accuracy, however all measurements are approximate. This floor plan is for illustrative purposes only and is not to scale.
© Datography Ltd 2015
Photographs * Floorplans * Virtual Tours
Tel: 0845 643 4401 www.datography.com

The particulars do not constitute part of an offer or contract. The particulars, including text, photographs and plans, are for the guidance only of prospective purchasers/tenants and must not be relied upon as statements of fact. The descriptions provided therein represent the opinion of the author and whilst given in good faith should not be construed as statements of fact. Nothing in these particulars shall be deemed a statement that the property is in good condition or otherwise or that any services or facilities are in good working order. All measurements are approximate