



Windmill Field, Windlesham

£385,000



Windmill Field, Windlesham

Modern two bedroom terraced home in Windlesham offered for sale with no onward chain, parking and a garage.

FEATURES

- Walking distance to village shops
- Storm porch
- Well maintained house
- Bright, modern décor
- Built in wardrobes to both bedrooms
- Ideal buy to let
- Gas central heating

ACCOMMODATION

- Entrance hall
- Modern fitted kitchen
- Living/dining room
- Two bedrooms
- Upstairs modern bathroom



OUTSIDE

- Residents parking
- Enclosed rear garden
- Leasehold garage with parking space in front

EPC RATING

C

LOCAL AUTHORITY/COUNCIL TAX

Surrey Heath – Band D





Approximate Gross Internal Area
49.91 sq m / 537.22 sq ft
(Excludes Garage)
Garage Area 12.46 sq m / 134.11 sq ft

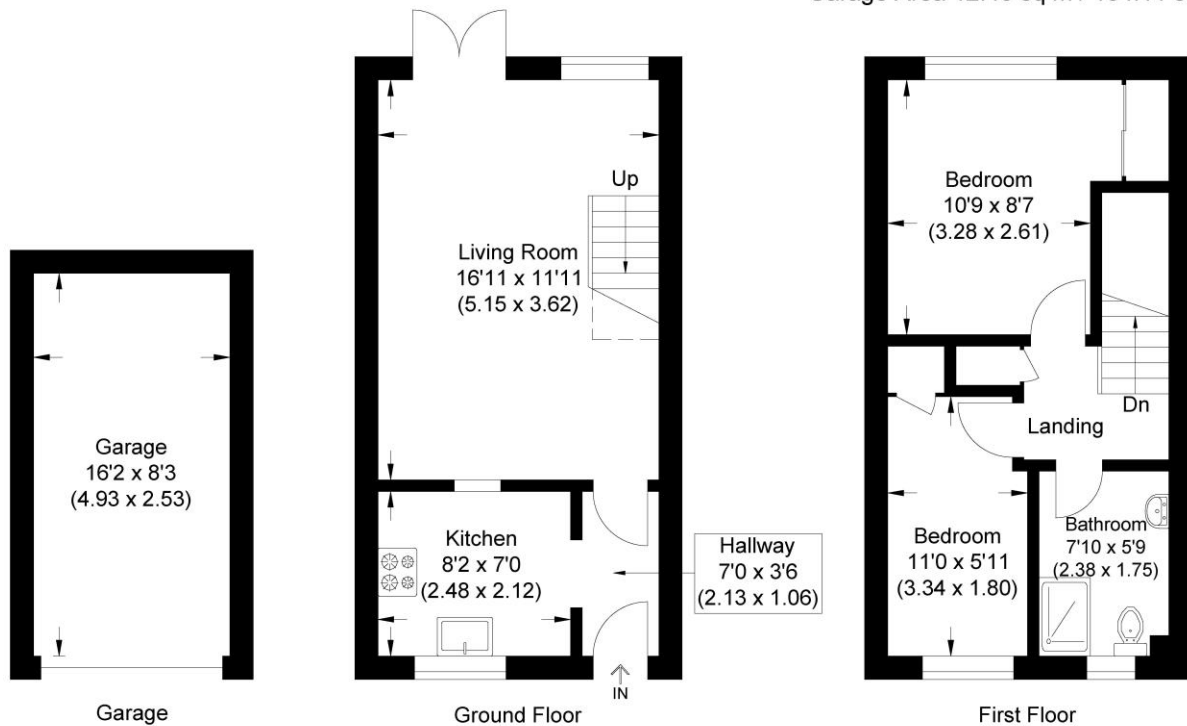

Illustration for identification purposes only, measurements are approximate, not to scale.

Disclaimer: We wish to inform prospective purchasers that we have prepared these sales particulars as a general guide. We have not carried out a detailed survey, nor tested the services, appliances and specific fittings. Room sizes are approximate and rounded: they are taken between internal wall surfaces and therefore include cupboards / shelves, etc. Accordingly, they should not be relied upon for carpeting, curtains / blinds and kitchen equipment, whether fitted or not, are deemed removable by the vendor unless specifically itemized within these.

Postcode for sat nav: **GU20 6QD**



NEWTON ROWE
SALES & LETTINGS

The Old Dairy, 7 Updown Hill, Windlesham, Surrey GU20 6AF
enquiries@newtonrowe.co.uk | 01276 986900