



Chertsey Road, Windlesham

£650,000



Chertsey Road, Windlesham GU20 6HU

Character three bedroom detached home with wood burning stove, exposed floorboards and a large garden with outbuilding/home office situated within walking distance of local shops and pubs.

FEATURES

- No onward chain
- Scope to extend subj. to planning permission
- Wood burning stove
- Gas central heating
- Exposed floorboards

ACCOMODATION

- Entrance Porch
- Sitting room
- Dining room
- Kitchen/breakfast room
- Utility room
- Cloakroom
- Three bedrooms
- Two shower rooms

OUTSIDE

- Driveway parking
- Side access
- Garden
- Outbuilding/home office

COUNCIL TAX

Surrey Heath – Band F

EPC RATING

E





Approximate Area = 108.5 sq m / 1168 sq ft
Including Limited Use Area (1.8 sq m / 19 sq ft)



First Floor

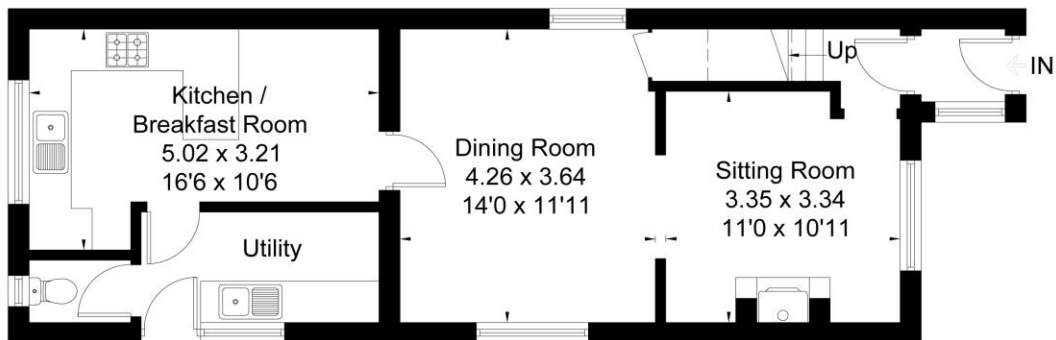

Ground Floor

Surveyed and drawn in accordance with the International Property Measurement Standards (IPMS 2: Residential)
fourwalls-group.com 244640

Disclaimer: We wish to inform prospective purchasers that we have prepared these sales particulars as a general guide. We have not carried out a detailed survey, nor tested the services, appliances and specific fittings. Room sizes are approximate and rounded; they are taken between internal wall surfaces and therefore include cupboards / shelves, etc. Accordingly, they should not be relied upon for carpeting, curtains / blinds and kitchen equipment, whether fitted or not, are deemed removable by the vendor unless



NEWTON ROWE
SALES & LETTINGS

The Old Dairy, 7 Updown Hill, Windlesham, Surrey GU20 6AF
enquiries@newtonrowe.co.uk | 01276 986900