



Updown Hill, Windlesham

£1,000 pcm



Updown Hill, Windlesham, Surrey, GU20 6DL

First floor 1 bedroom apartment with off road parking, located in the heart of Windlesham village just a short walk from local shops, pubs and the Field of Remembrance playing fields and cafe.

FEATURES

Walking distance of Windlesham village shops and popular nearby pubs

ACCOMODATION

Communal entrance
1 bedroom
Sitting room
Kitchen
Bathroom

OUTSIDE

Off road parking to the rear

UNFURNISHED

Unfurnished

DEPOSIT PAYABLE

£1,150

AVAILABLE

8th August 2025

LOCAL AUTHORITY

Surrey Heath - Band C

EPC RATING - D





Approximate Gross Internal Area = 38.3 sq m / 413 sq ft

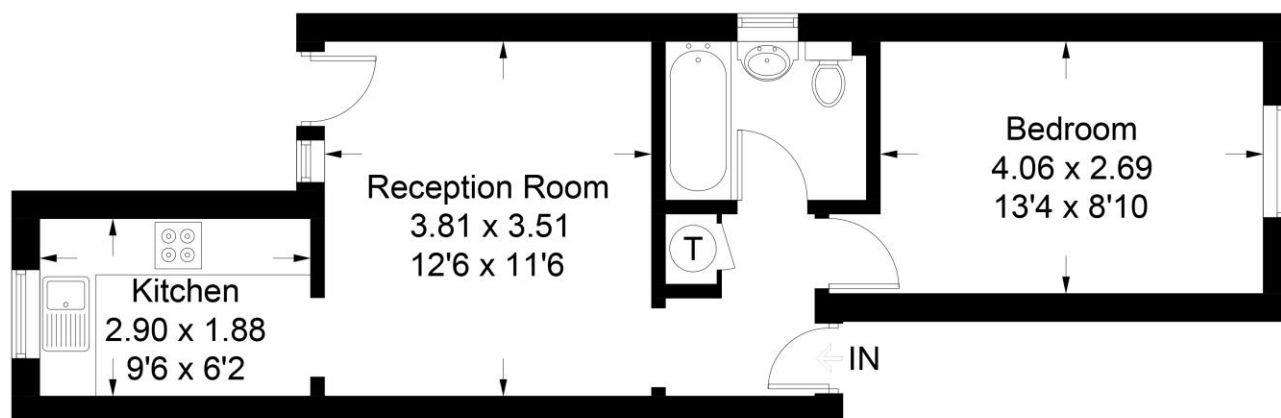

First Floor

Illustration for identification purposes only, measurements are approximate, not to scale. floorplansUsketch.com © (ID472906)

Disclaimer: We wish to inform prospective tenants/purchasers that we have prepared these sales particulars as a general guide. We have not carried out a detailed survey, nor tested the services, appliances and specific fittings. Room sizes are approximate and rounded: they are taken between internal wall surfaces and therefore include cupboards / shelves, etc. Accordingly, they should not be relied upon for carpeting, curtains / blinds and kitchen equipment, whether fitted or not, are deemed removable by the vendor unless specifically itemized within these.

Postcode for sat nav: GU20 6DL



The Old Dairy, 7 Updown Hill, Windlesham, Surrey GU20 6AF
enquiries@newtonrowe.co.uk | 01276 986900