



Larch Road, NW2

£425,000

This brand new first floor conversion measures close to 600Sq.Ft. The spacious open plan living area has a well-fitted kitchen with integrated appliances, there is a shower room and two bedrooms. The property comes with no onward chain and a share of the freehold.

Larch Road is a residential street located a short distance from multiple transport links, including Cricklewood Station (Thameslink) and a number of bus routes. A variety of shops, eateries, and facilities can be found at Brent Cross Shopping Centre, which is just 1.9 miles away.

Features

- No Onward Chain
- First Floor
- Two Bedrooms
- Open Plan Living Area
- Newly Finished
- Share OF Freehold

Larch Road, London, NW2

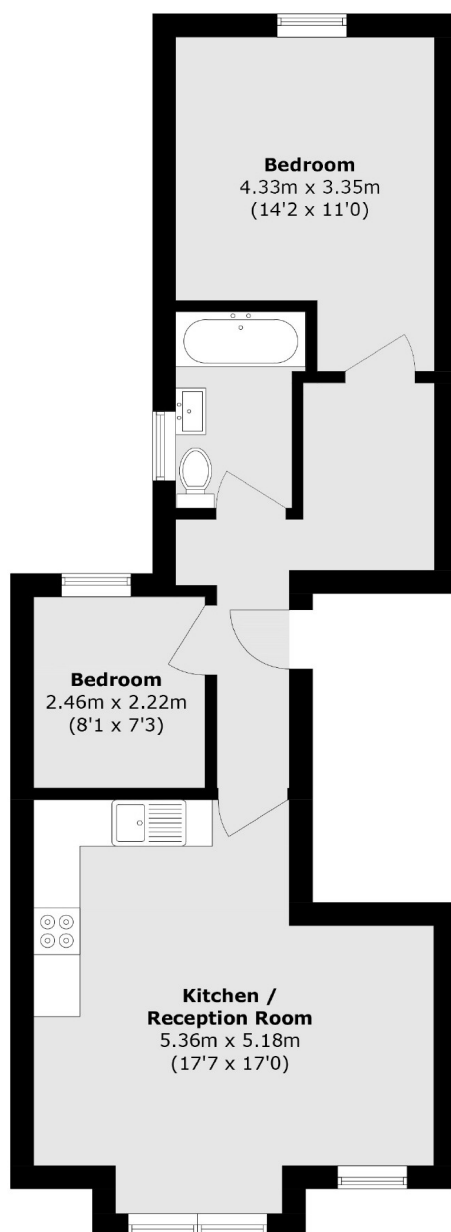

Total area (approx.): 55.1 sq. m (593.0 sq. ft)