



Shaftesbury Avenue, HA3

£357 Per week

This newly built one bedroom, first floor flat is ideally situated in Kenton with excellent transport links. The property has an open plan living area with an integrated kitchen, a double bedroom with generous storage, a contemporary tiled shower room and neutral decor throughout.

Shaftesbury Avenue is well-situated and close by to the amenities on Preston Road. Wembley is also nearby, and the green open spaces of Woodcock Park are within easy reach.

Features

- Gated New Build
- Open Plan
- One Bedroom
- Fitted Wardrobes
- Residential Street
- Excellent Local Amenities

Shaftesbury Avenue, Harrow, HA3

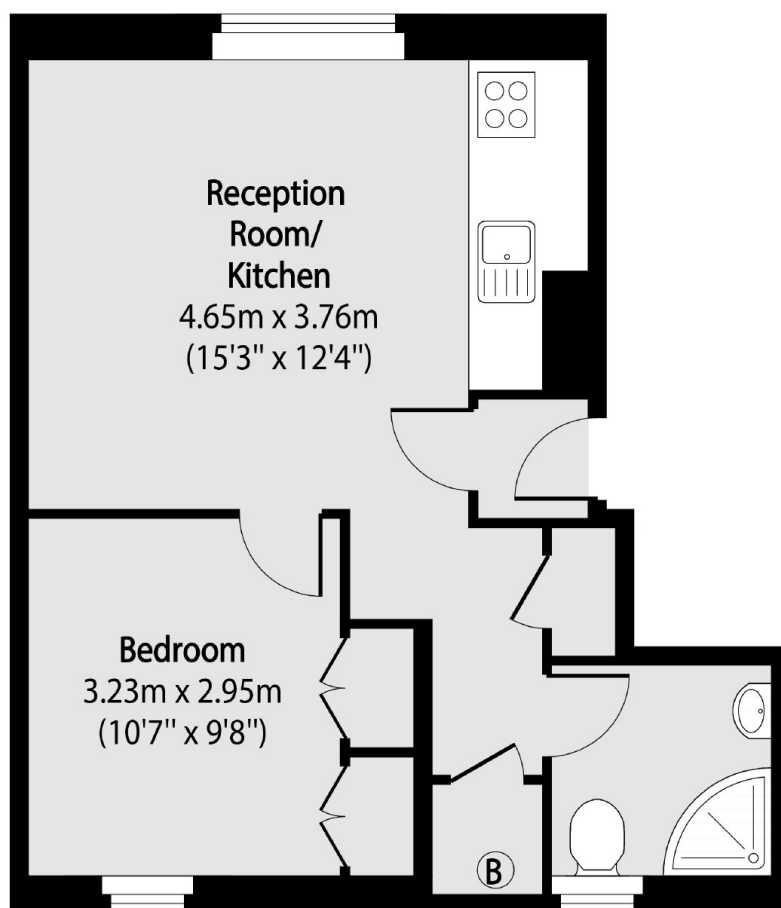

Total area (approx): 34.47 sq m (371 sq. ft)