



Manstone Road, NW2

£461 Per week

This spacious one bedroom garden flat is ideally situated on the borders of Cricklewood and West Hampstead. The property has a semi open plan living area with an integrated kitchen, high ceilings, and doors leading to a large private rear garden.

Manstone Road is located off Shoot-up Hill, which has a variety of shops and restaurants. The closest stations are Kilburn and Cricklewood Thameslink, and you have many bus services also nearby.

Features

- One Bedroom
- Semi Open-plan
- Integrated Kitchen
- Built-in Storage
- Private Garden
- Ideally Situated

Manstone Road, London, NW2

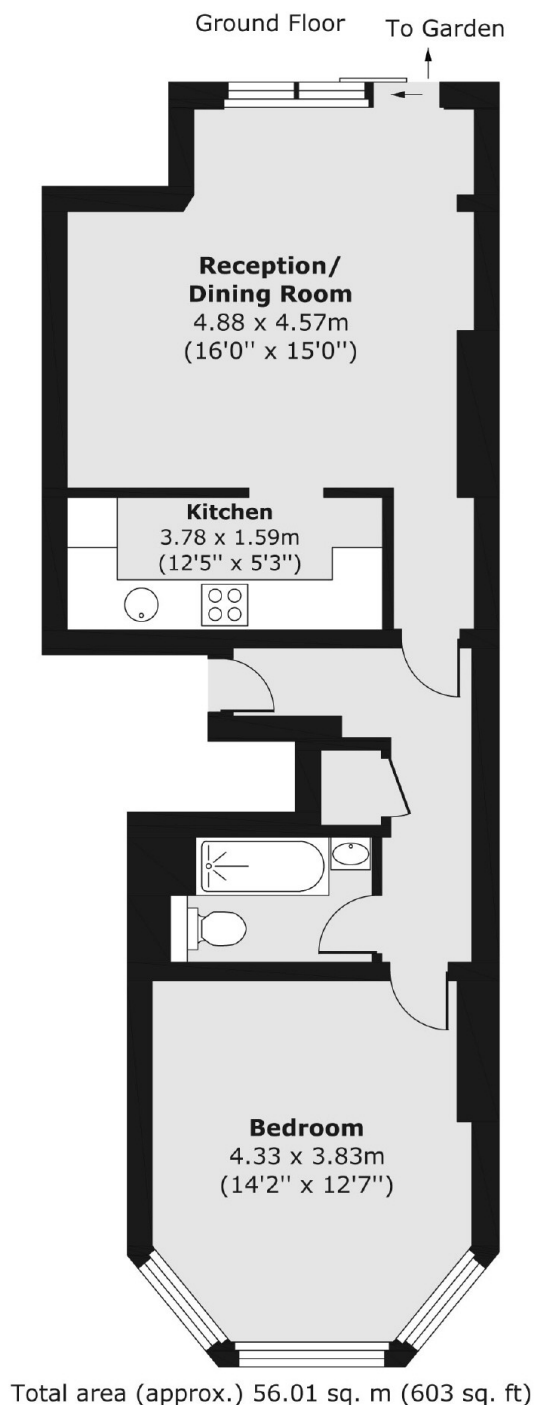

Dexters

Cricklewood
28-30 Cricklewood Broadway
London
NW2 3HD
Lettings
020 7794 1730

Energy Rating: D. We aim to make our particulars both accurate and reliable. However they are not guaranteed; nor do they form part of an offer or contract. If you require clarification on any points then please contact us, especially if you're traveling some distance to view. Please note that appliances and heating systems have not been tested and therefore no warranties can be given as to their good working order.

 **RICS** | Regulated
Estate Agent
and Letting Agent

[dexters.co.uk](https://www.dexters.co.uk)