



Draycott Close, NW2

£335,000

A lovely one bedroom first floor apartment located in a purpose built block, measuring in excess of 570 sq ft. Complete with a large reception room, a separate kitchen, residents' parking, and communal gardens.

The property is located close to Cricklewood Station (Thameslink), Cricklewood Broadway, with a range of local amenities, restaurants, and cafés, Brent Cross, and excellent transport and motorway links.

Features

One Bedroom Apartment
Purpose Built
First Floor
Residents Parking
Communal Gardens
Long Lease

Draycott Close, London, NW2

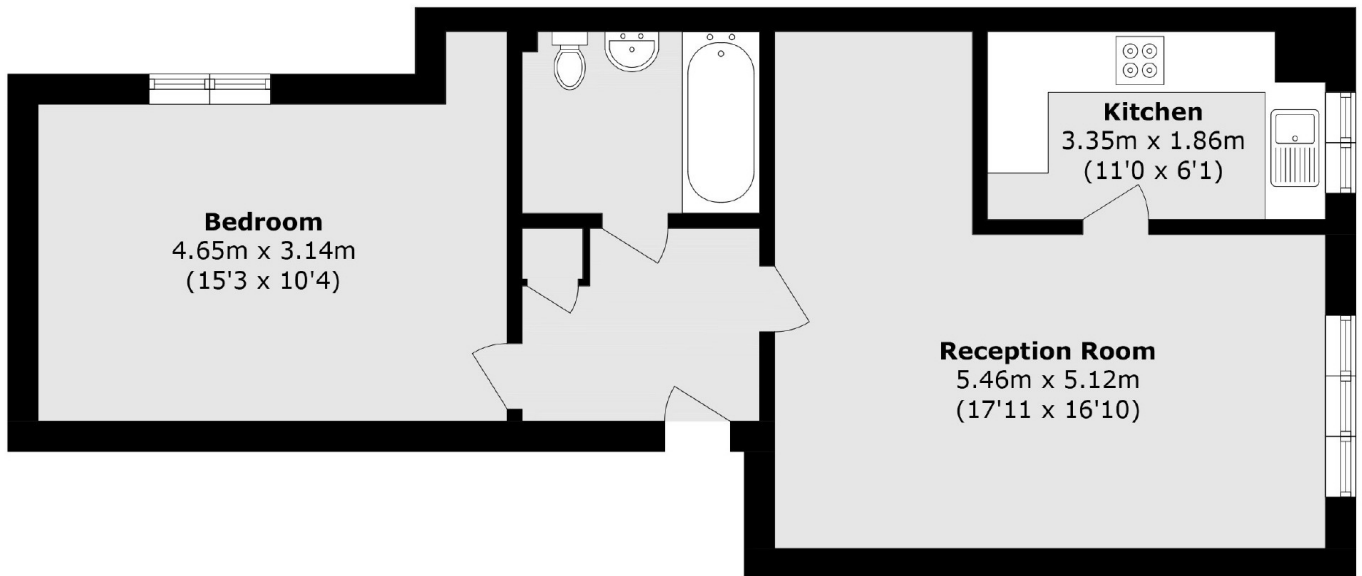

Total area (approx.): 53.2 sq. m (572.6 sq. ft)