

## Exeter Road, NW2

### £425,000

A spacious one bedroom, top floor period conversion measuring in excess of 550 sq.ft offering ample natural light and finished to a high standard throughout. The property comes with an open-plan living area and modern bathroom.

Exeter Road is ideally situated close to Willesden Green with its many local amenities, delis, shops, and cafés. Kilburn station and Willesden Green are nearby, offering good transport links to the city.

### Features

- Period Conversion
- One Bedroom
- Open Plan Living Area
- Modern Bathroom
- Top Floor
- In Excess Of 550 Sq.Ft

Exeter Road,  
London, NW2

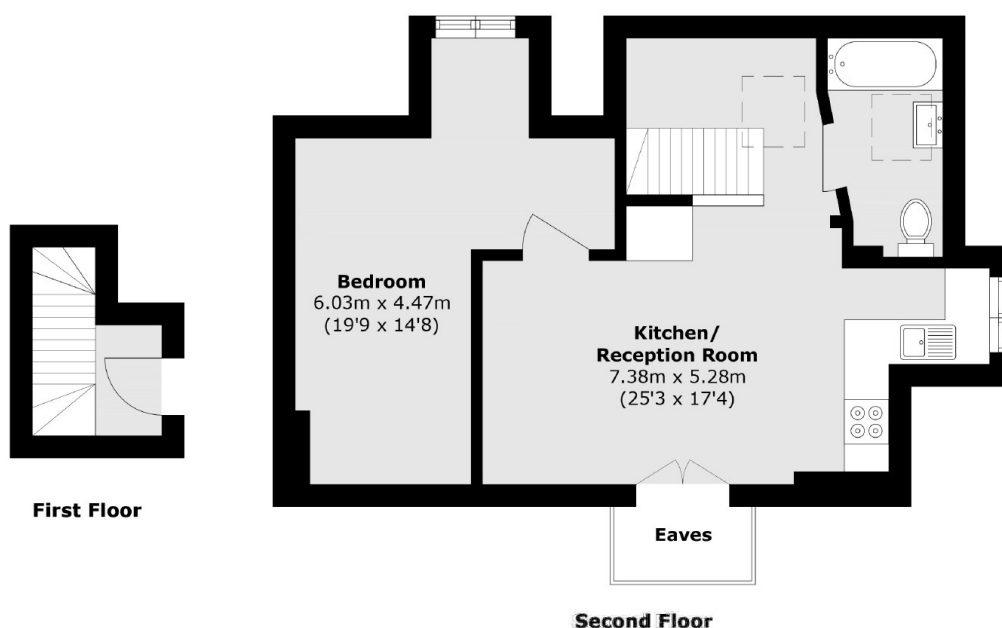

Total area (approx.): 51.7 sq. m (556.5 sq. ft)  
(Excluding Eaves)

**Dexters**

Cricklewood  
28-30 Cricklewood Broadway  
London  
NW2 3HD  
Sales  
020 7794 7710

Energy Rating: C. We aim to make our particulars both accurate and reliable. However they are not guaranteed; nor do they form part of an offer or contract. If you require clarification on any points then please contact us, especially if you're traveling some distance to view. Please note that appliances and heating systems have not been tested and therefore no warranties can be given as to their good working order.

 **RICS** | Regulated  
Estate Agent  
and Letting Agent

[dexters.co.uk](https://www.dexters.co.uk)