



## Churchill Road, NW2

£415 Per week

This quirky one bedroom first floor flat is well located in Willesden Green. The property has a spacious open plan living area with good storage, high ceilings and a contemporary island kitchen. The property also has a mezzanine level, perfect for a study and the bedroom has built in wardrobes.

Churchill Road is ideally situated close to local amenities and transport links. Willesden Green station and high street is moments away with many restaurants and coffee shops nearby, you also have Dollis Hill station close by.

### Features

- Double Bedroom
- Open Plan
- Island Kitchen
- Mezzanine Level
- Good Storage
- Dollis Hill Station

# Churchill Road, London, NW2

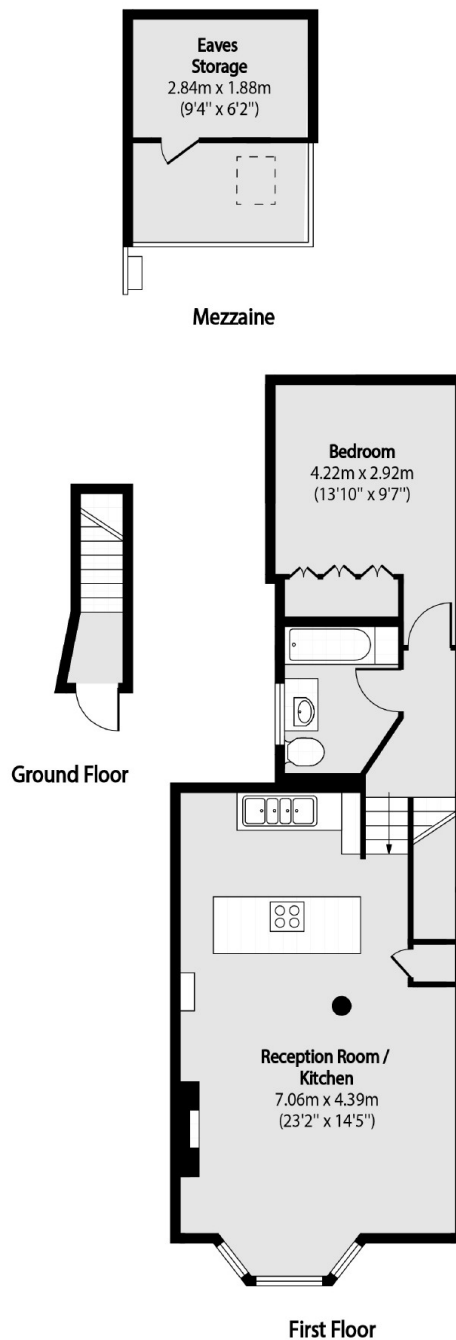

Total area (approx): 53.23 sq m (573 sq. ft)  
(Excluding Mezzanine)

Mezzanine total area (approx): 10.12 sq m (109 sq. ft)

## Dexters

Cricklewood  
28-30 Cricklewood Broadway  
London  
NW2 3HD  
Lettings  
020 7794 1730

Energy Rating: C. We aim to make our particulars both accurate and reliable. However they are not guaranteed; nor do they form part of an offer or contract. If you require clarification on any points then please contact us, especially if you're traveling some distance to view. Please note that appliances and heating systems have not been tested and therefore no warranties can be given as to their good working order.

 **RICS** | Regulated  
Estate Agent  
and Letting Agent

[dexters.co.uk](https://www.dexters.co.uk)