



## Mapesbury Road, NW2

### £300,000

A one bedroom sixth floor apartment with an eat-in kitchen, a separate reception room with access to a private balcony, ample storage throughout, lift access, and off-street parking. The property comes with no onwards chain.

Mapesbury Road is close to the trendy shops and bars of Kilburn High Road, the cafes and restaurants of Salusbury Road, and is within easy reach of Kilburn station (Jubilee line) and Brondesbury station (Overground), offering excellent access to the City.

### Features

- Sixth Floor
- Eat-In Kitchen
- Ample Storage
- Lift Access
- Off Street Parking
- No Onward Chain

# Mapesbury Road, London, NW2

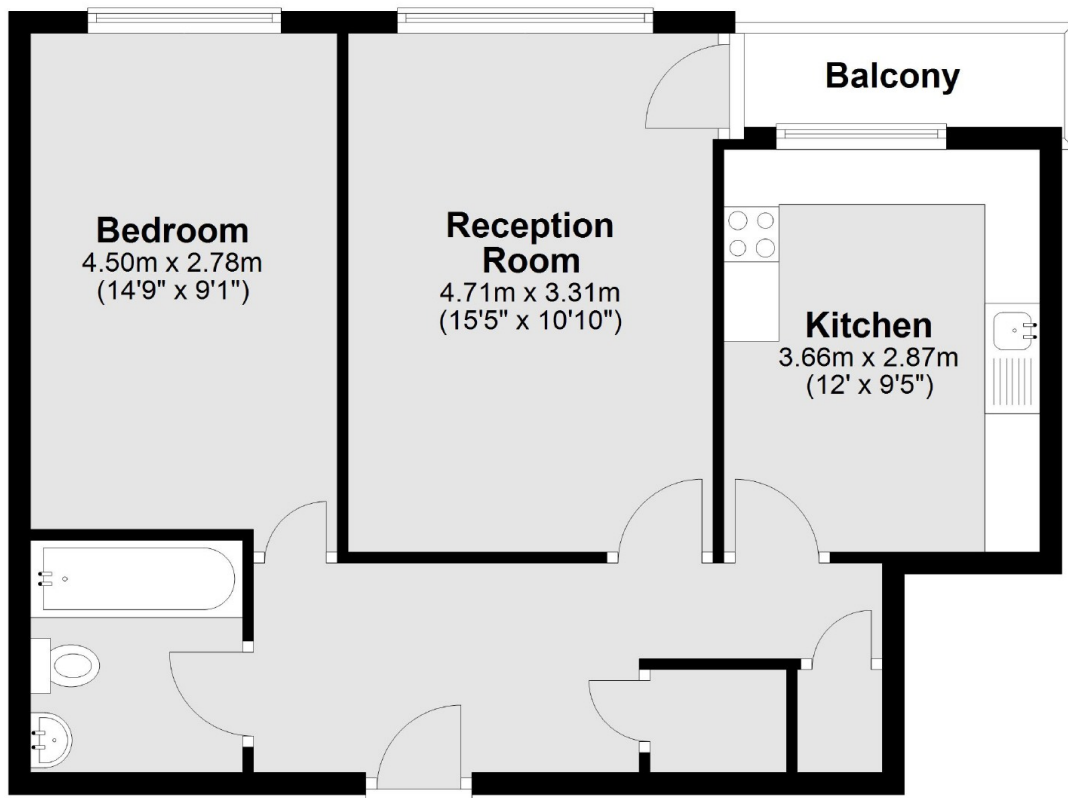

Main area: Approx. 55.7 sq. metres (599.3 sq. feet)  
Plus balconies, approx. 2.9 sq. metres (31.6 sq. feet)