



## Park Avenue North, NW10

### £425,000

A one double bedroom top floor apartment with an open-plan living area and modern bathroom. The property comes with a long lease and no onwards chain.

Park Avenue North is well located and moments away from Gladstone Park and the excellent selection of amenities in nearby Willesden. You also have good transport links with Willesden Green and Dollis Hill stations nearby for easy access into central London.

### Features

- Top Floor
- One Double bedroom
- Open Plan Living Area
- Modern Bathroom
- Long Lease
- No Onward Chain

# Park Avenue North, London, NW10

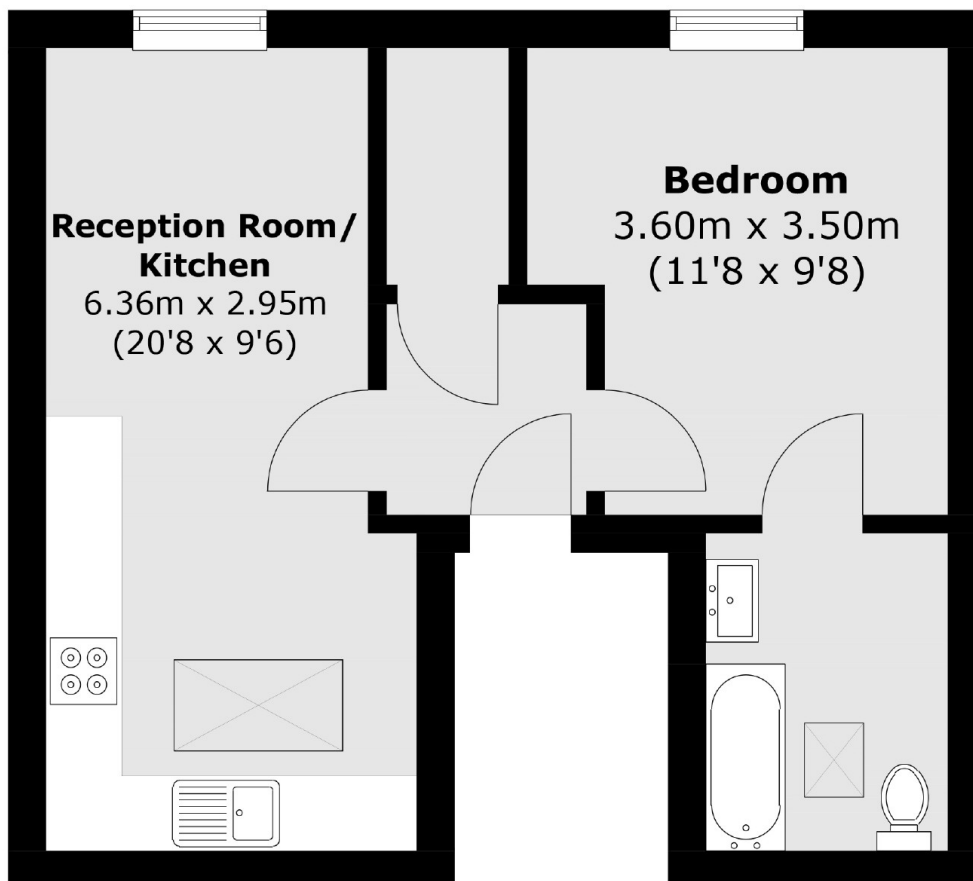

Total area (approx.): 39.8 sq. m (428.4 sq. ft)