



## Claremont Road, NW2

£369 Per week

This spacious ground floor one bedroom flat is ideally situated in the heart of Cricklewood. The flat has a open plan living area with a modern kitchen, a bright double bedroom, and well maintained communal grounds.

Claremont Road is well located close to Cricklewood Station (Thameslink), Cricklewood Broadway with a range of local amenities, restaurants, cafés, Brent Cross, and excellent transport and motorway links.

### Features

- One Bedroom
- Open Plan
- Tiled Bathroom
- Wood Floors
- Communal Grounds
- Cricklewood Station

# Claremont Road, London, NW2

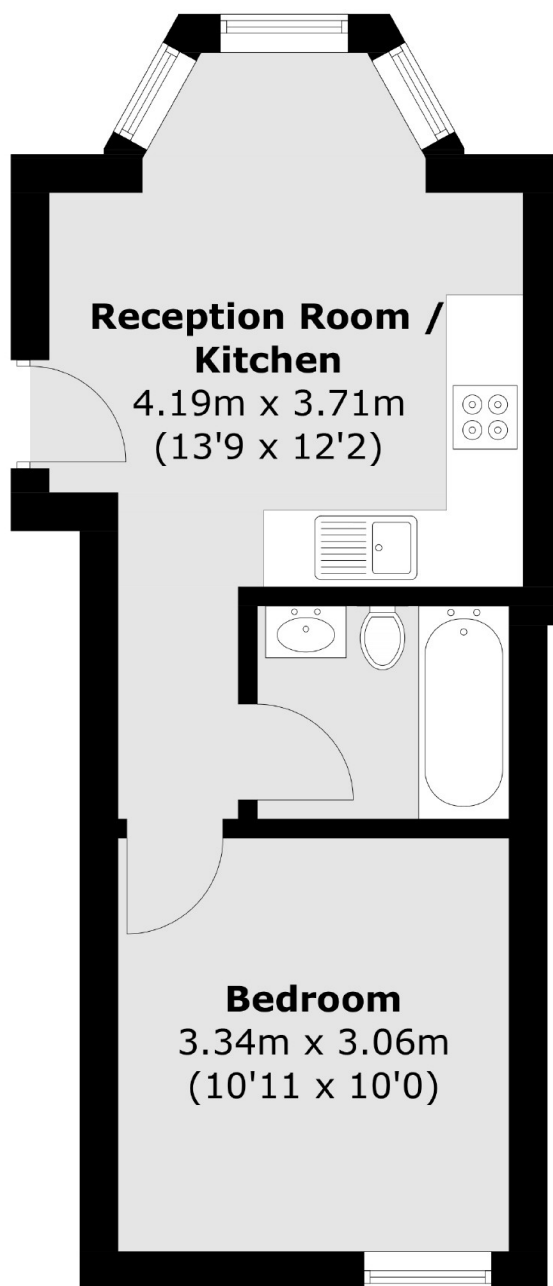

Total area (approx.): 29.2 sq. m (314.3 sq. ft)