



Johnston Terrace, NW2

£575,000

A beautiful freehold cottage offering three bedrooms, separate well-fitted kitchen, reception room, utility room, modern bathroom, a secluded courtyard garden and access to the communal green.

Johnston Terrace is located at the heart of the quiet railway cottages 'The Terraces' and is part of a welcoming community. Numerous bus routes and Cricklewood station (Thameslink) are within easy reach for access to Central London.

Features

- Three Bedrooms
- Railway Cottage
- Quiet Residential Area
- Freehold House
- Separate Reception
- Kitchen And Utility Room

Johnston Terrace, London, NW2

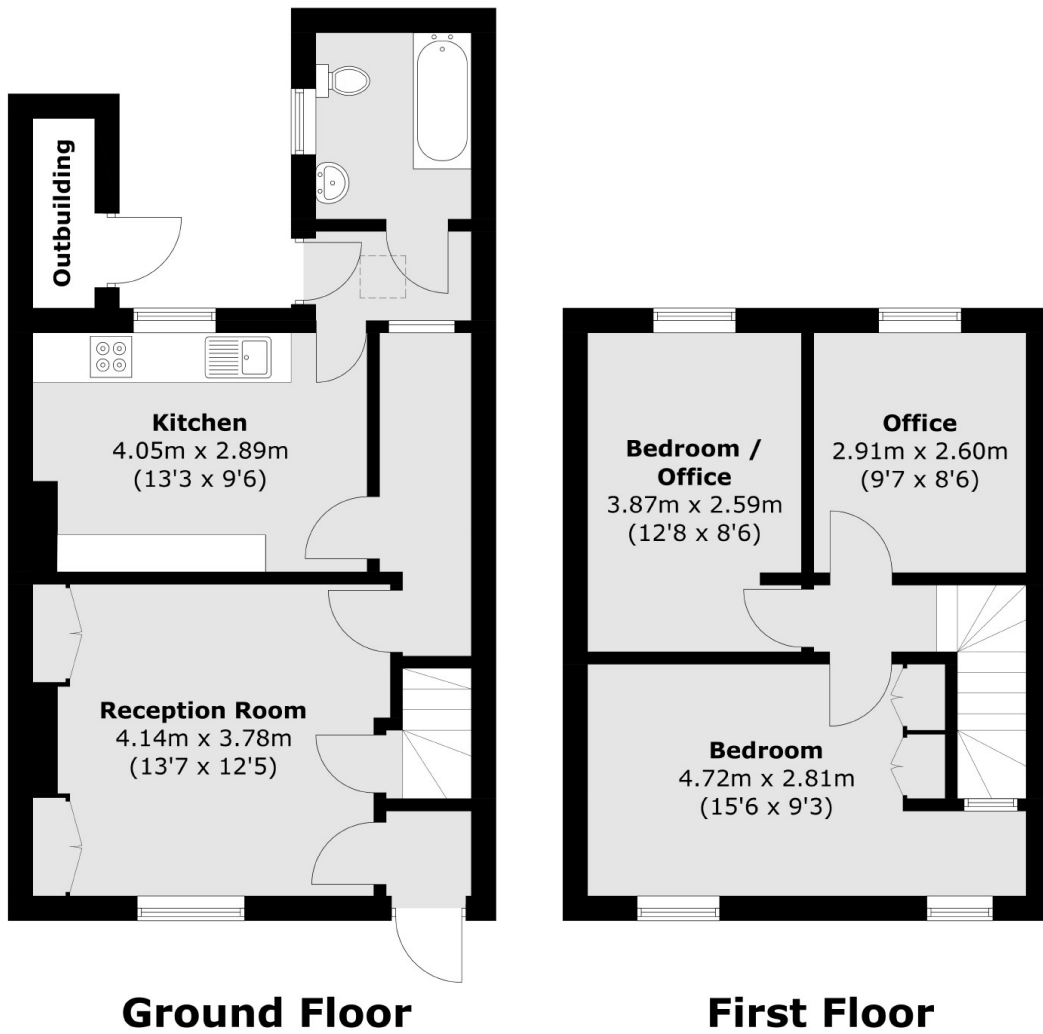

Total area (approx.): 79.7 sq. m (857.8 sq. ft)
(Excluding Outbuilding)